

LIF 1,5T638 R

Weidmüller Interface GmbH & Co. KG

Klingenbergstraße 26

D-32758 Detmold

Germany

www.weidmueller.com

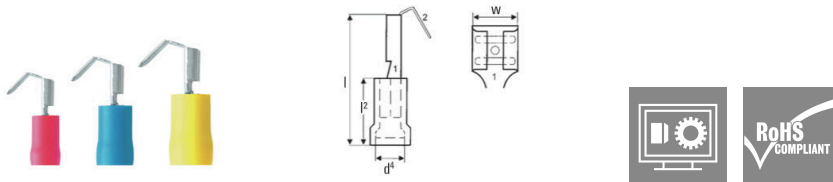

Insulated tab-connector sleeves with branch, made from PVC with copper sleeve

- Commercially available designs
- Not soldered
- With conical entry funnel

General ordering data

Version	cable lug, terminal end, Insulated cable connector, 0.5 mm ² - 1.5 mm ² , red
Order No.	9200610000
Type	LIF 1,5T638 R
GTIN (EAN)	4032248410453
Qty.	100 items

Technical data

Approvals

ROHS	Conform
------	---------

Dimensions and weights

Depth	7.6 mm	Depth (inches)	0.2992 inch
Width	20.8 mm	Width (inches)	0.8189 inch
Net weight	1.35 g		

Environmental Product Compliance

RoHS Compliance Status	Compliant without exemption
REACH SVHC	No SVHC above 0.1 wt%

Technical data

Description of article	Flat-blade receptacle with branch, 0.5 - 1.5 mm ²
------------------------	--------------------------------------------------------------

Connectors

Conductor cross-section, max.	1.5 mm ²	Conductor cross-section, min.	0.5 mm ²
Insulation	Available, Partially insulated	Dimension (flat blade connector)	6.3 x 0.8 mm
Dimension	6.3 x 0.8 mm	Material/plastic	PVC
Identification colour	red	Plug-in width (d2)	6.3 mm
Plug-in density (d3)	0.8 mm	Plastic collar length (b)	10 mm
Plastic collar diameter (D)	4 mm		

Classifications

ETIM 8.0	EC0005 16	ETIM 9.0	EC0005 16
ETIM 10.0	EC0005 16	ECLASS 14.0	27-44-03-92
ECLASS 15.0	27-44-03-92		