

IE plug-in connectors, IP20, for copper and fibre optic cables

General ordering data

Version	Flange insert, Cat.6A / Class EA (ISO/IEC 11801 2010), IP20
Order No.	8808330000
Type	IE-XRJ45/IDC
GTIN (EAN)	4032248505913
Qty.	1 items

Technical data

Approvals

Approvals



ROHS Conform

Dimensions and weights

Height	23.4 mm	Height (inches)	0.9213 inch
Width	14.7 mm	Width (inches)	0.5787 inch
Length	43.8 mm	Length (inches)	1.7244 inch
Wall thickness, min.	1.45 mm	Wall thickness, max.	1.55 mm
Net weight	24.64 g		

Temperatures

Operating temperature -40 °C...70 °C

Environmental Product Compliance

RoHS Compliance Status Compliant without exemption
 REACH SVHC No SVHC above 0.1 wt%

General data

Connection 1	RJ45	Connection 2	IDC
Wiring	TIA-568A, TIA-568B, PROFINET	Housing main material	Zinc diecast
Insulation cross-section, max.	1.8 mm	Category	Cat.6A / Class EA (ISO/IEC 11801 2010)
Contact surface	Gold over nickel	Connection diameter, solid	0.41...0.64 mm
Conductor connection cross-section, solid (AWG)	AWG 26...AWG 22	Conductor connection cross-section, solid	0.13...0.32 mm ²
Connection diameter, flexible	0.48...0.76 mm	Conductor connection cross-section, flexible (AWG)	AWG 26...AWG 22
Wire connection cross section, finely stranded, min.	0.14 mm ²	Conductor connection cross-section, flexible	0.14...0.35 mm ²
Shielding	360°; shield contact	Protection degree	IP20
Insertion force	20 N	Plugging cycles	750

Electrical properties

Contact resistance	≤ 20 mΩ	Dielectric strength, contact / contact	≥ 1000 V DC
Insulation resistance	500 MΩ	PoE / PoE+	conforming to IEEE 802.3at

General standards

Certificate No. (DNV) TAE00003EW Connector standard IEC 60603-7-51

Classifications

ETIM 8.0	EC001121	ETIM 9.0	EC001121
ETIM 10.0	EC001121	ECLASS 14.0	27-44-03-90
ECLASS 15.0	27-44-03-90		

Drawings

Dimensioned drawing

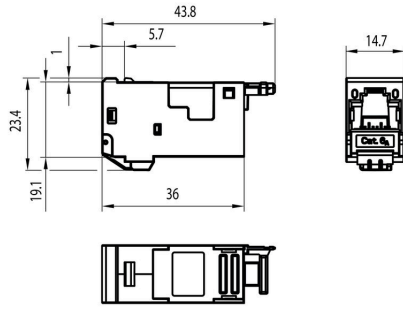

Installation cut-out

