

KLIPPON POK2 M20ACSS EX

Weidmüller Interface GmbH & Co. KG
 Klingenbergstraße 26
 D-32758 Detmold
 Germany

www.weidmueller.com



Various types of terminal boxes are available for installing signal / power supplies or distributors in explosive risk zones. The terminal boxes are explosion-protected equipment approved for use in Ex areas in zones 0, 1, 2 and 20, 21, 22. They are certified in accordance with the latest international standards Ex e, Ex ia and Ex tb. Customer-specific configuration means these terminal boxes are the optimum solution for all applications. Use the product overview to find the right solution for you! Combine the enclosure, with or without threaded holes, a suitable mounting rail or pre-fitted strip terminals. We have put together a small selection for you, but we are happy to configure a bespoke solution for you.

Features:

- Available in a wide range of versions to meet customer requirements
- Additional international approvals alongside IECEx and ATEX also available
- Increased quality thanks to the use of established basic products in the Klippon® brand

General ordering data

Version	Terminal Box, ATEX II 2GD T85°C Ex e II T6, KLIPPON POK 08 1 106 EX, KL SET 10A4 SDrill holes side A: 2 x M20x1.5, Drill holes side B: 2 x M20x1.5
Order No.	8000004225
Type	KLIPPON POK2 M20ACSS EX
GTIN (EAN)	4032248986095
Qty.	1 items

KLIPPON POK2 M20ACSS EX

Weidmüller Interface GmbH & Co. KG
 Klingenbergstraße 26
 D-32758 Detmold
 Germany

www.weidmueller.com

Technical data

Approvals

ROHS	Conform
------	---------

Dimensions and weights

Depth	75 mm	Depth (inches)	2.9527 inch
Height	56 mm	Height (inches)	2.2047 inch
Width	110 mm	Width (inches)	4.3307 inch
Net weight	550 g		

Environmental Product Compliance

RoHS Compliance Status	Compliant with exemption
RoHS Exemption (if applicable/known)	6c
REACH SVHC	Lead 7439-92-1
SCIP	c0b142f1-4049-4b95-bbc3-9959a2d3b09c

Certificate numbers enclosure

Certificate no. Terminal Box (ATEX)	IBExU13ATEX1004 X	Certificate no. Terminal Box (IECEx)	IECEx IBE 13.0004X
-------------------------------------	-------------------	--------------------------------------	--------------------

Material data

Surface finish	untreated, polished	Basic material	Glass fibre-reinforced polyester
----------------	---------------------	----------------	----------------------------------

General data

Protection degree	IP66
-------------------	------

Housing

Basic material	Glass fibre-reinforced polyester	Drill holes side A	2 x M20x1.5
Drill holes side B	2 x M20x1.5		

Standard features

Version	ATEX II 2GD T85°C Ex e II T6	Reference product	KLIPPON POK 081106 EX
---------	------------------------------	-------------------	---------------------------------------

Classifications

ETIM 8.0	EC002503	ETIM 9.0	EC002503
ETIM 10.0	EC002503	ECLASS 14.0	27-18-05-02
ECLASS 15.0	27-18-05-02		

KLIPPON POK2 M20ACSS EX

Weidmüller Interface GmbH & Co. KG
Klingenbergstraße 26
D-32758 Detmold
Germany

Drawings

www.weidmueller.com

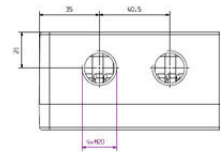
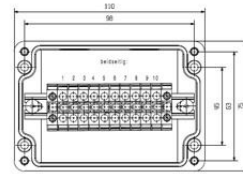

KLIPPON POK2 M20ACSS EX

Weidmüller Interface GmbH & Co. KG
 Klingenbergstraße 26
 D-32758 Detmold
 Germany

www.weidmueller.com

Accessories

Silicone seal material, -60°C - +70°C



Polyamide cable glands, which are suitable for usage in explosion risk zones Ex e (increased safety) and Ex i (intrinsic safety). Weidmüller offers a product family without restrictions and besides compliance with standards, the cable gland excels thanks to its increased impact resistance of 4/7 Joule and a possible temperature range down to -60°C without restrictions. They have been tested to the current standard and EN 60079-0 directive, they are ATEX and IECEx certified.

General ordering data

Type	VG M20 EXE 7-13 SI7J G4	Version
Order No.	2722110000	VG Exe 7J (Ex plastic cable gland 7J Exe), Cable glands, straight, M
GTIN (EAN)	4050118821345	20, 10 mm, OD min. 7 - OD max. 13 mm, IP54, IP66, IP67, IP68 - 5
Qty.	50 ST	bar (30 min.), Polyamide 6
Type	VG M20 EXE 11-14 SI7J G4	Version
Order No.	2722120000	VG Exe 7J (Ex plastic cable gland 7J Exe), Cable glands, straight, M
GTIN (EAN)	4050118821352	20, 10 mm, OD min. 11 - OD max. 14 mm, IP54, IP66, IP67, IP68 - 5
Qty.	50 ST	bar (30 min.), Polyamide 6

Metric



A2L type cable glands are suitable for un-armored cable, maintains flameproof Ex d and Increased Safety Ex e explosion protection.

General ordering data

Type	A2L/16/M16-WM	Version
Order No.	1186880000	A2L (Klippon unarmored Ex e/d cable gland), Cable glands, straight,
GTIN (EAN)	4050118074345	M 16 x 1.5, 16 mm, OD min. 4.5 - OD max. 8.7 mm, Brass, nickel-
Qty.	24 ST	plated

Plastic blanking plugs Ex e/i 7 Joule



In addition to cable glands for a wide range of applications, the product portfolio is rounded off by plugs, pressure compensation elements, adaptors and the corresponding accessories such as locknuts, sealing rings, flat washers and earthing rings.

KLIPPON POK2 M20ACSS EX

Weidmüller Interface GmbH & Co. KG
 Klingenbergstraße 26
 D-32758 Detmold
 Germany

www.weidmueller.com

Accessories

General ordering data

Type	VP M20 EX SI 7J	Version
Order No.	2066730000	VPK EX 7J (Ex blanking plug, plastic, 7J), Blanking plug, in closed
GTIN (EAN)	4050118415346	state, M 20, 11 mm, IP54, IP66, IP67, IP68 - 5 bar (30 min.),
Qty.	100 ST	Polyamide 6

Brass blanking plugs, VP HEX head Ex e/d



VP series stopping plugs provide a method of filling unused entries in Ex equipment while maintaining Flameproof Ex d and Increased Safety Ex e explosion protection and IP66/67/68 ingress rate.

General ordering data

Type	VP-HEX M16-EX W	Version
Order No.	1218940000	VP-HEX (Klippon Ex blanking plug with hexagon head), Blanking plug,
GTIN (EAN)	4050118075564	straight, M 16 x 1.5, 16 mm, Brass, nickel-plated
Qty.	24 ST	

External thread M20



ADAP series adaptors provide flexibility and versatility infilling unused entries in Ex equipment while maintaining Flameproof Ex d and Increased Safety Ex e explosion protection and IP66/67/68 ingress rate.

General ordering data

Type	ADAP M20-M16-W	Version
Order No.	1262740000	ADAP (Klippon Ex adaptor), Adapter, straight, M 20 ,M 16, Brass,
GTIN (EAN)	4050118088625	nickel-plated
Qty.	24 ST	