

**HDC HA 3/4 HQ5 PUSHIN CP**

**Weidmüller Interface GmbH & Co. KG**  
Klingenbergstraße 26  
D-32758 Detmold  
Germany

[www.weidmueller.com](http://www.weidmueller.com)



Various accessories are available for our inserts. This includes coding elements for the inserts.

**General ordering data**

Version	Heavy-duty connectors, Accessories
Order No.	<a href="#">3142030000</a>
Type	HDC HA 3/4 HQ5 PUSHIN CP
GTIN (EAN)	4099987491730
Qty.	10 items

**HDC HA 3/4 HQ5 PUSHIN CP**

**Weidmüller Interface GmbH & Co. KG**  
 Klingenbergstraße 26  
 D-32758 Detmold  
 Germany

[www.weidmueller.com](http://www.weidmueller.com)

**Technical data**

**Approvals**

ROHS	Conform
------	---------

**Dimensions and weights**

Depth	3.6 mm	Depth (inches)	0.1417 inch
Length	17.5 mm	Length (inches)	0.689 inch
Net weight	0.11 g		

**Environmental Product Compliance**

RoHS Compliance Status	Compliant without exemption
REACH SVHC	No SVHC above 0.1 wt%

**Important note**

Product information	The coding elements can be inserted in the middle of the contact carrier. Both sides of the connectors must be equipped with them.
---------------------	--

**Classifications**

ETIM 8.0	EC002311	ETIM 9.0	EC002311
ETIM 10.0	EC002311	ECLASS 14.0	27-44-02-03
ECLASS 15.0	27-44-02-03		

**HDC HA 3/4 HQ5 PUSHIN CP**

**Weidmüller Interface GmbH & Co. KG**  
Klingenbergstraße 26  
D-32758 Detmold  
Germany

[www.weidmueller.com](http://www.weidmueller.com)

**Drawings**

**Drawing**

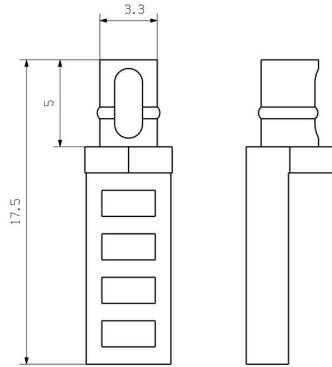

**Drawing**

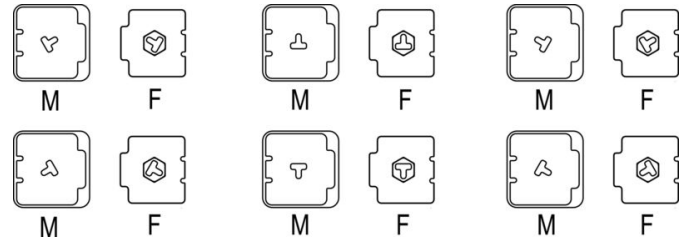

Coding scheme