

**VT-TM 5/30 HF-V0**

**Weidmüller Interface GmbH & Co. KG**  
Klingenbergstraße 26  
D-32758 Detmold  
Germany

www.weidmueller.com

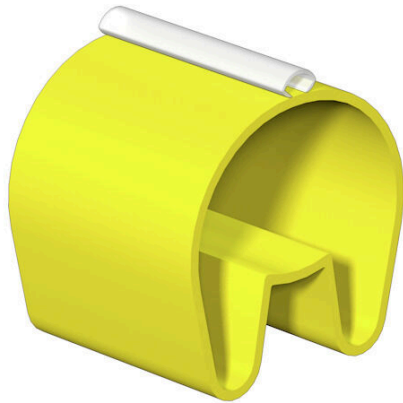

**General ordering data**

Version	, Socket x 5.3 mm, TPU, Colour: yellow, Transparent, Conductor O.D.: 24 - 35 mm
Order No.	<a href="#">2902840000</a>
Type	VT-TM 5/30 HF-V0
GTIN (EAN)	4099986005396
Qty.	30 items

**VT-TM 5/30 HF-V0**

**Weidmüller Interface GmbH & Co. KG**  
 Klingenbergstraße 26  
 D-32758 Detmold  
 Germany

www.weidmueller.com

**Technical data**

**Approvals**

ROHS	Conform
------	---------

**Dimensions and weights**

Height	30 mm	Height (inches)	1.1811 inch
Width	5.3 mm	Width (inches)	0.2087 inch
Net weight	4 g		

**Temperatures**

Operating temperature range	-30...90 °C
-----------------------------	-------------

**Environmental Product Compliance**

RoHS Compliance Status	Compliant without exemption
REACH SVHC	No SVHC above 0.1 wt%

**General data**

Type of printing	neutral	Width	5.3 mm
UL 94 flammability rating	V-0	Operating temperature range, max.	90 °C
Operating temperature range, min.	-30 °C	Colour	yellow, Transparent
Halogen	No	Basic material	TPU
Printed characters	without	Recommended industries	Transportation, Machinery
Operating temperature range	-30...90 °C		

**Conductor and cable markers**

Halogen	No	Conductor cross-section, max.	70 mm <sup>2</sup>
Conductor cross-section, min.	25 mm <sup>2</sup>	Conductor O.D., max.	35 mm
Conductor O.D., min.	24 mm	Conductor O.D.	24 - 35 mm
Cross-section for connected wire	25 - 70 mm <sup>2</sup>		

**Classifications**

ETIM 8.0	EC001530	ETIM 9.0	EC001530
ETIM 10.0	EC001530	ECLASS 14.0	27-28-11-02
ECLASS 15.0	27-28-11-02		

**VT-TM 5/30 HF-V0**

**Weidmüller Interface GmbH & Co. KG**  
 Klingenbergstraße 26  
 D-32758 Detmold  
 Germany

www.weidmueller.com

**Accessories**

**Blank**



TM-I is an acknowledged and accredited marker type for traffic engineering applications. There are various different tag lengths available for individual labelling with long character strings. Easy handling of separation and installation thanks to the project marker field. Pre-attachment of sleeves and retrofitting of tags offer excellent versatility

The special contour of TM-I allows easy assembly and secures firm positioning. They are compatible with a number of commercially available sleeves. Thanks to the MultiCard format, the tags can be printed quickly and conveniently with the PrintJet CONNECT, plotter or the STI pen.

- Easy handling of separation and installation thanks to the project marker field.
- Acknowledged and accredited marker for traffic engineering applications
- Pre-attachment of sleeves and retrofitting of tags offer excellent versatility
- Not suited for labelling with P-Ink or STI pen in connection with CLI T sleeves

For custom printing: Please send us a file of our labeling software M-Print PRO or M-Print PRO Online (without installation) for your labeling specifications.

**General ordering data**

Type	TM-I 30 MC NE WS	Version
Order No.	<a href="#">1876390000</a>	TM-I, Insert markers, 1.3 - 35 mm, 30 x 4 mm, white
GTIN (EAN)	4032248466450	
Qty.	300 ST	
Type	TM-I 30 MC NE GE	Version
Order No.	<a href="#">1876370000</a>	TM-I, Insert markers, 1.3 - 35 mm, 30 x 4 mm, yellow
GTIN (EAN)	4032248466443	
Qty.	300 ST	
Type	TM-I 30 MC NE RT	Version
Order No.	<a href="#">1876380000</a>	TM-I, Insert markers, 1.3 - 35 mm, 30 x 4 mm, red
GTIN (EAN)	4032248466474	
Qty.	300 ST	
Type	TM-I 30 MC NE BL	Version
Order No.	<a href="#">1876400000</a>	TM-I, Insert markers, 1.3 - 35 mm, 30 x 4 mm, blue
GTIN (EAN)	4032248466467	
Qty.	300 ST	
Type	TM-I 30 MC NE GN	Version
Order No.	<a href="#">1365610000</a>	TM-I, Insert markers, 1.7 - 79 mm, 30 x 4 mm, green
GTIN (EAN)	4050118171907	
Qty.	300 ST	

**VT-TM 5/30 HF-V0**

**Weidmüller Interface GmbH & Co. KG**  
 Klingenbergstraße 26  
 D-32758 Detmold  
 Germany

**Accessories**

www.weidmueller.com

**TM-I 30**



**Process reliability: TM-I**

TM-I inlay tags have a guide tab which allows them to slide easily into the transparent sleeves from the type TM. Once the tag is in place, the tab is snapped off at the predetermined break point. The ready-assembled sleeves can then be simply pushed over the conductors. Your benefits: large quantities can be efficiently pre-assembled in a single step.

**General ordering data**

Type	TM-I 30 MM WS	Version
Order No.	<a href="#">2005530000</a>	TM-I, Insert markers, 1.3 - 35 mm, 30 x 4 mm, white
GTIN (EAN)	4050118390070	
Qty.	2000 ST	
Type	TM-I 30 MM GE	Version
Order No.	<a href="#">2005700000</a>	TM-I, Insert markers, 1.3 - 35 mm, 30 x 4 mm, yellow
GTIN (EAN)	4050118390339	
Qty.	2000 ST	
Type	TM-I 30 MM RT	Version
Order No.	<a href="#">2005870000</a>	TM-I, Insert markers, 1.3 - 35 mm, 30 x 4 mm, red
GTIN (EAN)	4050118390384	
Qty.	2000 ST	
Type	TM-I 30 MM BL	Version
Order No.	<a href="#">2005990000</a>	TM-I, Insert markers, 1.3 - 35 mm, 30 x 4 mm, blue
GTIN (EAN)	4050118390452	
Qty.	2000 ST	