

IE-TO-SPO-C-LP**Weidmüller Interface GmbH & Co. KG**Klingenbergstraße 26
D-32758 Detmold
Germany

www.weidmueller.com

**SPElink**[®]

Mounting rail outlets for SPE plug-in connectors, IP20
Single pair Ethernet is a technology that only requires one pair of wires to transmit data and power.

The resulting benefits will make SPE the preferred network at the field level and beyond. Advantages of Single Pair Ethernet

- Consistent: Single Pair Ethernet enables uniform Ethernet-based communication from the sensor to the cloud
- Future-proof: key technology for Industry 4.0 and IIoT
- Flexible: ranges of up to 1000 m and transmission properties of up to 1 Gbps enable use across applications
- Innovative: lighter, less space required, and reduced installation effort

General ordering data

Version	Mounting rail outlet SPE, IP30, in closed state, T1-B
Order No.	2870790000
Type	IE-TO-SPO-C-LP
GTIN (EAN)	4064675631781
Qty.	10 items

IE-TO-SP0-C-LP

Weidmüller Interface GmbH & Co. KG

Klingenbergstraße 26

D-32758 Detmold

Germany

www.weidmueller.com

Technical data

Approvals

ROHS Conform

Dimensions and weights

Net weight 13.28 g

Temperatures

Storage temperature	Operating temperature	-40 °C...70 °C
Installation temperature		

Environmental Product Compliance

RoHS Compliance Status	Compliant without exemption
REACH SVHC	No SVHC above 0.1 wt%

General data

Reference product	IE-BI-SP0-C	Connection 1	SPE socket acc. to IEC 63171-2
Connection 2	SPE socket acc. to IEC 63171-2	UL 94 flammability rating	V-0
Category	T1-B	Contact surface	Gold over nickel
Protection degree	IP30, in closed state	Plugging cycles	750

Electrical properties

Dielectric strength, contact / shield	2250 V DC	Dielectric strength, contact / contact	≥ 1000 V DC
Insulation resistance	≥ 500 MΩ	Rated current	3.5 A at 0°C
PoE / PoE+	PoDL acc. to IEEE 802.3bu / cg		

General standards

Connector standard IEC 63171-2

Classifications

ETIM 8.0	EC000313	ETIM 9.0	EC000313
ETIM 10.0	EC000313	ECLASS 14.0	27-44-03-20
ECLASS 15.0	27-44-03-20		

Drawings

Dimensional drawing

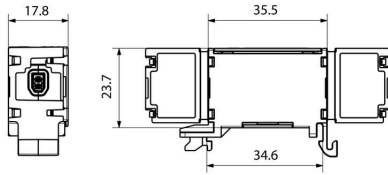

Derating curve

Level I gem. IEC 63171

