

**CH-SMC-00.80-CG90****Weidmüller Interface GmbH & Co. KG**

Klingenbergstraße 26

D-32758 Detmold

Germany

www.weidmueller.com

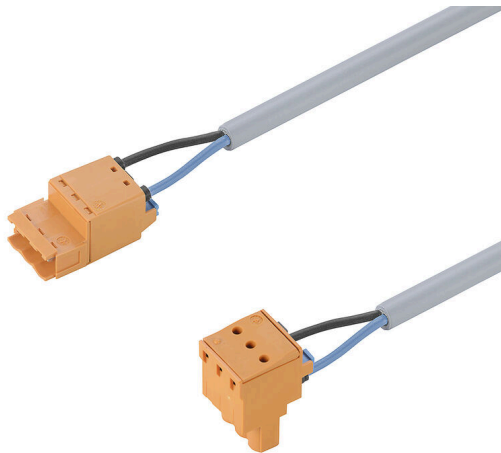

Base counter, gateway, control box and overvoltage protection device are connected with pre-assembled cable sets as point-to-point or Y-assembly. Weidmüller offers the right connection solutions for this, conforming to FNN and DIN-VDE 0603 standards. Pre-assembled power cables with 6kV overvoltage protection round up the portfolio.

**General ordering data**

|            |  |
|------------|--|
| Version    | Smart Metering Cable Assemblies, 6 kV, Socket connector, IP20, 600 V, KB PUR US 2X1.5 GY XX 6KV, 0.8 m |
| Order No.  | <a href="#">2775910080</a>   |
| Type       | CH-SMC-00.80-CG90  |
| GTIN (EAN) | 4064675329732  |
| Qty.       | 10 items   |

**Technical data**

**Approvals**

|      |         |
|------|---------|
| ROHS | Conform |
|------|---------|

**Dimensions and weights**

|          |        |            |      |
|----------|--------|------------|------|
| Diameter | 6.4 mm | Net weight | 93 g |
|----------|--------|------------|------|

**Environmental Product Compliance**

|                        |                             |
|------------------------|-----------------------------|
| RoHS Compliance Status | Compliant without exemption |
| REACH SVHC             | No SVHC above 0.1 wt%       |

**General Technical Data**

|                   |       |                                 |        |
|-------------------|-------|---------------------------------|--------|
| Number of poles   | 2     | Rated impulse withstand voltage | 6 kV   |
| Nominal voltage   | 600 V | Nominal current                 | 18.5 A |
| Protection degree | IP20  |                                 |        |

**Technical Specifications Connector**

|           |                 |        |
|-----------|-----------------|--------|
| Connector | Number of poles | 2      |
|           | Number of poles | 2      |
|           | Type            | Female |

**Technical specifications for cable**

|                                     |                     |                                     |                           |
|-------------------------------------|---------------------|-------------------------------------|---------------------------|
| Cable length                        | 0.8 m               | Line type                           | KB PUR US 2X1.5 GY XX 6KV |
| Sheathing colour                    | grey                | Resistance to oils                  | Yes                       |
| Core cross-section                  | 1.5 mm <sup>2</sup> | Number of wires                     | 2                         |
| Shielded                            | No                  | Halogen                             | No                        |
| Insulation                          | PP                  | Temperature range, moving, max.     | 90 °C                     |
| Temperature range, moving, min.     | -30 °C              | Temperature range, stationary, max. | 90 °C                     |
| Temperature range, stationary, min. | -40 °C              | Cable Material                      | PUR/ TPE                  |
| Bending radius, min., moving        | 15 x cable diameter | Bending radius, min., stationary    | 10 x cable diameter       |
| Outside diameter                    | 6.4 mm ± 0.25 mm    |                                     |                           |

**Classifications**

|             |             |             |             |
|-------------|-------------|-------------|-------------|
| ETIM 8.0    | EC001576    | ETIM 9.0    | EC001576    |
| ETIM 10.0   | EC001576    | ECLASS 14.0 | 27-06-04-02 |
| ECLASS 15.0 | 27-06-04-02 |             |             |

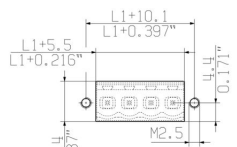
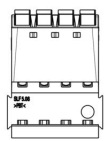
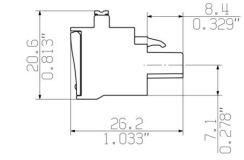
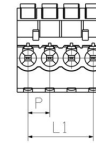
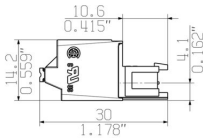
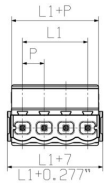

MIN. FRONT PLATE CUT-OUT  
 FOR USE WITH SLA BB12R

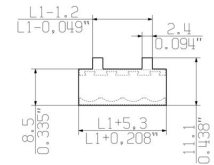
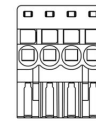

MIN. FRONT PLATE CUT-OUT