

HDC 06B TOS 1M25 WMP**Weidmüller Interface GmbH & Co. KG**

Klingenbergstraße 26

D-32758 Detmold

Germany

www.weidmueller.com



Our flange-mounted housings made of plastic have a built-in cable gland and a screw interlock. They seal directly onto the panel wall and can therefore be used without an attachment housing. The housings are impressive with their low weight and optimal protection against contamination, water and vibrations.

General ordering data

Version	HDC enclosures, Installation size: 3, Protection degree: IP66, IP67, in plugged condition, Cable entry from top, Screw, , Size of cable entries: M 25
Order No.	2716700000
Type	HDC 06B TOS 1M25 WMP
GTIN (EAN)	4050118803280
Qty.	1 items

HDC 06B TOS 1M25 WMP

Weidmüller Interface GmbH & Co. KG
 Klingenbergstraße 26
 D-32758 Detmold
 Germany

www.weidmueller.com

Technical data

Approvals

Approvals



ROHS Conform

UL File Number Search [UL Website](#)

Certificate No. (cURus) E223801

Dimensions and weights

Height	131 mm	Height (inches)	5.1575 inch
Net weight	122 g		

Temperatures

Ambient temperature -40 °C...100 °C

Environmental Product Compliance

RoHS Compliance Status Compliant without exemption

REACH SVHC No SVHC above 0.1 wt%

Cable Gland WMP

Cable diameter, min.	9 mm	Cable diameter, max.	17 mm
AF size	26 mm	Size of cable entries	M 25

Dimensions

Cable entry	w. cable glands	Height of housing B	131 mm
-------------	-----------------	---------------------	--------

General data

UL 94 flammability rating	V-0	Surface finish	untreated
Protection degree	IP66, IP67, in plugged condition		

Version

Number of cable glands	1	Size of cable entries	M 25
Top part/bottom part/lid	upper part	Cover	without cover
Tightening torque	3 Nm	Number of cable entry on top	1
Number of cable entry sideways	1	Design of housing	Cable entry from top
Design of locking system	Screw	Installation size	3
Cable entry	w. cable glands	Type	Plug
Sealing	NBR	Colour (RAL)	RAL 9011
BG	3	Suitable for ModuPlug®	Yes

Classifications

ETIM 8.0	EC000437	ETIM 9.0	EC000437
ETIM 10.0	EC000437	ECLASS 14.0	27-44-02-02
ECLASS 15.0	27-44-02-02		

HDC 06B TOS 1M25 WMP

Weidmüller Interface GmbH & Co. KG
Klingenbergstraße 26
D-32758 Detmold
Germany

Drawings

www.weidmueller.com

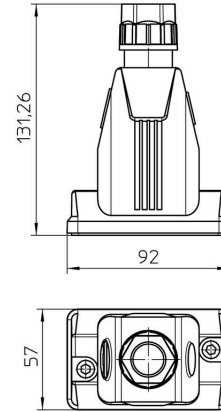
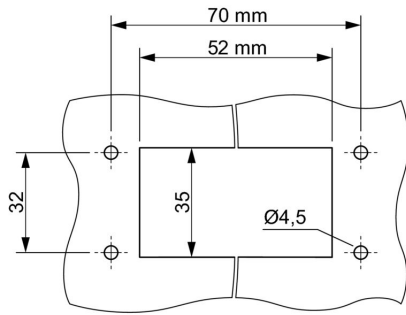

HDC 06B TOS 1M25 WMP

Weidmüller Interface GmbH & Co. KG
 Klingenbergstraße 26
 D-32758 Detmold
 Germany

Accessories

www.weidmueller.com

Mounting brackets



Our flange-mounted housings made of plastic have a built-in cable gland and a screw interlock. They seal directly onto the panel wall and can therefore be used without an attachment housing. The housings are impressive with their low weight and optimal protection against contamination, water and vibrations.

General ordering data

Type	HDC AF SET WM	Version	
Order No.	2716800000	HDC enclosures, Installation size: , Protection degree:	
GTIN (EAN)	4050118803679		
Qty.	1 ST		
Type	HDC AF WM	Version	
Order No.	2716790000	HDC enclosures, Installation size: , Protection degree:	
GTIN (EAN)	4050118803662		
Qty.	20 ST		