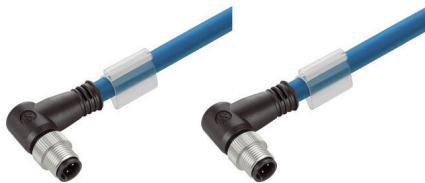

IE-C5DB4BB0100MCAMCA-X**Weidmüller Interface GmbH & Co. KG**

Klingenbergstraße 26

D-32758 Detmold

Germany

www.weidmueller.com

Assembled IE cables, railway cable, Cat.5, blue, M12

General ordering data

| | |
|------------|--|
| Version | System cable, M12 D-code – IP 67 angled pin, M12 D-code – IP 67 angled pin, Cat. 5e, Polyole- fine, 10 m |
| Order No. | 2672340100 |
| Type | IE-C5DB4BB0100MCAMCA-X |
| GTIN (EAN) | 4064675262237 |
| Qty. | 1 items |

IE-C5DB4BB0100MCAMCA-X

Weidmüller Interface GmbH & Co. KG

Klingenbergstraße 26

D-32758 Detmold

Germany

www.weidmueller.com

Technical data

Approvals

| | |
|------|---------|
| ROHS | Conform |
|------|---------|

Dimensions and weights

| | | | |
|------------|-------|-----------------|---------------|
| Length | 10 m | Length (inches) | 393.7008 inch |
| Net weight | 400 g | | |

Temperatures

| | | |
|--------------------------|-----------------------|----------------|
| Storage temperature | Operating temperature | -40 °C...90 °C |
| Installation temperature | | |

Environmental Product Compliance

| | |
|--------------------------------------|--------------------------------------|
| RoHS Compliance Status | Compliant with exemption |
| RoHS Exemption (if applicable/known) | 6c |
| REACH SVHC | Lead 7439-92-1 |
| SCIP | 67cf1078-beca-4687-860b-dc475a6ec24a |

Cable specific standards

| | | | |
|---|---|----------------------------------|--|
| Flames propagate vertically on bundled cables | EN 60332-3-25, According to UL1685, 12 (FT4 exp.) | Hydrogen halide content | According to EN-50267-2-1 |
| Corrosiveness of fumes | EN 50267-2-2 | Fire safety for railway vehicles | According to EN 45545, HL1 - HL3, NFPA 130 |
| Impervious to smoke | According to IEC 61034-2 | Poisonous gases | EN 50305 |

Electrical properties

| | |
|-----------------|-------|
| Nominal voltage | 125 V |
|-----------------|-------|

General standards

| | |
|--------------------|-----------------|
| Connector standard | IEC 61076-2-101 |
|--------------------|-----------------|

Cable structure

| | | | |
|---|-----------------------|------------------------------|-----------------------------|
| Wire connection cross section AWG, max. | AWG 22 | Sheathing colour | blue |
| Cross-section | 4*AWG 22/7 - 0.32 mm² | Shielding | SF/UTP |
| Number of wires | 4 | Insulation | PE |
| Sheath diameter, max. | 6.8 mm | Sheath diameter, min. | 6.4 mm |
| Material sheath | Polyolefine | Wire pair shielding | Plastic foil |
| Wire core insulation thickness | 1.4 mm | Colour coding | yellow, white, orange, blue |
| Wire material | tinned copper | Sheathing material thickness | 1 mm |

Electrical properties of cable

| | | | |
|-----------------------------------|-------------------------|-------------------------------------|----------|
| Category | Cat. 5e | Coupling attenuation up to 1000 MHz | 90 dB |
| Coupling resistance at 10 MHz / m | 8.00 mΩ | Shield attenuation up to 1000 MHz | 60.00 dB |
| Test voltage: wire-wire-shield | 1000 Veff, 50 Hz, 1 min | | |

IE-C5DB4BB0100MCAMCA-X

Weidmüller Interface GmbH & Co. KG
 Klingenbergstraße 26
 D-32758 Detmold
 Germany

www.weidmueller.com

Technical data

Mechanical and material properties of cable

| | | | |
|---------------------------------|----------------------------------|--------------------------------|--------------------|
| Resistance to oils | in accordance with IEC 60811:404 | Halogen | No |
| Min. bending radius, repetitive | 6 *diameter | Min. bending radius, once only | 5 x cable diameter |
| Resistance to spread of flame | in accordance with IEC 60332-1-2 | Corrosiveness of fumes | EN 50267-2-2 |
| Impervious to smoke | According to IEC 61034-2 | | |

Plug, left

| | |
|-----------|--|
| Plug left | M12, D-coded, Number of poles: 4, IP67, male contact, angled 0°, plug, Plastic, shielded |
|-----------|--|

Plug, right

| | |
|------------|--|
| Plug right | M12, D-coded, Number of poles: 4, IP67, male contact, angled 0°, plug, Plastic, shielded |
|------------|--|

Classifications

| | | | |
|-------------|-------------|-------------|-------------|
| ETIM 8.0 | EC002599 | ETIM 9.0 | EC002599 |
| ETIM 10.0 | EC002599 | ECLASS 14.0 | 27-06-03-08 |
| ECLASS 15.0 | 27-06-03-08 | | |

IE-C5DB4BB0100MCAMCA-X

Weidmüller Interface GmbH & Co. KG
Klingenbergstraße 26
D-32758 Detmold
Germany

www.weidmueller.com

Drawings

Dimensioned drawing



Dimensioned drawing

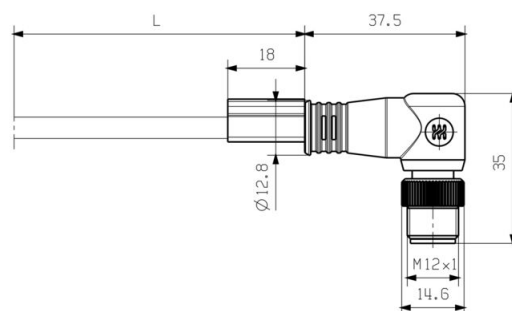

Wiring diagram

| M12 | | M12 |
|-----|--------|-----|
| 1 | yellow | 1 |
| 2 | white | 2 |
| 3 | orange | 3 |
| 4 | blue | 4 |

Detailed drawing

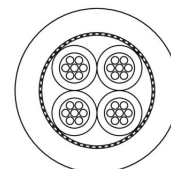

IE-C5DB4BB0100MCAMCA-X

Weidmüller Interface GmbH & Co. KG
 Klingenbergstraße 26
 D-32758 Detmold
 Germany

www.weidmueller.com

Accessories

Screwty® cable gland tool



The ideal tool for any application

Screwty® is the ideal, all-purpose tool for tightening all common sensor and actuator cables. Even difficult-to-reach round plugs are accessible using the Screwty®. A simple turning movement tightens and loosens the connectors without the need for excessive force. The Screwty® is a unique and global solution since it fits with most cables and plugs from other vendors (over 90 %). The Screwty® consists of a handle with a conventional 1/4" adapter. Thus it can be used for all sizes: for M12 and M8 round plug-in connectors, and for M12F and M8F customisable plugs and sockets, as well as for all M23 plugs and sockets.

General ordering data

| | | |
|------------|----------------------------|---|
| Type | SCREWTY SET | Version |
| Order No. | 1910000000 | Cable gland tool for M8, M12 lines and connectors |
| GTIN (EAN) | 4032248436842 | |
| Qty. | 1 ST | |

Screwty® cable gland tool with torque function



The ideal tool for any application

Screwty® is the ideal, all-purpose tool for tightening all common sensor and actuator cables. Even difficult-to-reach round plugs are accessible using the Screwty®. A simple turning movement tightens and loosens the connectors without the need for excessive force. The Screwty® is a unique and global solution since it fits with most cables and plugs from other vendors (over 90 %). The Screwty® consists of a handle with a conventional 1/4" adapter. Thus it can be used for all sizes: for M12 and M8 round plug-in connectors, and for M12F and M8F customisable plugs and sockets, as well as for all M23 plugs and sockets.

General ordering data

| | | |
|------------|----------------------------|---|
| Type | SCREWTY SET -DM | Version |
| Order No. | 1920000000 | Cable gland tool for M8, M12 lines and connectors |
| GTIN (EAN) | 4032248436859 | |
| Qty. | 1 ST | |

IE-C5DB4BB0100MCAMCA-X

Weidmüller Interface GmbH & Co. KG
 Klingenbergstraße 26
 D-32758 Detmold
 Germany

www.weidmueller.com

Accessories

Screwty® cable gland tool



The ideal tool for any application

Screwty® is the ideal, all-purpose tool for tightening all common sensor and actuator cables. Even difficult-to-reach round plugs are accessible using the Screwty®. A simple turning movement tightens and loosens the connectors without the need for excessive force. The Screwty® is a unique and global solution since it fits with most cables and plugs from other vendors (over 90 %). The Screwty® consists of a handle with a conventional 1/4" adapter. Thus it can be used for all sizes: for M12 and M8 round plug-in connectors, and for M12F and M8F customisable plugs and sockets, as well as for all M23 plugs and sockets.

General ordering data

| | | |
|------------|----------------------------|--|
| Type | SCREWTY- M12 | Version |
| Order No. | 1900000000 | Cable gland tool for moulded M12 lines |
| GTIN (EAN) | 4032248375868 | |
| Qty. | 1 ST | |

Screwty® cable gland tool with torque function



The ideal tool for any application

Screwty® is the ideal, all-purpose tool for tightening all common sensor and actuator cables. Even difficult-to-reach round plugs are accessible using the Screwty®. A simple turning movement tightens and loosens the connectors without the need for excessive force. The Screwty® is a unique and global solution since it fits with most cables and plugs from other vendors (over 90 %). The Screwty® consists of a handle with a conventional 1/4" adapter. Thus it can be used for all sizes: for M12 and M8 round plug-in connectors, and for M12F and M8F customisable plugs and sockets, as well as for all M23 plugs and sockets.

General ordering data

| | | |
|------------|----------------------------|--|
| Type | SCREWTY-M12-DM | Version |
| Order No. | 1900001000 | Cable gland tool for moulded M12 lines |
| GTIN (EAN) | 4032248436408 | |
| Qty. | 1 ST | |