

**HDC HP550 STGH CR 1P****Weidmüller Interface GmbH & Co. KG**

Klingenbergstraße 26

D-32758 Detmold

Germany

[www.weidmueller.com](http://www.weidmueller.com)

The protective housing is manufactured from seawater-resistant aluminium using pressure die casting. High standards of water and dust protection, as well as particularly high impact resistance, are the hallmarks of this housing series.

A sophisticated two-stage surface coating ensures years of reliability.

All screws, crimp contacts and other exterior accessory parts are made of corrosion-resistant stainless steel.

**General ordering data**

Order No.	2568600000
Type	<a href="#">HDC HP550 STGH CR 1P</a>
GTIN (EAN)	4050118776621
Qty.	1 items

**HDC HP550 STGH CR 1P****Weidmüller Interface GmbH & Co. KG**

Klingenbergstraße 26

D-32758 Detmold

Germany

[www.weidmueller.com](http://www.weidmueller.com)**Technical data****Approvals**

Approvals

**Dimensions and weights**

Net weight 431 g

**Environmental Product Compliance**

RoHS Compliance Status Compliant without exemption

REACH SVHC No SVHC above 0.1 wt%

**General data**

Design of housing	Bulkhead housing	UL 94 flammability rating	None
Colour	black	Surface finish	Powder-coated
Free from halogens	false	Protection degree	IP68, in plugged condition

**General data**

Colour	black	Surface finish	Powder-coated
--------	-------	----------------	---------------

**Important note**

Product information	Depending on the intended operation, internally generated voltages can superimpose the working voltage and contain corresponding peaks. It is imperative to ensure that these peak voltages do not exceed the rated voltage. For applications outside of this specification, please contact us.
---------------------	---

**Classifications**

ETIM 8.0	EC000437	ETIM 9.0	EC000437
ETIM 10.0	EC000437	ECLASS 14.0	27-44-02-02
ECLASS 15.0	27-44-02-02		

**HDC HP550 STGH CR 1P**

**Weidmüller Interface GmbH & Co. KG**  
Klingenbergstraße 26  
D-32758 Detmold  
Germany

[www.weidmueller.com](http://www.weidmueller.com)

**Drawings**

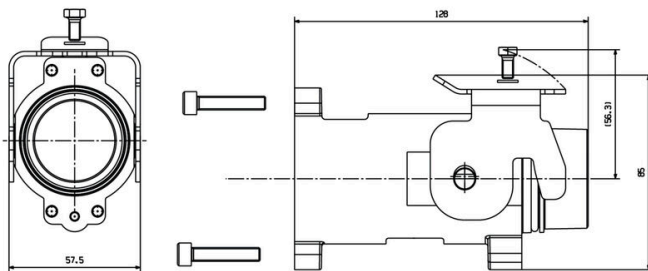

## HDC HP550 STGH CR 1P

**Weidmüller Interface GmbH & Co. KG**  
 Klingenbergstraße 26  
 D-32758 Detmold  
 Germany

www.weidmueller.com

## Accessories

## Crimp contacts



Crimps provide a electrical and mechanical connection between wire and contact that is both secure and reliable. The optimal crimp connection is gas-tight and corrosion-resistant.

## General ordering data

Type	HDC HP 550 M 25	Version
Order No.	<a href="#">1220580000</a>	HDC insert, Male, Crimp connection, Installation size: 550
GTIN (EAN)	4050118003857	
Qty.	1 ST	
Type	HDC HP 550 M 50	Version
Order No.	<a href="#">1157800000</a>	HDC insert, Male, Crimp connection, Installation size: 550
GTIN (EAN)	4032248945337	
Qty.	1 ST	
Type	HDC HP 550 M 70	Version
Order No.	<a href="#">1268810000</a>	HDC insert, Male, Crimp connection, Installation size: 550
GTIN (EAN)	4050118057720	
Qty.	1 ST	
Type	HDC HP 550 M 95	Version
Order No.	<a href="#">1079790000</a>	HDC insert, Male, Crimp connection, Installation size: 550
GTIN (EAN)	4032248841653	
Qty.	1 ST	
Type	HDC HP 550 M 120	Version
Order No.	<a href="#">1079780000</a>	HDC insert, Male, Crimp connection, Installation size: 550
GTIN (EAN)	4032248841899	
Qty.	1 ST	
Type	HDC HP 550 M 150	Version
Order No.	<a href="#">1119110000</a>	HDC insert, Male, Crimp connection, Installation size: 550
GTIN (EAN)	4032248900367	
Qty.	1 ST	
Type	HDC HP 550 M 185	Version
Order No.	<a href="#">1120580000</a>	HDC insert, Male, Crimp connection, Installation size: 550
GTIN (EAN)	4032248901821	
Qty.	1 ST	
Type	HDC HP 550 M 240	Version
Order No.	<a href="#">1120590000</a>	HDC insert, Male, Crimp connection, Installation size: 550
GTIN (EAN)	4032248901739	
Qty.	1 ST	