

## HDC MBUS8 F AWG26-24

**Weidmüller Interface GmbH & Co. KG**  
Klingenbergstraße 26  
D-32758 Detmold  
Germany

[www.weidmueller.com](http://www.weidmueller.com)



### Compact

The new two-pole bus module is extremely compact and can accommodate both megabit and gigabit data inserts. It enables the connection of 2 Gigabit Cat 6A cables (10 gigabit) to one module.

### General ordering data

Version	Crimp contact
Order No.	<a href="#">2565950000</a>
Type	HDC MBUS8 F AWG26-24
GTIN (EAN)	4050118575804
Qty.	100 items

**HDC MBUS8 F AWG26-24**

**Weidmüller Interface GmbH & Co. KG**  
 Klingenbergstraße 26  
 D-32758 Detmold  
 Germany

www.weidmueller.com

**Technical data**

**Approvals**

Approvals



ROHS Conform

**Dimensions and weights**

Net weight 0 g

**Temperatures**

Limit temperature -40 °C ... 90 °C

**Environmental Product Compliance**

RoHS Compliance Status Compliant with exemption  
 RoHS Exemption (if applicable/known) 6c  
 REACH SVHC Lead 7439-92-1  
 SCIP 6eabd5ae-2d6b-409e-8bdf-87c27ee10e40

**General data**

Contact diameter, male Ø	0.6 mm	Stripping length, rated connection	4 mm
Type of connection	Crimp connection	Version insert	MBUS
Conductor cross-section, max.	0.25 mm <sup>2</sup>	Conductor cross-section, min.	0.14 mm <sup>2</sup>
Surface finish	gold	Plugging cycles	≥ 500
Type	Female	Basic material	Copper alloy
Series	ModuPlug	Production methods	turned
Material of contact	Copper alloy		

**General data**

Contact surface	Gold-plated	Transmission rate	10 Gbps
Nominal current	0.5 A	Plugging cycles	≥ 500
Type	Female		

**Classifications**

ETIM 8.0	EC000796	ETIM 9.0	EC000796
ETIM 10.0	EC000796	ECLASS 14.0	27-44-02-04
ECLASS 15.0	27-44-02-04		

**HDC MBUS8 F AWG26-24**

**Weidmüller Interface GmbH & Co. KG**  
Klingenbergstraße 26  
D-32758 Detmold  
Germany

**Drawings**

[www.weidmueller.com](http://www.weidmueller.com)

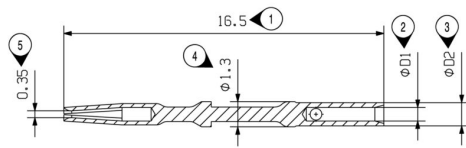
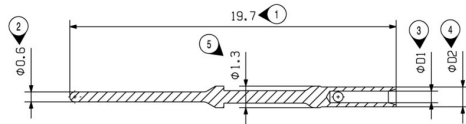

## HDC MBUS8 F AWG26-24

**Weidmüller Interface GmbH & Co. KG**  
 Klingenbergstraße 26  
 D-32758 Detmold  
 Germany

[www.weidmueller.com](http://www.weidmueller.com)

## Accessories

### Tools



#### Compact

The new two-pole bus module is extremely compact and can accommodate both megabit and gigabit data inserts. It enables the connection of 2 Gigabit Cat 6A cables (10 gigabit) to one module.

### General ordering data

Type	HDC MBUS CL X/D 0.6/1.0	Version	
Order No.	<a href="#">2592680000</a>	Locator for crimping tool	
GTIN (EAN)	4050118603781		
Qty.	1 ST		
Type	HDC MBUS CT X/D 0.6/1.0	Version	
Order No.	<a href="#">2592650000</a>	Crimping tool for contacts	
GTIN (EAN)	4050118603774		
Qty.	1 ST		