

CMA-CTM-7-64-1A-0.5VA-1**Weidmüller Interface GmbH & Co. KG**Klingenbergstraße 26
D-32758 Detmold
Germany

www.weidmueller.com

Product image

similar to the product

The CMA-CTM 7 series mini current transformer is an inductive current transformer designed according to the transformer principle for circular primary conductors.

The CMA-CTM 7 series current transformers are maintenance-free and is designed for measuring primary currents in the range 32 A to 64 A. This is converted into a current up to 1 A on the secondary side.

With its small dimensions, it perfectly suits applications in a 3-phase circuit breaker with a phase separation of 17.5 mm.

General ordering data

Version	Primary current: 64 A, Secondary current max.: 1 A, Load: 0.5 VA, Tolerance class: 1, closed current transformer
Order No.	2556010000
Type	CMA-CTM-7-64-1A-0.5VA-1
GTIN (EAN)	4050118566079
Qty.	1 items
Manufacturer	MBS AG

CMA-CTM-7-64-1A-0.5VA-1

Weidmüller Interface GmbH & Co. KG
 Klingenbergstraße 26
 D-32758 Detmold
 Germany

www.weidmueller.com

Technical data

Approvals

ROHS	Conform
------	---------

Dimensions and weights

Depth	19 mm	Depth (inches)	0.748 inch
Height	46.5 mm	Height (inches)	1.8307 inch
Width	27.5 mm	Width (inches)	1.0827 inch
Net weight	65 g		

Temperatures

Storage temperature	-25 °C...70 °C	Operating temperature	-5 °C...50 °C
---------------------	----------------	-----------------------	---------------

Environmental Product Compliance

RoHS Compliance Status	Compliant
REACH SVHC	No SVHC above 0.1 wt%

Dimensions of live conductors

Type of conductor	Insulated conductor only	Round conductor	7.60 mm
Installation location	Indoor use		

Electrical attributes

Tolerance class	1	Secondary current	0...1 A
Load	0.5 VA	Primary current	64 A

Technical properties

Insulation class	E	Thermal rated continuous current I _{thermal}	1.0 x I _{rated}
Nominal frequency	50 Hz		

Insulation coordination

Standard	IEC 61869-1: 2007, IEC 61869-2: 2012	Tolerance class	1
----------	---	-----------------	---

Classifications

ETIM 6.0	EC002048	ETIM 7.0	EC002048
ETIM 8.0	EC002048	ETIM 9.0	EC002048
ETIM 10.0	EC002048	ECLASS 9.0	27-21-09-02
ECLASS 9.1	27-21-09-02	ECLASS 10.0	27-21-09-02
ECLASS 11.0	27-21-09-02	ECLASS 12.0	27-21-09-02
ECLASS 13.0	27-21-09-02	ECLASS 14.0	27-21-09-02
ECLASS 15.0	27-21-09-02		

CMA-CTM-7-64-1A-0.5VA-1

Weidmüller Interface GmbH & Co. KG
Klingenbergstraße 26
D-32758 Detmold
Germany

www.weidmueller.com

Drawings

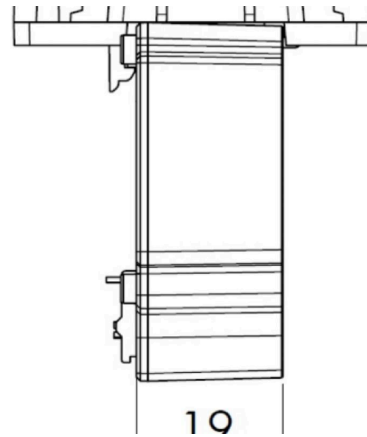
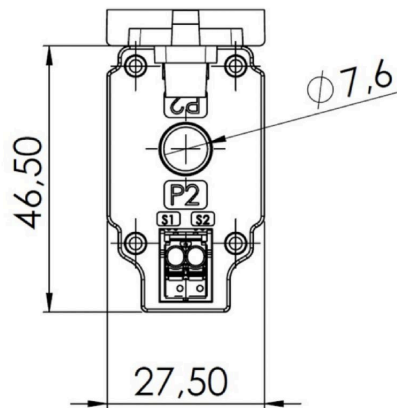

CMA-CTM-7-64-1A-0.5VA-1**Weidmüller Interface GmbH & Co. KG**Klingenbergstraße 26
D-32758 Detmold
Germanywww.weidmueller.com**Accessories****Mini current transformer**

The CMA-CTM 7 series mini current transformer is an inductive current transformer designed according to the transformer principle for circular primary conductors.

The CMA-CTM 7 series current transformers are maintenance-free and is designed for measuring primary currents in the range 32 A to 64 A. This is converted into a current up to 1 A on the secondary side.

With its small dimensions, it perfectly suits applications in a 3-phase circuit breaker with a phase separation of 17.5 mm.

General ordering data

Type	CMA-CTM-7-SNAP-ON	Version
Order No.	2525160000	
GTIN (EAN)	4050118536522	
Qty.	1 ST	