

## QL 2 WTL6/4FF

**Weidmüller Interface GmbH & Co. KG**

Klingenbergstraße 26  
D-32758 Detmold  
Germany

[www.weidmueller.com](http://www.weidmueller.com)

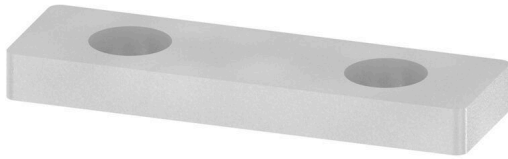

The distribution or multiplication of a potential to adjoining terminal blocks is realized via a cross-connection. Additional wiring effort can be easily avoided. Even if the poles are broken out, contact reliability in the terminal blocks is still ensured. Our portfolio offers pluggable and screwable cross-connection systems for modular terminal blocks.

### General ordering data

Version	Cross-connector (terminal), when screwed in, Silver grey, 41 A, Number of poles: 2, Pitch in mm (P): 11.00, Insulated: No, Width: 2 mm
Order No.	<a href="#">1897010000</a>
Type	QL 2 WTL6/4FF
GTIN (EAN)	40322485 1398 7
Qty.	100 items

## QL 2 WTL6/4FF

**Weidmüller Interface GmbH & Co. KG**  
 Klingenbergstraße 26  
 D-32758 Detmold  
 Germany

www.weidmueller.com

## Technical data

### Approvals

ROHS	Conform
------	---------

### Dimensions and weights

Depth	6 mm	Depth (inches)	0.2362 inch
Height	19.8 mm	Height (inches)	0.7795 inch
Width	2 mm	Width (inches)	0.0787 inch
Net weight	1.61 g		

### Temperatures

Storage temperature	-25 °C...55 °C	Ambient temperature	-5 °C...40 °C
---------------------	----------------	---------------------	---------------

### Environmental Product Compliance

RoHS Compliance Status	Compliant without exemption
REACH SVHC	No SVHC above 0.1 wt%

### Material data

Basic material	CuSn	Colour	Silver grey
----------------	------	--------	-------------

### System specifications

Version	Cross-connector
---------	-----------------

### Additional technical data

Type of fixing	when screwed in	Installation advice	Feed-through (bushing), Direct mounting
Explosion-tested version	No	Type of mounting	when screwed in

### Dimensions

Pitch in mm (P)	11.00 mm
-----------------	----------

### General

Number of poles	2	Installation advice	Feed-through (bushing), Direct mounting
-----------------	---	---------------------	--

### Rating data

Nominal current	41 A
-----------------	------

### Classifications

ETIM 8.0	EC000489	ETIM 9.0	EC000489
ETIM 10.0	EC000489	ECLASS 14.0	27-25-03-03
ECLASS 15.0	27-25-03-03		