

QL 2 WTL6/4FF

Weidmüller Interface GmbH & Co. KG

Klingenbergstraße 26

D-32758 Detmold

Germany

www.weidmueller.com

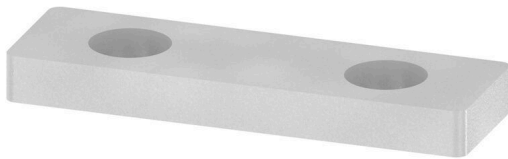

The distribution or multiplication of a potential to adjoining terminal blocks is realized via a cross-connection. Additional wiring effort can be easily avoided. Even if the poles are broken out, contact reliability in the terminal blocks is still ensured. Our portfolio offers pluggable and screwable cross-connection systems for modular terminal blocks.

General ordering data

| | |
|------------|--|
| Version | Cross-connector (terminal), when screwed in, Silver grey, 41 A, Number of poles: 2, Pitch in mm (P): 11.00, Insulated: No, Width: 2 mm |
| Order No. | 1897010000 |
| Type | QL 2 WTL6/4FF |
| GTIN (EAN) | 4032248513987 |
| Qty. | 100 items |

QL 2 WTL6/4FF

Weidmüller Interface GmbH & Co. KG
 Klingenbergstraße 26
 D-32758 Detmold
 Germany

www.weidmueller.com

Technical data

Approvals

| | |
|------|---------|
| ROHS | Conform |
|------|---------|

Dimensions and weights

| | | | |
|------------|---------|-----------------|-------------|
| Depth | 6 mm | Depth (inches) | 0.2362 inch |
| Height | 19.8 mm | Height (inches) | 0.7795 inch |
| Width | 2 mm | Width (inches) | 0.0787 inch |
| Net weight | 1.61 g | | |

Temperatures

| | | | |
|---------------------|----------------|---------------------|---------------|
| Storage temperature | -25 °C...55 °C | Ambient temperature | -5 °C...40 °C |
|---------------------|----------------|---------------------|---------------|

Environmental Product Compliance

| | |
|------------------------|-----------------------------|
| RoHS Compliance Status | Compliant without exemption |
| REACH SVHC | No SVHC above 0.1 wt% |

Material data

| | | | |
|----------------|------|--------|-------------|
| Basic material | CuSn | Colour | Silver grey |
|----------------|------|--------|-------------|

System specifications

| | |
|---------|-----------------|
| Version | Cross-connector |
|---------|-----------------|

Additional technical data

| | | | |
|--------------------------|-----------------|---------------------|--|
| Type of fixing | when screwed in | Installation advice | Feed-through (bushing), Direct mounting |
| Explosion-tested version | No | Type of mounting | when screwed in |

Dimensions

| | |
|-----------------|----------|
| Pitch in mm (P) | 11.00 mm |
|-----------------|----------|

General

| | | | |
|-----------------|---|---------------------|--|
| Number of poles | 2 | Installation advice | Feed-through (bushing), Direct mounting |
|-----------------|---|---------------------|--|

Rating data

| | |
|-----------------|------|
| Nominal current | 41 A |
|-----------------|------|

Classifications

| | | | |
|-------------|-------------|-------------|-------------|
| ETIM 8.0 | EC000489 | ETIM 9.0 | EC000489 |
| ETIM 10.0 | EC000489 | ECLASS 14.0 | 27-25-03-03 |
| ECLASS 15.0 | 27-25-03-03 | | |