

SAIB-VSA-4P/230/9-H/OB

Weidmüller Interface GmbH & Co. KG
 Klingenbergstraße 26
 D-32758 Detmold
 Germany

www.weidmueller.com

Similar to illustration



Individual cable lengths are often required nowadays. In order to meet these demands, Weidmüller offers a wide range of plug-in connectors for custom assembly. Customisable valve plugs are used frequently in special-purpose machine engineering. Such plugs are used to connect solenoid valves. The valve plugs are available in all standard design types. The range includes the design types A, B Industrial, B acc. to DIN, C Industrial and C acc. to DIN. The valve plugs are available in 3 and 4-pole versions without cables. A flat gasket seal is included which, when screwed on, guarantees IP 65 protection.

General ordering data

Version	Valve plug-in connector (field assembled), Number of poles: 4, Design A (18 mm), Without circuitry, 230 V, 0.34...1.5 mm ²
Order No.	1873140000
Type	SAIB-VSA-4P/230/9-H/OB
GTIN (EAN)	4032248492510
Qty.	1 items

Technical data

Approvals

Approvals



ROHS Conform

Dimensions and weights

Net weight 29 g

Environmental Product Compliance

RoHS Compliance Status Compliant without exemption

REACH SVHC No SVHC above 0.1 wt%

Technical data customisable plug-in connectors

Number of poles	4	Coding	Design A (18 mm)
Contact surface	CuSn	LED	No
Type of connection	Screw connection	Housing main material	PA 6 GF
Insulation resistance	108 Ω	Cable diameter, max.	7 mm
Cable diameter, min.	4.5 mm	Contact material	CuZn
Conductor cross-section, max.	1.5 mm ²	Conductor cross-section, min.	0.34 mm ²
Nominal voltage	230 V	Nominal current	10 A
Protection degree	IP65, IP67, when screwed in	Plugging cycles	≤ 50
Pollution severity	3	Cable gland	PG 9
Shield connection	No	All valve plugs are fitted with protective circuits	Without circuitry
Temperature range of housing	-30...+90 °C	Connection cross-section, max.	1.5 mm ²
Connection cross-section, min.	0.34 mm ²		

Classifications

ETIM 8.0	EC003623	ETIM 9.0	EC003623
ETIM 10.0	EC003623	ECLASS 14.0	27-44-01-05
ECLASS 15.0	27-44-01-05		

Dimensioned drawing

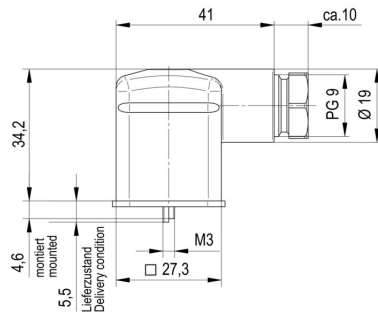

Pole scheme

