

SAIL-M12BW-4S50U**Weidmüller Interface GmbH & Co. KG**

Klingenbergstraße 26

D-32758 Detmold

Germany

www.weidmueller.com

Sensor/actuator cables are used for wiring sensors and actuators and for transmitting data or power in various applications. The moulded cable offers connected and tested connection of the plug-in connector to the cable ex-works. The cables may be exposed to a wide range of conditions, such as humidity, dust, heat, cold, shock or vibration.

Our developers have focused specifically on this issue and designed a host of different M8 and M12 sensor-actuator cables so you are bound to find the solution you need for your application.

Our sensor cables come with 360° shielding which provides protection against electromagnetic interference. Is there something you have not managed to find or you feel needs explanation? Talk to us!

General ordering data

| | |
|------------|--|
| Version | Sensor/actuator line, One end without connector, M12, Number of poles : 4, 50 m, Socket, angled, Shielded: Yes, LED: No, Sheath material: PUR, Halogen: No |
| Order No. | 1808975000 |
| Type | SAIL-M12BW-4S50U |
| GTIN (EAN) | 4050118516159 |
| Qty. | 1 items |

SAIL-M12BW-4S50U

Weidmüller Interface GmbH & Co. KG

Klingenbergstraße 26

D-32758 Detmold

Germany

www.weidmueller.com

Technical data

Approvals

Approvals



ROHS Conform

Dimensions and weights

Net weight 2012 g

Environmental Product Compliance

| | |
|--------------------------------------|--------------------------------------|
| RoHS Compliance Status | Compliant with exemption |
| RoHS Exemption (if applicable/known) | 6c |
| REACH SVHC | Lead 7439-92-1 |
| SCIP | 1c533b66-fcff-4da5-b89f-fd55fbf5cb55 |

Technical specifications for cable

| | | | |
|--|--|--------------------------------------|-----------------------|
| Cable length | 50 m | Sheathing colour | black |
| Resistance to oils | in accordance with IEC 60811:404 | Suitable for cable carriers | Yes |
| Core cross-section | 0.34 mm ² | Shielded | Yes |
| Halogen | No | Insulation | PP |
| Acceleration | 5 m/s ² | Bending radius, min., moving | 10 x cable diameter |
| Bending radius, min., stationary | 5 x cable diameter | Bending cycles | 2 Mio |
| Resistance to spread of flame | In accordance with UL1581 UL / CUL FT2, in accordance with IEC 60332-2-2 | Speed | 200 m/s |
| Sheath material | PUR | Configurable cable length | No |
| LABS-free | Yes | Hydrolysis and microbe resistant | Yes |
| Outer cladding in accordance with UL AWM style | 20549 (80 °C / 300 V) | Core in accordance with UL AWM style | 10493 (80 °C / 300 V) |
| Irradiation crosslinked | No | Welding spark resistance | No |
| Colour coding | black, brown, white, blue | Torsion resistance | 0 °/m |
| Temperature range, stationary | -40...80 °C | Resistant to welding beads | No |
| Temperature range, moving | -25...80 °C | Number of poles | 4 |
| Outside diameter | 5.4 mm ± 0.2 mm | | |

General technical data

| | | | |
|------------------------------|----------------|------------------------|---|
| Coding | A-coded | Connection thread | M12 |
| Contact surface | Gold-plated | LED | No |
| Version | Socket, angled | Housing main material | PUR |
| Insulation resistance | 108 Ω | Nominal voltage | 250 V |
| Nominal current | 4 A | Protection degree | IP65, IP66, IP67, IP68, when screwed in |
| Plugging cycles | ≥ 100 | Pollution severity | 3 |
| jumpered | No | Threaded ring material | Diecast zinc |
| Temperature range of housing | -25...+85 °C | Tightening torque | M12: 0.8 - 1.2 Nm |

Electrical properties

| | | | |
|-----------------------|-------|-----------------|-------|
| Insulation resistance | 108 Ω | Nominal voltage | 250 V |
|-----------------------|-------|-----------------|-------|

SAIL-M12BW-4S50U**Weidmüller Interface GmbH & Co. KG**

Klingenbergstraße 26

D-32758 Detmold

Germany

www.weidmueller.com**Technical data****Plug, left**

| | |
|-----------|---|
| Plug left | M12, A-coded, IP69, female contact, angled 90°, Plastic, shielded |
|-----------|---|

Plug, right

| | |
|------------|--------------------|
| Plug right | free conductor end |
|------------|--------------------|

Classifications

| | | | |
|-------------|-------------|-------------|-------------|
| ETIM 8.0 | EC001855 | ETIM 9.0 | EC001855 |
| ETIM 10.0 | EC001855 | ECLASS 14.0 | 27-06-03-11 |
| ECLASS 15.0 | 27-06-03-11 | | |

SAIL-M12BW-4S50U

Weidmüller Interface GmbH & Co. KG
Klingenbergstraße 26
D-32758 Detmold
Germany

www.weidmueller.com

Drawings

Dimensioned drawing

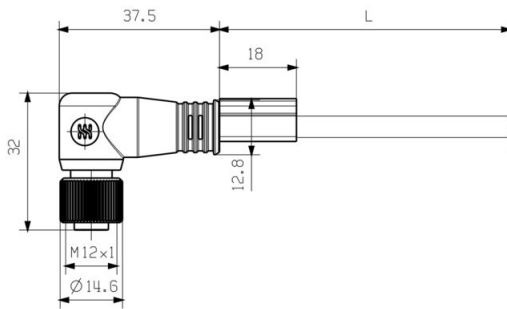

Pole scheme

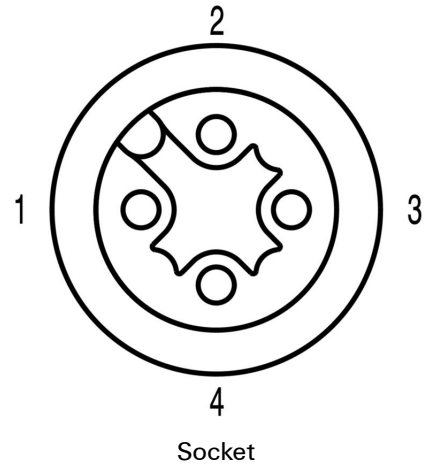

Wiring diagram

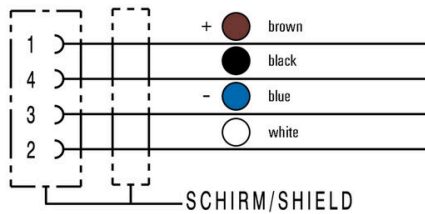

The ideal tool: Screwty® with torque function

Light, securely screwed-in round plug-in connectors. Screwty set DM / VPE: 1 / Order No.: 1920000000 Adapters: M12, M12 F, M8, M8 F

