

EM 8/30

Weidmüller Interface GmbH & Co. KG

Klingenbergstraße 26
D-32758 Detmold
Germany

www.weidmueller.com



System accessory

Discover a wide range of accessories for your u-remote system - the ideal addition to make your applications even more efficient and flexible.

General ordering data

| | |
|------------|--|
| Version | EM, Terminal marker, 32.4 x 7.2 mm, Pitch in mm (P): 7.20 Weidmueller, Transparent |
| Order No. | 1806120000 |
| Type | EM 8/30 |
| GTIN (EAN) | 4032248275298 |
| Qty. | 50 items |

Technical data

Approvals

| | |
|------|---------|
| ROHS | Conform |
|------|---------|

Dimensions and weights

| | | | |
|------------|---------|-----------------|-------------|
| Depth | 3 mm | Depth (inches) | 0.1181 inch |
| Height | 32.4 mm | Height (inches) | 1.2756 inch |
| Width | 7.2 mm | Width (inches) | 0.2835 inch |
| Net weight | 0.6 g | | |

Temperatures

| | |
|-----------------------------|-------------|
| Operating temperature range | -40...80 °C |
|-----------------------------|-------------|

Environmental Product Compliance

| | |
|------------------------|-----------------------------|
| RoHS Compliance Status | Compliant without exemption |
| REACH SVHC | No SVHC above 0.1 wt% |

General data

| | | |
|--------------------------------------|------------------------------------|----------------|
| Orientation of print | horizontal | |
| Width | 7.2 mm | |
| UL 94 flammability rating | HB | |
| Operating temperature range, max. | 80 °C | |
| Operating temperature range, min. | -40 °C | |
| Colour | Transparent | |
| Halogen | No | |
| Basic material | Polypropylene | |
| Printed characters | without | |
| Number of markers per packaging unit | Form of supply | Component part |
| Number of markers per combination | 1 Component part = Terminal marker | |
| Operating temperature range | -40...80 °C | |
| Application/manufacturer | Weidmueller | |

Connector markers

| | |
|-----------------|---------|
| Pitch in mm (P) | 7.20 mm |
|-----------------|---------|

Classifications

| | | | |
|-------------|-------------|-------------|-------------|
| ETIM 8.0 | EC000761 | ETIM 9.0 | EC000761 |
| ETIM 10.0 | EC000761 | ECLASS 14.0 | 27-28-11-01 |
| ECLASS 15.0 | 27-28-11-01 | | |

EM 8/30

Weidmüller Interface GmbH & Co. KG
 Klingenbergstraße 26
 D-32758 Detmold
 Germany

www.weidmueller.com

Accessories

Blank

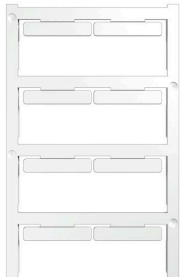

ELS MultiCard markers can be printed with a PrintJet, plotter or SMark printer. In particular, colour printing with PrintJet AVANCED allows the eye-catching identification marking of cables and terminal strips in many ways.

ELS 6/30 for use in the WKM 8/30 cable markers or in the EM8/30 group-tag carriers

ELS 7/40 for use in the SchT5S group-tag carriers

ELS 16/40 for use in the WKM 18/43 cable markers or the SchT5 group-tag carriers

For custom printing: Please send us a file of our labeling software M-Print PRO or M-Print PRO Online (without installation) for your labeling specifications.

General ordering data

| | | |
|------------|----------------------------|--|
| Type | ELS 6/30 MC NE WS | Version |
| Order No. | 1045570000 | ELS, Insert markers, 7 - 115 mm, 30 x 6 mm, white |
| GTIN (EAN) | 4032248779475 | |
| Qty. | 80 ST | |
| Type | ELS 6/30 MC NE GE | Version |
| Order No. | 1045580000 | ELS, Insert markers, 7 - 115 mm, 30 x 6 mm, yellow |
| GTIN (EAN) | 4032248779482 | |
| Qty. | 80 ST | |

ELS 6/30

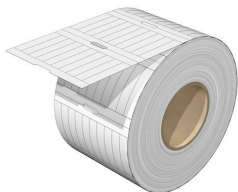

ELS

ELS tags are special and non-adhesive insertable labels for WKM cable markers or for group tag carriers. The matt, thin but tear-resistant polyester provides very good labelling and excellent readability. Used in combination with water-repellent WKM sleeves, the solution guarantees particularly long-lasting identification of cables even in harsh environments.

General ordering data

| | | |
|------------|----------------------------|--|
| Type | ELS 6/30 MM WS | Version |
| Order No. | 2009980000 | ELS, Insert markers, 7 - 115 mm, 30 x 6 mm, white |
| GTIN (EAN) | 4050118396850 | |
| Qty. | 3000 ST | |
| Type | ELS 6/30 MM GE | Version |
| Order No. | 2010620000 | ELS, Insert markers, 7 - 115 mm, 30 x 6 mm, yellow |
| GTIN (EAN) | 4050118397178 | |
| Qty. | 3000 ST | |

Accessories

ESO insert tags



General ordering data

| | | |
|------------|----------------------------|---|
| Type | ESO 7 DIN A4 WS | Version |
| Order No. | 1607720000 | Terminal markers, Insert markers, 30 x 6.3 mm, white |
| GTIN (EAN) | 4008190206116 | |
| Qty. | 10 ST | |
| Type | ESO 7 DIN A4 GE | Version |
| Order No. | 1634780000 | Terminal markers, Insert markers, 27 x 6.3 mm, yellow |
| GTIN (EAN) | 4008190273361 | |
| Qty. | 10 ST | |
| Type | ESO 7 P DIN A4 GE | Version |
| Order No. | 1670400000 | Terminal markers, Insert markers, 27 x 6.3 mm, yellow |
| GTIN (EAN) | 4008190430726 | |
| Qty. | 10 ST | |
| Type | ESO 7 P DIN A4 WS | Version |
| Order No. | 1670390000 | Terminal markers, Insert markers, 27 x 6.3 mm, white |
| GTIN (EAN) | 4008190430719 | |
| Qty. | 10 ST | |