

EM 8/30

Weidmüller Interface GmbH & Co. KG

Klingenbergstraße 26
D-32758 Detmold
Germany

www.weidmueller.com



System accessory

Discover a wide range of accessories for your u-remote system - the ideal addition to make your applications even more efficient and flexible.

General ordering data

Version	EM, Terminal marker, 32.4 x 7.2 mm, Pitch in mm (P): 7.20 Weidmueller, Transparent
Order No.	1806120000
Type	EM 8/30
GTIN (EAN)	4032248275298
Qty.	50 items

Technical data

Approvals

ROHS	Conform
------	---------

Dimensions and weights

Depth	3 mm	Depth (inches)	0.1181 inch
Height	32.4 mm	Height (inches)	1.2756 inch
Width	7.2 mm	Width (inches)	0.2835 inch
Net weight	0.6 g		

Temperatures

Operating temperature range	-40...80 °C
-----------------------------	-------------

Environmental Product Compliance

RoHS Compliance Status	Compliant without exemption
REACH SVHC	No SVHC above 0.1 wt%

General data

Orientation of print	horizontal	
Width	7.2 mm	
UL 94 flammability rating	HB	
Operating temperature range, max.	80 °C	
Operating temperature range, min.	-40 °C	
Colour	Transparent	
Halogen	No	
Basic material	Polypropylene	
Printed characters	without	
Number of markers per packaging unit	Form of supply	Component part
Number of markers per combination	1 Component part = Terminal marker	
Operating temperature range	-40...80 °C	
Application/manufacturer	Weidmueller	

Connector markers

Pitch in mm (P)	7.20 mm
-----------------	---------

Classifications

ETIM 8.0	EC000761	ETIM 9.0	EC000761
ETIM 10.0	EC000761	ECLASS 14.0	27-28-11-01
ECLASS 15.0	27-28-11-01		

EM 8/30

Weidmüller Interface GmbH & Co. KG
 Klingenbergstraße 26
 D-32758 Detmold
 Germany

www.weidmueller.com

Accessories

Blank

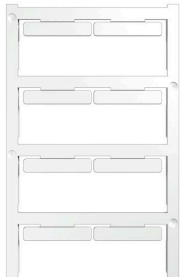

ELS MultiCard markers can be printed with a PrintJet, plotter or SMark printer. In particular, colour printing with PrintJet AVANCED allows the eye-catching identification marking of cables and terminal strips in many ways.

ELS 6/30 for use in the WKM 8/30 cable markers or in the EM8/30 group-tag carriers

ELS 7/40 for use in the SchT5S group-tag carriers

ELS 16/40 for use in the WKM 18/43 cable markers or the SchT5 group-tag carriers

For custom printing: Please send us a file of our labeling software M-Print PRO or M-Print PRO Online (without installation) for your labeling specifications.

General ordering data

Type	ELS 6/30 MC NE WS	Version
Order No.	1045570000	ELS, Insert markers, 7 - 115 mm, 30 x 6 mm, white
GTIN (EAN)	4032248779475	
Qty.	80 ST	
Type	ELS 6/30 MC NE GE	Version
Order No.	1045580000	ELS, Insert markers, 7 - 115 mm, 30 x 6 mm, yellow
GTIN (EAN)	4032248779482	
Qty.	80 ST	

ELS 6/30

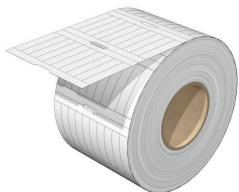

ELS

ELS tags are special and non-adhesive insertable labels for WKM cable markers or for group tag carriers. The matt, thin but tear-resistant polyester provides very good labelling and excellent readability. Used in combination with water-repellent WKM sleeves, the solution guarantees particularly long-lasting identification of cables even in harsh environments.

General ordering data

Type	ELS 6/30 MM WS	Version
Order No.	2009980000	ELS, Insert markers, 7 - 115 mm, 30 x 6 mm, white
GTIN (EAN)	4050118396850	
Qty.	3000 ST	
Type	ELS 6/30 MM GE	Version
Order No.	2010620000	ELS, Insert markers, 7 - 115 mm, 30 x 6 mm, yellow
GTIN (EAN)	4050118397178	
Qty.	3000 ST	

Accessories

ESO insert tags



General ordering data

Type	ESO 7 DIN A4 WS	Version
Order No.	1607720000	Terminal markers, Insert markers, 30 x 6.3 mm, white
GTIN (EAN)	4008190206116	
Qty.	10 ST	
Type	ESO 7 DIN A4 GE	Version
Order No.	1634780000	Terminal markers, Insert markers, 27 x 6.3 mm, yellow
GTIN (EAN)	4008190273361	
Qty.	10 ST	
Type	ESO 7 P DIN A4 GE	Version
Order No.	1670400000	Terminal markers, Insert markers, 27 x 6.3 mm, yellow
GTIN (EAN)	4008190430726	
Qty.	10 ST	
Type	ESO 7 P DIN A4 WS	Version
Order No.	1670390000	Terminal markers, Insert markers, 27 x 6.3 mm, white
GTIN (EAN)	4008190430719	
Qty.	10 ST	