

**HDC S6 12 BAS****Weidmüller Interface GmbH & Co. KG**

Klingenbergstraße 26

D-32758 Detmold

Germany

www.weidmueller.com



The MixMate series of connectors can simultaneously transmit high rated currents and voltages as well as signals. An axial screw can be used to secure the wire.  
Axial screw connection / TOP connection

**General ordering data**

Version	HDC insert, Female, 630 V, 48 A, Number of poles: 18, Axial screw connection, Installation size: 6
Order No.	<a href="#">1790010000</a>
Type	HDC S6 12 BAS
GTIN (EAN)	4032248212071
Qty.	1 items

**HDC S6 12 BAS**

**Weidmüller Interface GmbH & Co. KG**  
 Klingenbergstraße 26  
 D-32758 Detmold  
 Germany

www.weidmueller.com

**Technical data**

**Approvals**

Approvals



ROHS	Conform
UL File Number Search	<a href="#">UL Website</a>
Certificate No. (cURus)	E92202

**Dimensions and weights**

Depth	84.5 mm	Depth (inches)	3.3268 inch
Height	47.3 mm	Height (inches)	1.8622 inch
Width	34 mm	Width (inches)	1.3386 inch
Net weight	146.3 g		

**Temperatures**

Limit temperature	-40 °C ... 125 °C
-------------------	-------------------

**Environmental Product Compliance**

RoHS Compliance Status	Compliant with exemption
RoHS Exemption (if applicable/known)	6c
REACH SVHC	Lead 7439-92-1
SCIP	c4c4c9fc-7957-49de-b5fd-516c2623a8c3

Chemical resistance	Substance	Acetone
	Chemical resistance	Resistant
	Substance	Ammonia, watery
	Chemical resistance	Conditionally resistant
	Substance	Petrol
	Chemical resistance	Resistant
	Substance	Benzene
	Chemical resistance	Resistant
	Substance	Diesel oil
	Chemical resistance	Conditionally resistant
	Substance	Acetic acid, concentrated
	Chemical resistance	Resistant
	Substance	Potassium hydroxide
	Chemical resistance	Conditionally resistant
	Substance	Methanol
	Chemical resistance	Conditionally resistant
	Substance	Motor oil
	Chemical resistance	Conditionally resistant
	Substance	Lye, diluted
	Chemical resistance	Resistant
Substance	Hydrochlorofluorocarbons	
Chemical resistance	Conditionally resistant	
Substance	Outdoor use	
Chemical resistance	Conditionally resistant	

**Dimensions**

Width	34 mm	Total length base	84.5 mm
Height of socket	47.3 mm		

## HDC S6 12 BAS

Weidmüller Interface GmbH &amp; Co. KG

Klingenbergstraße 26

D-32758 Detmold

Germany

www.weidmueller.com

## Technical data

## General data

Number of poles	18	
Tightening torque	0.5 Nm	
Plugging cycles, silver	≥ 500	
Plugging cycles, gold	≥ 500	
Type of connection	Axial screw connection	
Installation size	6	
UL 94 flammability rating	V-0	
Volume resistance	≤2 mΩ	
Colour	beige	
Insulation resistance	1010 Ω	
Insulating material	PC glass-fibre reinforced (UL-listed and railway-certified)	
Insulating material group	IIIa	
Tightening torque, max. PE connection	2.5 Nm	
Surface finish	Silver passivated	
Type	Female	
Pollution severity	3	
Tightening torque, min. PE connection	2 Nm	
Basic material	Copper alloy	
Series	MixMate	
Rated voltage (DIN EN 61984)	630 V	
Rated voltage according to UL/CSA	600 V AC/DC	
Rated impulse voltage (DIN EN 61984)	8 kV	
Rated current (DIN EN 61984)	48 A	
Rated current (cUR)	Wire connection cross section AWG	AWG 14
	Rated current	8 A
Free from halogens	true	
Low smoke acc. DIN EN 45545-2	Yes	
BG	6	
Number of signal contacts	12	
Number of power contacts	6	

## Connection data PE

Connection type PE	Screw connection	Blade size, slotted (PE connection)	SD 0.8 x 4.0
Stripping length PE connection	8 mm	Tightening torque, max. PE connection	2.5 Nm
Tightening torque, min. PE connection	2 Nm	Fixing screw	M 5
Rated cross-section	10 mm <sup>2</sup>	Wire cross section, AWG (PE), min.	AWG 14
Wire cross section, AWG (PE), max.	AWG 8		

## Power contact

Type of connection, power contact	Axial screw connection
Number of poles, performance contact	6
Tightening torque, max.	0.9 Nm
Tightening torque, min.	0.45 Nm
Tightening torque, power contact, max.	1.7 Nm
Tightening torque, power contact, min.	1.1 Nm
Stripping length, performance contact	8 mm
Clamping range, power contact, max.	10 mm <sup>2</sup>
Clamping range, power contact, min.	2.5 mm <sup>2</sup>
Rated voltage (DIN EN 61984), power contact	690 V
Rated impulse voltage (DIN EN 61984), power contact	8 kV
Rated current (DIN EN 61984), power contact	48 A

## HDC S6 12 BAS

Weidmüller Interface GmbH &amp; Co. KG

Klingenbergstraße 26

D-32758 Detmold

Germany

www.weidmueller.com

## Technical data

Rated current power circuit (UR)	Wire connection cross section AWG	AWG 14
	Rated current	8 A
Hexagon socket	2 mm	

## Signal contact

Type of connection, signal	Screw connection	
Number of poles, signal	12	
AF size signal contact	SD 0.6 x 3.5	
Tightening torque, max.	0.9 Nm	
Tightening torque, min.	0.45 Nm	
Tightening torque, signal contact, max.	0.8 Nm	
Tightening torque, signal contact, min.	0.4 Nm	
Clamping range, signal contact, max.	2.5 mm <sup>2</sup>	
Clamping range, signal contact, min.	0.5 mm <sup>2</sup>	
Stripping length, signal	12 mm	
Rated voltage (DIN EN 61984), signal contact	400 V	
Rated impulse voltage (DIN EN 61984), signal	6 kV	
Rated current (DIN EN 61984), signal	16 A	
Rated current power circuit (UR)	Wire connection cross section AWG	AWG 14
	Rated current	8 A

## Version

Wire connection cross section AWG, max.	AWG 8	Stripping length, rated connection	8 mm
Type of connection	Axial screw connection	Installation size	6
Volume resistance	≤2 mΩ	Clamping screw	M 8 x 0.75 mm
Wire connection cross section AWG, min.	AWG 14	Wire cross-section, solid, max.	10 mm <sup>2</sup>
Wire cross-section, solid, min.	2.5 mm <sup>2</sup>	Wire connection cross-section, finely stranded with wire-end ferrules DIN 46228/4, max.	10 mm <sup>2</sup>
Wire connection cross-section, finely stranded with wire-end ferrules DIN 46228/4, min.	2.5 mm <sup>2</sup>	Wire connection cross section, finely stranded, max.	10 mm <sup>2</sup>
Wire connection cross section, finely stranded, min.	2.5 mm <sup>2</sup>	Conductor cross-section, max.	10 mm <sup>2</sup>
Conductor cross-section, min.	2.5 mm <sup>2</sup>	Surface finish	Silver passivated
Basic material	Copper alloy	BG	6

## Classifications

ETIM 8.0	EC000438	ETIM 9.0	EC000438
ETIM 10.0	EC000438	ECLASS 14.0	27-44-02-05
ECLASS 15.0	27-44-02-05		

Drawings

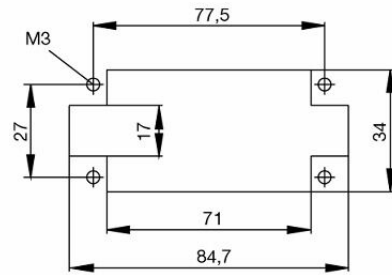
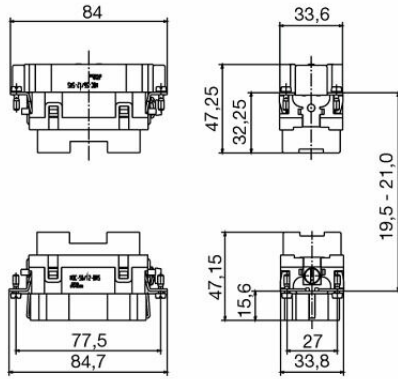

## HDC S6 12 BAS

**Weidmüller Interface GmbH & Co. KG**  
 Klingenbergstraße 26  
 D-32758 Detmold  
 Germany

www.weidmueller.com

## Accessories

### Socket wrench sets



Allen key made from fully hardened, high-alloy chromium-vanadium- steel, acc. to DIN ISO 2936 L (DIN 911), high-quality refined surface.

### General ordering data

Type	SK WSD-S 1,5-10,0	Version	
Order No.	<a href="#">9008850000</a>	Mounting tool	
GTIN (EAN)	4032248266609		
Qty.	1 ST		

### Slotted screwdriver



VDE insulated slot-head screwdriver, SDI DIN 7437, ISO 2380/2, drive output acc. to DIN 5264, ISO 2380/1. SoftFinish grip

### General ordering data

Type	SDIS 0.6X3.5X100	Version	
Order No.	<a href="#">9008390000</a>	Screwdriver, Screwdriver	
GTIN (EAN)	4032248056354		
Qty.	1 ST		
Type	SDS 0.6X3.5X100	Version	
Order No.	<a href="#">9008330000</a>	Screwdriver, Screwdriver	
GTIN (EAN)	4032248056286		
Qty.	1 ST		