

HDC S6 12 SAS

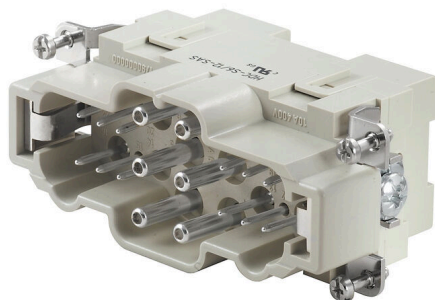

The MixMate series of connectors can simultaneously transmit high rated currents and voltages as well as signals. An axial screw can be used to secure the wire.
Axial screw connection / TOP connection

General ordering data

Version	HDC insert, Male, 690 V, 48 A, Number of poles: 18, Axial screw connection, Installation size: 6
Order No.	1790000000
Type	HDC S6 12 SAS
GTIN (EAN)	4032248212064
Qty.	1 items

HDC S6 12 SAS

Weidmüller Interface GmbH & Co. KG
 Klingenbergstraße 26
 D-32758 Detmold
 Germany

www.weidmueller.com

Technical data

Approvals

Approvals



ROHS	Conform
UL File Number Search	UL Website
Certificate No. (cURus)	E92202

Dimensions and weights

Depth	84.5 mm	Depth (inches)	3.3268 inch
Height	47.3 mm	Height (inches)	1.8622 inch
Width	34 mm	Width (inches)	1.3386 inch
Net weight	147 g		

Temperatures

Limit temperature	-40 °C ... 125 °C
-------------------	-------------------

Environmental Product Compliance

RoHS Compliance Status	Compliant with exemption
RoHS Exemption (if applicable/known)	6c
REACH SVHC	Lead 7439-92-1
SCIP	c4c4c9fc-7957-49de-b5fd-516c2623a8c3

Chemical resistance	Substance	Acetone
	Chemical resistance	Resistant
	Substance	Ammonia, watery
	Chemical resistance	Conditionally resistant
	Substance	Petrol
	Chemical resistance	Resistant
	Substance	Benzene
	Chemical resistance	Resistant
	Substance	Diesel oil
	Chemical resistance	Conditionally resistant
	Substance	Acetic acid, concentrated
	Chemical resistance	Resistant
	Substance	Potassium hydroxide
	Chemical resistance	Conditionally resistant
	Substance	Methanol
	Chemical resistance	Conditionally resistant
	Substance	Motor oil
	Chemical resistance	Conditionally resistant
	Substance	Lye, diluted
	Chemical resistance	Resistant
Substance	Hydrochlorofluorocarbons	
Chemical resistance	Conditionally resistant	
Substance	Outdoor use	
Chemical resistance	Conditionally resistant	

Dimensions

Width	34 mm	Total length base	84.5 mm
Height of plug	47.3 mm		

HDC S6 12 SAS

Weidmüller Interface GmbH & Co. KG

Klingenbergstraße 26

D-32758 Detmold

Germany

www.weidmueller.com

Technical data

General data

Number of poles	18	Tightening torque	0.5 Nm
Plugging cycles, silver	≥ 500	Type of connection	Axial screw connection
Installation size	6	UL 94 flammability rating	V-0
Volume resistance	≤2 mΩ	Colour	beige
Insulation resistance	1010 Ω	Insulating material	PC glass-fibre reinforced (UL-listed and railway-certified)
Insulating material group	IIIa	Tightening torque, max. PE connection	2.5 Nm
Surface finish	Silver passivated	Type	Male
Pollution severity	3	Tightening torque, min. PE connection	2 Nm
Basic material	Copper alloy	Series	MixMate
Rated voltage (DIN EN 61984)	690 V	Rated voltage according to UL/CSA	600 V AC/DC
Rated impulse voltage (DIN EN 61984)	8 kV	Rated current (DIN EN 61984)	48 A
Free from halogens	true	Low smoke acc. DIN EN 45545-2	Yes
BG	6	Number of signal contacts	12
Number of power contacts	6		

Connection data PE

Connection type PE	Screw connection	Blade size, slotted (PE connection)	SD 0.8 x 4.0
Stripping length PE connection	8 mm	Tightening torque, max. PE connection	2.5 Nm
Tightening torque, min. PE connection	2 Nm	Fixing screw	M 5
Rated cross-section	10 mm ²	Wire cross section, AWG (PE), min.	AWG 14
Wire cross section, AWG (PE), max.	AWG 8		

Power contact

Type of connection, power contact	Axial screw connection	Number of poles, performance contact	6
Tightening torque, max.	0.9 Nm	Tightening torque, min.	0.45 Nm
Tightening torque, power contact, max.	1.7 Nm	Tightening torque, power contact, min.	1.1 Nm
Stripping length, performance contact	8 mm	Clamping range, power contact, max.	10 mm ²
Clamping range, power contact, min.	2.5 mm ²	Rated voltage (DIN EN 61984), power contact	690 V
Rated impulse voltage (DIN EN 61984), power contact	8 kV	Rated current (DIN EN 61984), power contact	48 A
Hexagon socket	2 mm		

Signal contact

Type of connection, signal	Screw connection	Number of poles, signal	12
AF size signal contact	SD 0.6 x 3.5	Tightening torque, max.	0.9 Nm
Tightening torque, min.	0.45 Nm	Tightening torque, signal contact, max.	0.8 Nm
Tightening torque, signal contact, min.	0.4 Nm	Clamping range, signal contact, max.	2.5 mm ²
Clamping range, signal contact, min.	0.5 mm ²	Stripping length, signal	12 mm
Rated voltage (DIN EN 61984), signal contact	400 V	Rated impulse voltage (DIN EN 61984), 6 kV signal	
Rated current (DIN EN 61984), signal	16 A		

Version

Wire connection cross section AWG, max.	AWG 8	Stripping length, rated connection	8 mm
Type of connection	Axial screw connection	Installation size	6
Volume resistance	≤2 mΩ	Clamping screw	M 8 x 0.75 mm
Wire connection cross section AWG, min.	AWG 14	Wire cross-section, solid, max.	10 mm ²

HDC S6 12 SAS

Weidmüller Interface GmbH & Co. KG

Klingenbergstraße 26
D-32758 Detmold
Germany

www.weidmueller.com

Technical data

Wire cross-section, solid, min.	2.5 mm ²	Wire connection cross-section, finely stranded with wire-end ferrules DIN 46228/4, max.	10 mm ²
Wire connection cross-section, finely stranded with wire-end ferrules DIN 46228/4, min.	2.5 mm ²	Wire connection cross section, finely stranded, max.	10 mm ²
Wire connection cross section, finely stranded, min.	2.5 mm ²	Conductor cross-section, max.	10 mm ²
Conductor cross-section, min.	2.5 mm ²	Surface finish	Silver passivated
Basic material	Copper alloy	BG	6

Classifications

ETIM 8.0	EC000438	ETIM 9.0	EC000438
ETIM 10.0	EC000438	ECLASS 14.0	27-44-02-05
ECLASS 15.0	27-44-02-05		

Drawings

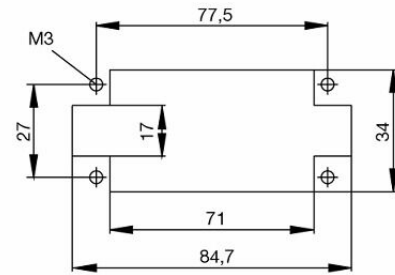
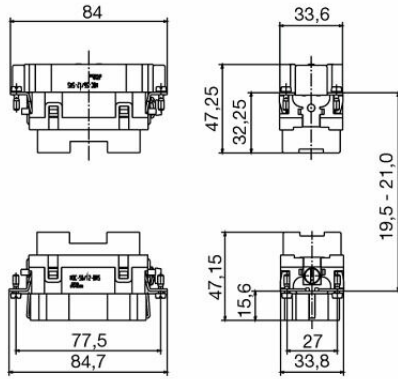

HDC S6 12 SAS

Weidmüller Interface GmbH & Co. KG
 Klingenbergstraße 26
 D-32758 Detmold
 Germany

www.weidmueller.com

Accessories

Socket wrench sets



Allen key made from fully hardened, high-alloy chromium-vanadium- steel, acc. to DIN ISO 2936 L (DIN 911), high-quality refined surface.

General ordering data

Type	SK WSD-S 1,5-10,0	Version	
Order No.	9008850000	Mounting tool	
GTIN (EAN)	4032248266609		
Qty.	1 ST		

Slotted screwdriver



VDE insulated slot-head screwdriver, SDI DIN 7437, ISO 2380/2, drive output acc. to DIN 5264, ISO 2380/1. SoftFinish grip

General ordering data

Type	SDIS 0.6X3.5X100	Version	
Order No.	9008390000	Screwdriver, Screwdriver	
GTIN (EAN)	4032248056354		
Qty.	1 ST		
Type	SDS 0.6X3.5X100	Version	
Order No.	9008330000	Screwdriver, Screwdriver	
GTIN (EAN)	4032248056286		
Qty.	1 ST		