

ZDK 2.5 BL**Weidmüller Interface GmbH & Co. KG**

Klingenbergstraße 26

D-32758 Detmold

Germany

www.weidmueller.com

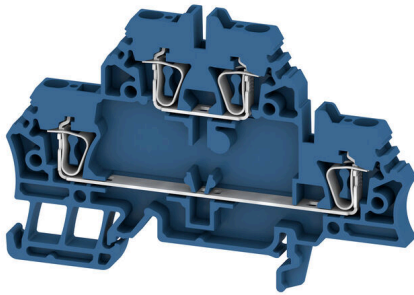
Product image

To feed through power, signal, and data is the classical requirement in electrical engineering and panel building. The insulating material, the connection system and the design of the terminal blocks are the differentiating features. A feed-through terminal block is suitable for joining and/or connecting one or more conductors. They could have one or more connection levels that are on the same potential or insulated against one another.

General ordering data

| | |
|------------|--|
| Version | Feed-through terminal, Double-tier terminal, Tension-clamp connection, 2.5 mm ² , 500 V, 20 A, blue |
| Order No. | 1678630000 |
| Type | ZDK 2.5 BL |
| GTIN (EAN) | 4008190465353 |
| Qty. | 50 items |

ZDK 2.5 BL

Weidmüller Interface GmbH & Co. KG
 Klingenbergstraße 26
 D-32758 Detmold
 Germany

www.weidmueller.com

Technical data

Approvals

Approvals



| | |
|-----------------------|----------------------------|
| ROHS | Conform |
| UL File Number Search | UL Website |
| Certificate No. (UR) | E60693 |

Dimensions and weights

| | | | |
|--------------------------|-------------|----------------|-------------|
| Depth | 53 mm | Depth (inches) | 2.0866 inch |
| Depth including DIN rail | 54 mm | Height | 79.5 mm |
| Height (inches) | 3.1299 inch | Width | 5.1 mm |
| Width (inches) | 0.2008 inch | Net weight | 9.8 g |

Temperatures

| | | | |
|----------------------------------|----------------|----------------------------------|----------------|
| Storage temperature | -25 °C...55 °C | Ambient temperature | -50 °C...75 °C |
| Continuous operating temp., min. | -50 °C | Continuous operating temp., max. | 120 °C |

Environmental Product Compliance

| | | | |
|--------------------------|-----------------------------|------------------|--|
| RoHS Compliance Status | Compliant without exemption | | |
| REACH SVHC | No SVHC above 0.1 wt% | | |
| Product Carbon Footprint | Cradle to gate | 0.090 kg CO2 eq. | |

Material data

| | | | |
|---------------------------|-------|--------|------|
| Basic material | Wemid | Colour | blue |
| UL 94 flammability rating | V-0 | | |

Rating data IECEX/ATEX

| | | | |
|--------------------------------|---------------------|---------------------------------|---------------------|
| Certificate No. (ATEX) | DEMKO16ATEX1729U | Certificate No. (IECEX) | IECEXULD16.0025U |
| Max. voltage (ATEX) | 440 V | Current (ATEX) | 20 A |
| Wire cross section max. (ATEX) | 2.5 mm ² | Max. voltage (IECEX) | 440 V |
| Current (IECEX) | 20 A | Wire cross section max. (IECEX) | 2.5 mm ² |
| Marking EN 60079-7 | Ex eb II C Gb | Ex 2014/34/EU label | II 2 G D |

System specifications

| | | | |
|-------------------------------------|--|-----------------------------------|-------|
| Version | Tension-clamp connection, for plug-in cross-connector, One end without connector | End cover plate required | Yes |
| Number of potentials | 2 | Number of levels | 2 |
| Number of clamping points per level | 2 | Levels cross-connected internally | No |
| PE connection | No | Mounting rail | TS 35 |

ZDK 2.5 BL

Weidmüller Interface GmbH & Co. KG
 Klingenbergstraße 26
 D-32758 Detmold
 Germany

www.weidmueller.com

Technical data

Additional technical data

| | | | |
|---------------------|---------|-----------------------------|-----|
| Open sides | right | Number of similar terminals | 1 |
| Installation advice | Busbar | Explosion-tested version | Yes |
| Type of mounting | Snap-on | | |

CSA rating data

| | | | |
|--|-----------------|--|--------|
| Conductor size Factory wiring min. (CSA) | 26 AWG | Conductor size Field wiring max. (CSA) | 12 AWG |
| Certificate No. (CSA) | 80053378-200039 | Conductor size Factory wiring max. (CSA) | 12 AWG |
| Conductor size Field wiring min. (CSA) | 26 AWG | | |

Conductors for clamping (additional connection)

| | |
|--|--------------------------|
| Connection type, additional connection | Tension-clamp connection |
|--|--------------------------|

Conductors for clamping (rated connection)

| | | | |
|---|--------------------------|---|--------------------------|
| Gauge to IEC 60947-1 | A2 | Wire connection cross section AWG, max. | AWG 14 |
| Connection direction | top | Stripping length | 10 mm |
| Type of connection 2 | Tension-clamp connection | Type of connection | Tension-clamp connection |
| Number of connections | 4 | Clamping range, max. | 2.5 mm ² |
| Clamping range, min. | 0.05 mm ² | Blade size | 0.6 x 3.5 mm |
| Wire connection cross section AWG, min. | AWG 24 | Wire connection cross-section, finely stranded with wire-end ferrules DIN 46228/4, max. | 2.5 mm ² |
| Wire connection cross-section, finely stranded with wire-end ferrules DIN 46228/4, min. | 0.05 mm ² | Wire connection cross-section, finely stranded with wire-end ferrules DIN 46228/1, max. | 2.5 mm ² |
| Wire connection cross-section, finely stranded with wire-end ferrules DIN 46228/1, min. | 0.05 mm ² | Wire connection cross section, finely stranded, max. | 2.5 mm ² |
| Wire connection cross section, finely stranded, min. | 0.05 mm ² | Connection cross-section, stranded, max. | 2.5 mm ² |
| Connection cross-section, stranded, min. | 0.05 mm ² | Wire connection cross-section, solid core, max. | 2.5 mm ² |
| Wire connection cross-section, solid core, min. | 0.05 mm ² | Connection cross-section, finely stranded, min. | 0.05 mm ² |

General

| | | | |
|---|--------|---------------------|---------------|
| Wire connection cross section AWG, max. | AWG 14 | Installation advice | Busbar |
| Wire connection cross section AWG, min. | AWG 24 | Standards | IEC 60947-7-1 |
| Mounting rail | TS 35 | | |

Rating data

| | | | |
|--|---------------------|---------------------------------|---------------|
| Rated cross-section | 2.5 mm ² | Rated voltage | 500 V |
| Rated DC voltage | 500 V | Nominal current | 20 A |
| Current at maximum wires | 20 A | Standards | IEC 60947-7-1 |
| Volume resistance according to IEC 60947-7-x | 1.33 mΩ | Rated impulse withstand voltage | 6 kV |
| Power loss in accordance with IEC 60947-7-x | 0.77 W | Pollution severity | 3 |

ZDK 2.5 BL**Weidmüller Interface GmbH & Co. KG**Klingenbergstraße 26
D-32758 Detmold
Germanywww.weidmueller.com**Technical data****UL rating data**

| | | | |
|---|--------|---|--------|
| Conductor size Factory wiring max. (UR) | 14 AWG | Current size C (UR) | 15 A |
| Voltage size C (UR) | 300 V | Conductor size Factory wiring min. (UR) | 26 AWG |
| Certificate No. (UR) | E60693 | Conductor size Field wiring min. (UR) | 26 AWG |
| Conductor size Field wiring max. (UR) | 14 AWG | | |

Classifications

| | | | |
|-------------|-------------|-------------|-------------|
| ETIM 8.0 | EC000897 | ETIM 9.0 | EC000897 |
| ETIM 10.0 | EC000897 | ECLASS 14.0 | 27-25-01-02 |
| ECLASS 15.0 | 27-25-01-02 | | |

Drawings

