

**HDC 40D SDLU 1PG29G****Weidmüller Interface GmbH & Co. KG**

Klingenbergstraße 26

D-32758 Detmold

Germany

[www.weidmueller.com](http://www.weidmueller.com)

The special die-cast alloy and the multi-layered surface sealing provide complete protection for the HDC housings.

The cleverly designed interlock system is manufactured from stainless steel. This guarantees a long lifespan with high resistance to corrosion and impact.

The housing interlock system provides integrated safety. Our unique, patented spring system provides the housing interlock with a secure grip and prevents accidental opening.

The laser marking allows for easy and quick identification. Each housing is permanently labelled with a laser marking so that each product can be quickly designated and positioned.

Weidmüller RockStar® IP 65 / NEMA Type 4X housings - your first choice for industrial housings with IP 65 protection.

**General ordering data**

Version	HDC enclosures, Installation size: 6, Protection degree: IP65, in plugged condition, Base housing, End-locking clamp, lower side, high, with cover, Size of cable entries: PG 29
Order No.	<a href="#">1658410000</a>
Type	HDC 40D SDLU 1PG29G
GTIN (EAN)	4008190411459
Qty.	1 items

## HDC 40D SDLU 1PG29G

Weidmüller Interface GmbH &amp; Co. KG

Klingenbergstraße 26

D-32758 Detmold

Germany

www.weidmueller.com

## Technical data

## Approvals

Approvals



ROHS Conform

UL File Number Search [UL Website](#)

Certificate No. (cURus) E92202

## Dimensions and weights

Height	102 mm	Height (inches)	4.0157 inch
Width	99.5 mm	Width (inches)	3.9173 inch
Mounting dimension - height	45 mm	Mounting dimension - width	105 mm
Net weight	528 g		

## Temperatures

Limit temperature -40 °C ... 125 °C

## Environmental Product Compliance

RoHS Compliance Status	Compliant without exemption
REACH SVHC	Potassium perfluorobutane sulfonate 29420-49-3
SCIP	e98b2b24-ba23-41bf-8d19-0dda3647412f

Chemical resistance	Substance	Acetone
	Chemical resistance	Conditionally resistant
	Substance	Drilling oil
	Chemical resistance	Resistant
	Substance	Diesel
	Chemical resistance	Resistant
	Substance	Ethyl alcohol
	Chemical resistance	Resistant
	Substance	Transmission oil
	Chemical resistance	Resistant
	Substance	Hydraulic oil
	Chemical resistance	Resistant
	Substance	Coolant
	Chemical resistance	Resistant
	Substance	Petroleum benzine
	Chemical resistance	Resistant
	Substance	Sweat
	Chemical resistance	Resistant
	Substance	Premium gasoline
	Chemical resistance	Conditionally resistant
	Substance	Water
	Chemical resistance	Resistant
	Substance	UV
	Chemical resistance	Unstable
	Substance	Ozone
	Chemical resistance	Unstable

## Dimensions

Hole pitch length A2	105 mm	Cable entry	w. thread
Width housing C	43 mm	Width base C1	56.5 mm

## HDC 40D SDLU 1PG29G

Weidmüller Interface GmbH &amp; Co. KG

Klingenbergstraße 26

D-32758 Detmold

Germany

www.weidmueller.com

## Technical data

Total length housing	93.3 mm	Height of housing B	102 mm
Height of base B1	5 mm		

## General data

Housing main material	diecast aluminium	Surface finish	Powder coating
Protection degree	IP65, in plugged condition	Protection class note	Protection class with secured cover: IP 65
EMC housings	No	Material of locking element	Stainless steel, rust-proof

## Version

Size of cable entries	PG 29	Top part/bottom part/lid	lower part
Cover	with cover	Number of cable entry on top	0
Number of cable entry sideways	1	Design of cover	with cover
Design of housing	Base housing	Design of locking system	End-locking clamp, lower side
Design	high	Installation size	6
Cable entry	w. thread	Type	Base housing
Clamp version	End-locking clamp	Sealing	NBR
Internal thread	PG 29	Colour (RAL)	RAL 7035
BG	6	Suitable for ModuPlug®	Yes

## Classifications

ETIM 6.0	EC000437	ETIM 7.0	EC000437
ETIM 8.0	EC000437	ETIM 9.0	EC000437
ETIM 10.0	EC000437	ECLASS 9.0	27-44-02-02
ECLASS 9.1	27-44-02-02	ECLASS 10.0	27-44-02-02
ECLASS 11.0	27-44-02-02	ECLASS 12.0	27-44-02-02
ECLASS 13.0	27-44-02-02	ECLASS 14.0	27-44-02-02
ECLASS 15.0	27-44-02-02		

## HDC 40D SDLU 1PG29G

**Weidmüller Interface GmbH & Co. KG**  
Klingenbergstraße 26  
D-32758 Detmold  
Germany

[www.weidmueller.com](http://www.weidmueller.com)

## Drawings

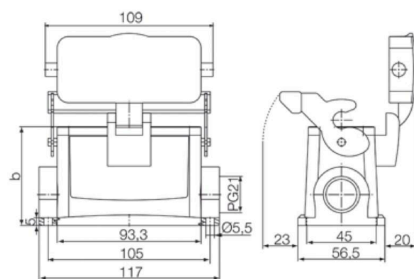

## HDC 40D SDLU 1PG29G

**Weidmüller Interface GmbH & Co. KG**  
 Klingenbergstraße 26  
 D-32758 Detmold  
 Germany

www.weidmueller.com

## Accessories

## Hood, Cable Entry at top



The special die-cast alloy and the multi-layered surface sealing provide complete protection for the HDC housings.

The cleverly designed interlock system is manufactured from stainless steel. This guarantees a long lifespan with high resistance to corrosion and impact.

The housing interlock system provides integrated safety. Our unique, patented spring system provides the housing interlock with a secure grip and prevents accidental opening.

The laser marking allows for easy and quick identification. Each housing is permanently labelled with a laser marking so that each product can be quickly designated and positioned.

Weidmüller RockStar® IP 65 / NEMA Type 4X housings - your first choice for industrial housings with IP 65 protection.

## General ordering data

Type	HDC 40D TOLU 1M40G	Version
Order No.	<a href="#">1139680000</a>	HDC enclosures, Installation size: 6, Protection degree: IP65, in
GTIN (EAN)	4032248959792	plugged condition, Cable entry from top, Plug housing, End-locking
Qty.	1 ST	clamp, lower side, high, Size of cable entries: M 40
Type	HDC 16B TOLU 1PG21G	Version
Order No.	<a href="#">1657960000</a>	HDC enclosures, Installation size: 6, Protection degree: IP65, in
GTIN (EAN)	4008190411015	plugged condition, Cable entry from top, Plug housing, End-locking
Qty.	1 ST	clamp, lower side, Standard, Size of cable entries: PG 21
Type	HDC 40D TOLU 1PG29G	Version
Order No.	<a href="#">1658020000</a>	HDC enclosures, Installation size: 6, Protection degree: IP65, in
GTIN (EAN)	4008190411077	plugged condition, Cable entry from top, Plug housing, End-locking
Qty.	1 ST	clamp, lower side, high, Size of cable entries: PG 29
Type	HDC 40D TOLU 1M32G	Version
Order No.	<a href="#">1787100000</a>	HDC enclosures, Installation size: 6, Protection degree: IP65, in
GTIN (EAN)	4032248204441	plugged condition, Cable entry from top, Plug housing, End-locking
Qty.	1 ST	clamp, lower side, high, Size of cable entries: M 32
Type	HDC 16B TOLU 1M25G	Version
Order No.	<a href="#">1788230000</a>	HDC enclosures, Installation size: 6, Protection degree: IP65, in
GTIN (EAN)	4032248205769	plugged condition, Cable entry from top, Plug housing, End-locking
Qty.	1 ST	clamp, lower side, Standard, Size of cable entries: M 25
Type	HDC 16B TOLU 1M32G	Version
Order No.	<a href="#">1804630000</a>	HDC enclosures, Installation size: 6, Protection degree: IP65, in
GTIN (EAN)	4032248267552	plugged condition, Cable entry from top, Plug housing, End-locking
Qty.	1 ST	clamp, lower side, Standard, Size of cable entries: M 32

## HDC 40D SDLU 1PG29G

Weidmüller Interface GmbH &amp; Co. KG

Klingenbergstraße 26

D-32758 Detmold

Germany

www.weidmueller.com

## Accessories

## Hood, Cable Entry sideways



The special die-cast alloy and the multi-layered surface sealing provide complete protection for the HDC housings.

The cleverly designed interlock system is manufactured from stainless steel. This guarantees a long lifespan with high resistance to corrosion and impact.

The housing interlock system provides integrated safety. Our unique, patented spring system provides the housing interlock with a secure grip and prevents accidental opening.

The laser marking allows for easy and quick identification. Each housing is permanently labelled with a laser marking so that each product can be quickly designated and positioned.

Weidmüller RockStar® IP 65 / NEMA Type 4X housings - your first choice for industrial housings with IP 65 protection.

## General ordering data

Type	HDC 16B TSLU 1PG21G	Version
Order No.	<a href="#">1657850000</a>	HDC enclosures, Installation size: 6, Protection degree: IP65, in
GTIN (EAN)	4008190410902	plugged condition, Cable entry from side, Plug housing, End-locking
Qty.	1 ST	clamp, lower side, Standard, Size of cable entries: PG 21
Type	HDC 40D TSLU 1PG21G	Version
Order No.	<a href="#">1657890000</a>	HDC enclosures, Installation size: 6, Protection degree: IP65, in
GTIN (EAN)	4008190410933	plugged condition, Cable entry from side, Plug housing, End-locking
Qty.	1 ST	clamp, lower side, high, Size of cable entries: PG 21
Type	HDC 40D TSLU 1PG29G	Version
Order No.	<a href="#">1657910000</a>	HDC enclosures, Installation size: 6, Protection degree: IP65, in
GTIN (EAN)	4008190410964	plugged condition, Cable entry from side, Plug housing, End-locking
Qty.	1 ST	clamp, lower side, high, Size of cable entries: PG 29
Type	HDC 40D TSLU 1M32G	Version
Order No.	<a href="#">1787040000</a>	HDC enclosures, Installation size: 6, Protection degree: IP65, in
GTIN (EAN)	4032248204281	plugged condition, Cable entry from side, Plug housing, End-locking
Qty.	1 ST	clamp, lower side, high, Size of cable entries: M 32
Type	HDC 40D TSLU 1M25G	Version
Order No.	<a href="#">1787050000</a>	HDC enclosures, Installation size: 6, Protection degree: IP65, in
GTIN (EAN)	4032248204298	plugged condition, Cable entry from side, Plug housing, End-locking
Qty.	1 ST	clamp, lower side, high, Size of cable entries: M 25
Type	HDC 16B TSLU 1M25G	Version
Order No.	<a href="#">1788200000</a>	HDC enclosures, Installation size: 6, Protection degree: IP65, in
GTIN (EAN)	4032248205738	plugged condition, Cable entry from side, Plug housing, End-locking
Qty.	1 ST	clamp, lower side, Standard, Size of cable entries: M 25
Type	HDC 16B TSLU 1M32G	Version
Order No.	<a href="#">1804640000</a>	HDC enclosures, Installation size: 6, Protection degree: IP65, in
GTIN (EAN)	4032248267569	plugged condition, Cable entry from side, Plug housing, End-locking
Qty.	1 ST	clamp, lower side, Standard, Size of cable entries: M 32
Type	HDC 40D TSLU 1M40G	Version
Order No.	<a href="#">1804650000</a>	HDC enclosures, Installation size: 6, Protection degree: IP65, in
GTIN (EAN)	4032248267576	plugged condition, Cable entry from side, Plug housing, End-locking
Qty.	1 ST	clamp, lower side, high, Size of cable entries: M 40