

CLI C 2-4 BL/WS - CD

Weidmüller Interface GmbH & Co. KG
 Klingenbergstraße 26
 D-32758 Detmold
 Germany

www.weidmueller.com

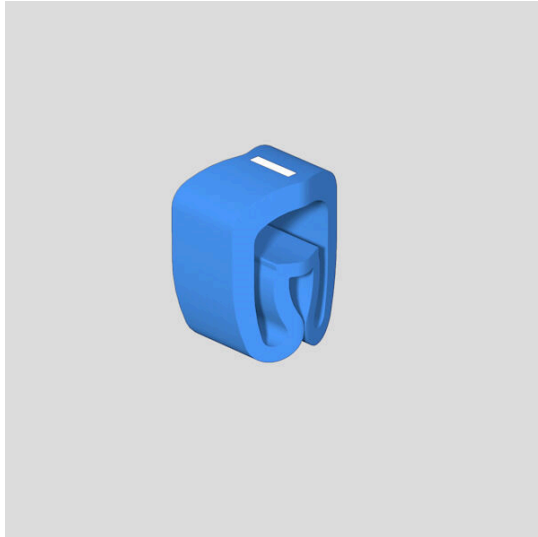

CLI C conductor markers are mounted on unconnected conductors. Four different sizes are available for labelling conductor cross-sections from 0.5 mm² to max. 70 mm². The markers are already printed and ready for use. Individual labelling is possible by combining the individual markers.

- Closed markers, reliable and for mounting on unconnected cables
- A special flexible bellow profile ensures a wide application range
- Fast and easy to fit – with minimal effort
- Corresponding accessories make labelling easy
- Permanent, high-quality labelling
- High contrast for optimum legibility

General ordering data

Version	CableLine, Conductor and cable markers, 4 - 10 mm, 4 x 7 mm, blue
Order No.	1568261741
Type	CLI C 2-4 BL/WS - CD
GTIN (EAN)	4008190032777
Qty.	250 items

CLI C 2-4 BL/WS - CD

Weidmüller Interface GmbH & Co. KG
 Klingenbergstraße 26
 D-32758 Detmold
 Germany

www.weidmueller.com

Technical data

Approvals

ROHS Conform

Dimensions and weights

Depth	8 mm	Depth (inches)	0.315 inch
Height	4 mm	Height (inches)	0.1575 inch
Width	7 mm	Width (inches)	0.2756 inch
Net weight	0.21 g		

Temperatures

Operating temperature range -30...80 °C

Environmental Product Compliance

RoHS Compliance Status Compliant without exemption
 REACH SVHC No SVHC above 0.1 wt%

General data

Material colour according to resistance code	6		
Orientation of print	horizontal		
Type of printing	Standard		
Printing method	hot-embossing		
Version	CD		
Width	7 mm		
UL 94 flammability rating	V-0		
Operating temperature range, max.	80 °C		
Operating temperature range, min.	-30 °C		
Colour	blue		
Halogen	Yes		
Insulation cross-section, max.	10		
Basic material	PVC, soft, without Cadmium		
Colour of printing	white		
Printed characters	Symbols		
Number of markers per packaging unit	Form of supply	Reel	
Recommended industries	Process, Machinery		
Number of markers per combination	1 Reel = Conductor and cable markers		
Operating temperature range	-30...80 °C		
Imprint	-		

Conductor and cable markers

Halogen	Yes	Conductor cross-section, max.	16 mm ²
Conductor cross-section, min.	2.5 mm ²	Conductor O.D., max.	10 mm
Conductor O.D., min.	4 mm	Conductor O.D.	4 - 10 mm
Cross-section for connected wire	2.5 - 16 mm ²		

Classifications

ETIM 8.0	EC001530	ETIM 9.0	EC001530
ETIM 10.0	EC001530	ECLASS 14.0	27-28-11-02
ECLASS 15.0	27-28-11-02		