

ACT20C-LBT-10**Weidmüller Interface GmbH & Co. KG**

Klingenbergstraße 26

D-32758 Detmold

Germany

www.weidmueller.com



The ACT20C series was especially developed for applications with continuous processes. It enables the continuous monitoring of diagnostic, device and process information ("condition monitoring").

Several ACT20C components form a station which consists of an ACT20C Ethernet gateway, communicative ACT20C signal converters and an ACT20C bus termination terminal.

General ordering data

Version	Bus termination terminal for ACT20C station, Input : 0...40/50/60 A, Output : Pulse
Order No.	1510340000
Type	ACT20C-LBT-10
GTIN (EAN)	4050118319491
Qty.	1 items

ACT20C-LBT-10

Weidmüller Interface GmbH & Co. KG

Klingenbergstraße 26

D-32758 Detmold

Germany

www.weidmueller.com

Technical data

Approvals

Approvals



ROHS Conform

UL File Number Search [UL Website](#)

Certificate no. (cULus) E141197

Dimensions and weights

Depth	63 mm	Depth (inches)	2.4803 inch
Height	56 mm	Height (inches)	2.2047 inch
Width	20.6 mm	Width (inches)	0.811 inch
Net weight	53.88 g		

Temperatures

Storage temperature	-40 °C...85 °C	Operating temperature	
Humidity	5...95 %, no condensation		

Probability of failure

SIL in compliance with IEC 61508	None	MTTF	120 a
----------------------------------	------	------	-------

Environmental Product Compliance

RoHS Compliance Status	Compliant with exemption
RoHS Exemption (if applicable/known)	7a, 7cl
REACH SVHC	Lead 7439-92-1
SCIP	2f6dd957-421a-46db-a0c2-cf1609156924

Output

Load impedance current	≤ 600 Ω
------------------------	---------

alarm output

Switching current	5 A
-------------------	-----

General data

Protection degree	IP20	Mounting rail	TS 35
Nominal power consumption	3 VA	Configuration	none
Suitable application	Profibus PA		

Connection data

Type of connection	socket / socket
--------------------	-----------------

Part description

Product description	<p>The ACT20C-LBT-10 bus termination terminal is required as the electrical termination of the DIN rail bus on an ACT20C station. It also assumes the function of a mechanical end bracket.</p> <p>Properties</p> <ul style="list-style-type: none"> Right-hand electrical termination of the internal communication bus on an ACT20C station
---------------------	--

Technical data

- Assembly on a TS 35 DIN rail with integrated CH20M bus profile
- Integrated mechanical end bracket function

Classifications

ETIM 8.0	EC001583	ETIM 9.0	EC001583
ETIM 10.0	EC001583	ECLASS 14.0	27-14-31-92
ECLASS 15.0	27-14-31-92		

ACT20C-LBT-10

Weidmüller Interface GmbH & Co. KG
Klingenbergstraße 26
D-32758 Detmold
Germany

Drawings

www.weidmueller.com

Dimensioned drawing

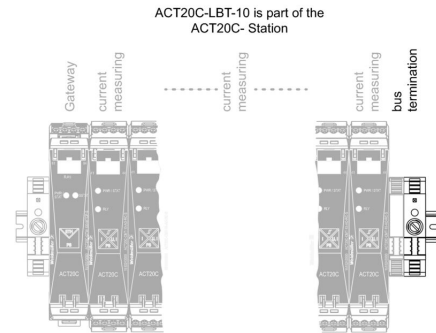
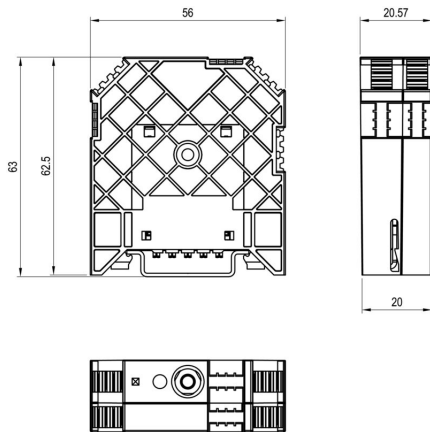

ACT20C-LBT-10

Weidmüller Interface GmbH & Co. KG

Klingenbergstraße 26

D-32758 Detmold

Germany

www.weidmueller.com

Accessories

Blank



WS markers are the perfect match for the W-series connectors. Thanks to their system compatibility, the WS tags can also be used with the I-series and the Z-series. The large marking surfaces do not only permit long character strings but also multi-line text. WS markers are ideal for labels with long, customised character strings. Thanks to the proven MultiCard format, printing with PrintJet CONNECT oder/or Plotter is possible.

- Can be fitted in strips or individually
- Markers in proven MultiCard format

For custom printing: Please send us a file of our labeling software M-Print PRO or M-Print PRO Online (without installation) for your labeling specifications.

General ordering data

Type	WS 12/5 MC NE WS	Version
Order No.	1609860000	WS, Terminal marker, 12 x 5 mm, Pitch in mm (P): 5.00 Weidmueller,
GTIN (EAN)	4008190203481	Allen-Bradley, white
Qty.	720 ST	

ACT20 (incl. DIN rail bus & powersupplies)



Power supply adapter modules for separate supply and distribution of the supply voltage: for the ACT20 series/MICROSERIES signal converters.

The 22.5/6.1 mm wide power-feed modules are mounted directly adjacent to the analogue signal converters. Then the 24 VDC supply voltage is optionally bridged via the CH20M (ACT20-series) rail bus or simply bridged over using the pluggable ZQV 4N (MICROSERIES) cross-connectors.

The ACT20-Feed-In-PRO-S can also detect faults coming from any of the devices mounted on the CH20 bus mounting profile.

In the event of an error or fault, the integrated status relay sends a common alarm to the external controller. In addition, two power supply units (as primary and backup supply) can be connected to the ACT20 Feed-In PRO-S. Two feed-in modules mounted to the CH20 bus mounting profile guarantee a 100% redundant power supply. Three LEDs are used to show the status of the power supply and error messages.

The ACT20M-Feed-In PRO can also be used in Ex zone2 / Division2 applications.

General ordering data

Type	SAMPLE CH20M BUS 250MM	Version
Order No.	1335140000	Mounting rail bus system, Sample set, OMNIMATE Housing - series
GTIN (EAN)	4050118138375	CH20M, Width: 25.1 mm
Qty.	1 ST	

CH20M BUS-AP - Bus insert profil endplates



The integrated rail bus for the modular electronics housing system

When supplying, connecting or distributing within modular applications, the rail bus can replace the tedious individual wiring process with a flexible and uninterrupted system-wide solution.

The system bus is securely integrated within the 35-mm standard mounting rail. The SMD-bus contact block can be reflow-soldered so that it can be completely automatically processed during the component assembly. The resistant, gold-plated contact surfaces ensure a permanent and reliable contact for all housing widths.

- **Unlimited scalability** The integrated connection solution covers all system widths: from the 6-mm slice to the 67-mm large-area housing.
- **Easy to service during installation** It's easy to replace a module, even in existing modules groups – without any influence on the neighbouring modules.
- **Universal integration** The uninterrupted system bus is securely integrated within the 35-mm standard mounting rail.
- **Maximum availability** Five fully-galvanized and partially gold-plated twin-arched contacts are used to establish a permanent contact to the rail bus. THR solder flanges ensure that the connection to the circuit board is stable.

General ordering data

Type	CH20M BUS-AP LI TS 35X7...	Version
Order No.	1193160000	Mounting rail bus system, End plate, OMNIMATE Housing - series
GTIN (EAN)	4032248987771	CH20M, Width: 5.1 mm
Qty.	50 ST	
Type	CH20M BUS-AP RE TS 35X7...	Version
Order No.	1193170000	Mounting rail bus system, End plate, OMNIMATE Housing - series
GTIN (EAN)	4032248987924	CH20M, Width: 5.1 mm
Qty.	50 ST	