

**KQN-M6/-10****Weidmüller Interface GmbH & Co. KG**

Klingenbergstraße 26

D-32758 Detmold

Germany

www.weidmueller.com

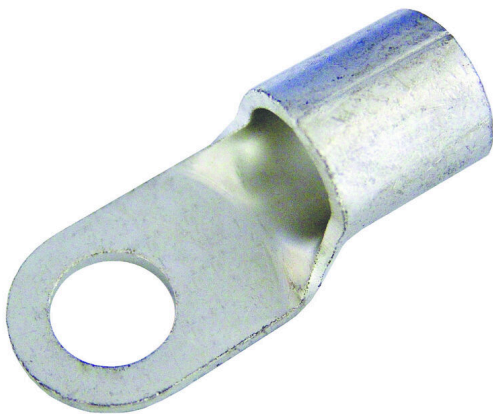

The use of insulated connectors guarantees users consistent electrical connection quality in the long term.

- Wide range of insulated and non-insulated cable lugs and connectors
- Tubular cable lugs according to current market standards (Euroseries)
- Compression cable lugs acc. to DIN 46235
- Sheet metal cable lugs acc. to DIN 46234
- Insulated ring cable lugs to DIN 46237
- Insulated pin cable lugs to DIN 46231

**General ordering data**

Version	cable lug, terminal end, 10 mm <sup>2</sup>
Order No.	<a href="#">1494030000</a>
Type	KQN-M6/-10
GTIN (EAN)	4050118303483
Qty.	100 items

## KQN-M6/-10

**Weidmüller Interface GmbH & Co. KG**  
 Klingenbergstraße 26  
 D-32758 Detmold  
 Germany

[www.weidmueller.com](http://www.weidmueller.com)

## Technical data

### Approvals

ROHS	Conform
------	---------

### Dimensions and weights

Net weight	2.07 g
------------	--------

### Environmental Product Compliance

RoHS Compliance Status	Compliant without exemption
REACH SVHC	No SVHC above 0.1 wt%

### Connectors

Conductor cross-section	10 mm <sup>2</sup>	Insulation	not available
Hole	M 6	Inside diameter of shaft (d1)	4.5 mm
Outside diameter of shaft (d3)	11 mm	Shaft length (a)	8 mm
Connection length (l)	17 mm	Inside diameter of flange (d2)	6.5 mm

### Classifications

ETIM 8.0	EC001059	ETIM 9.0	EC001059
ETIM 10.0	EC001059	ECLASS 14.0	27-40-02-12
ECLASS 15.0	27-40-02-12		

Drawings

