

KQN-M10/-2,5**Weidmüller Interface GmbH & Co. KG**Klingenbergstraße 26
D-32758 Detmold
Germany

www.weidmueller.com

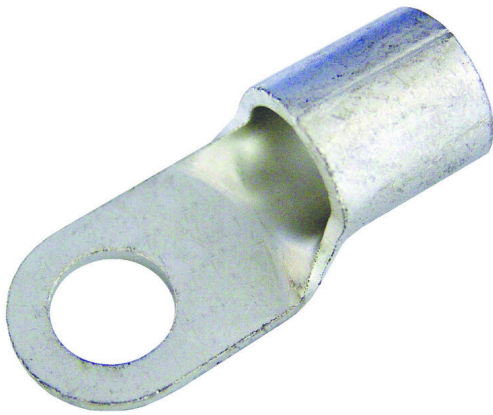

The use of insulated connectors guarantees users consistent electrical connection quality in the long term.

- Wide range of insulated and non-insulated cable lugs and connectors
- Tubular cable lugs according to current market standards (Euroseries)
- Compression cable lugs acc. to DIN 46235
- Sheet metal cable lugs acc. to DIN 46234
- Insulated ring cable lugs to DIN 46237
- Insulated pin cable lugs to DIN 46231

General ordering data

Version	cable lug, terminal end, 1,5 mm ² - 2,5 mm ²
Order No.	1493930000
Type	KQN-M10/-2,5
GTIN (EAN)	4050118303841
Qty.	100 items

Technical data

Approvals

ROHS	Conform
------	---------

Dimensions and weights

Net weight	1.67 g
------------	--------

Environmental Product Compliance

RoHS Compliance Status	Compliant without exemption
REACH SVHC	No SVHC above 0.1 wt%

Connectors

Conductor cross-section, max.	2.5 mm ²	Conductor cross-section, min.	1.5 mm ²
Insulation	not available	Hole	M10
Inside diameter of shaft (d1)	2.3 mm	Outside diameter of shaft (d3)	18 mm
Shaft length (a)	5 mm	Connection length (l)	20 mm
Inside diameter of flange (d2)	10.5 mm		

Classifications

ETIM 8.0	EC001059	ETIM 9.0	EC001059
ETIM 10.0	EC001059	ECLASS 14.0	27-40-02-12
ECLASS 15.0	27-40-02-12		

Drawings

