

KQN-M2/-1**Weidmüller Interface GmbH & Co. KG**

Klingenbergstraße 26

D-32758 Detmold

Germany

www.weidmueller.com

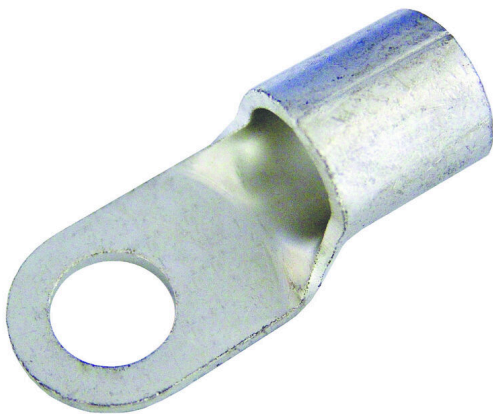

The use of insulated connectors guarantees users consistent electrical connection quality in the long term.

- Wide range of insulated and non-insulated cable lugs and connectors
- Tubular cable lugs according to current market standards (Euroseries)
- Compression cable lugs acc. to DIN 46235
- Sheet metal cable lugs acc. to DIN 46234
- Insulated ring cable lugs to DIN 46237
- Insulated pin cable lugs to DIN 46231

General ordering data

Version	cable lug, terminal end, 1 mm ² , 0.5 mm ² - 1 mm ²
Order No.	1493720000
Type	KQN-M2/-1
GTIN (EAN)	4050118303612
Qty.	100 items

KQN-M2/-1

Weidmüller Interface GmbH & Co. KG
 Klingenbergstraße 26
 D-32758 Detmold
 Germany

www.weidmueller.com

Technical data

Approvals

ROHS	Conform
------	---------

Dimensions and weights

Net weight	0.6 g
------------	-------

Environmental Product Compliance

RoHS Compliance Status	Compliant without exemption
REACH SVHC	No SVHC above 0.1 wt%

Connectors

Conductor cross-section, max.	1 mm ²	Conductor cross-section, min.	0.5 mm ²
Conductor cross-section	1 mm ²	Insulation	not available
Hole	M 2	Inside diameter of shaft (d1)	1.6 mm
Outside diameter of shaft (d3)	6 mm	Shaft length (a)	5 mm
Connection length (l)	11 mm	Inside diameter of flange (d2)	2.2 mm

Classifications

ETIM 8.0	EC001059	ETIM 9.0	EC001059
ETIM 10.0	EC001059	ECLASS 14.0	27-40-02-12
ECLASS 15.0	27-40-02-12		

Drawings

