

**KQN-M12/-120****Weidmüller Interface GmbH & Co. KG**Klingenbergstraße 26  
D-32758 Detmold  
Germany

www.weidmueller.com

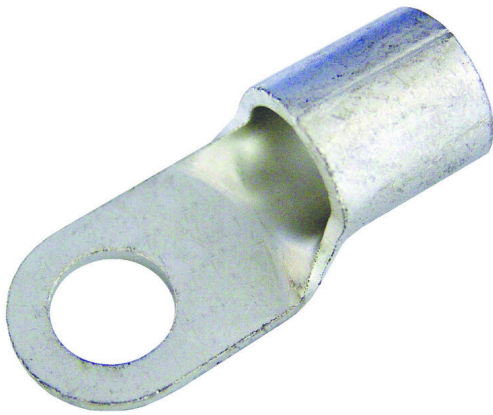

The use of insulated connectors guarantees users consistent electrical connection quality in the long term.

- Wide range of insulated and non-insulated cable lugs and connectors
- Tubular cable lugs according to current market standards (Euroseries)
- Compression cable lugs acc. to DIN 46235
- Sheet metal cable lugs acc. to DIN 46234
- Insulated ring cable lugs to DIN 46237
- Insulated pin cable lugs to DIN 46231

**General ordering data**

Version	cable lug, terminal end, 120 mm <sup>2</sup>
Order No.	<a href="#">1493340000</a>
Type	KQN-M12/-120
GTIN (EAN)	4050118302998
Qty.	25 items

## KQN-M12/-120

**Weidmüller Interface GmbH & Co. KG**  
 Klingenbergstraße 26  
 D-32758 Detmold  
 Germany

[www.weidmueller.com](http://www.weidmueller.com)

## Technical data

### Approvals

ROHS	Conform
------	---------

### Dimensions and weights

Net weight	46.6 g
------------	--------

### Environmental Product Compliance

RoHS Compliance Status	Compliant without exemption
REACH SVHC	No SVHC above 0.1 wt%

### Connectors

Conductor cross-section	120 mm <sup>2</sup>	Insulation	not available
Hole	M 12	Inside diameter of shaft (d1)	16.5 mm
Outside diameter of shaft (d3)	24 mm	Shaft length (a)	22 mm
Connection length (l)	44 mm	Inside diameter of flange (d2)	13 mm

### Classifications

ETIM 8.0	EC001059	ETIM 9.0	EC001059
ETIM 10.0	EC001059	ECLASS 14.0	27-40-02-12
ECLASS 15.0	27-40-02-12		

Drawings

