

KQN-M20/-95**Weidmüller Interface GmbH & Co. KG**Klingenbergstraße 26
D-32758 Detmold
Germany

www.weidmueller.com

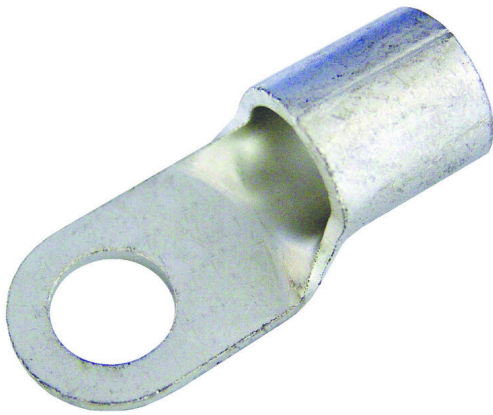

The use of insulated connectors guarantees users consistent electrical connection quality in the long term.

- Wide range of insulated and non-insulated cable lugs and connectors
- Tubular cable lugs according to current market standards (Euroseries)
- Compression cable lugs acc. to DIN 46235
- Sheet metal cable lugs acc. to DIN 46234
- Insulated ring cable lugs to DIN 46237
- Insulated pin cable lugs to DIN 46231

General ordering data

Version	cable lug, terminal end,95 mm ²
Order No.	1493310000
Type	KQN-M20/-95
GTIN (EAN)	4050118303407
Qty.	25 items
Delivery status	This article will no longer be available in the future.

Technical data

Approvals

ROHS	Conform
------	---------

Dimensions and weights

Net weight	42.5 g
------------	--------

Environmental Product Compliance

RoHS Compliance Status	Compliant without exemption
REACH SVHC	No SVHC above 0.1 wt%

Connectors

Conductor cross-section	95 mm ²	Insulation	not available
Hole	M 20	Inside diameter of shaft (d1)	15 mm
Outside diameter of shaft (d3)	32 mm	Shaft length (a)	20 mm
Connection length (l)	51.8 mm	Inside diameter of flange (d2)	21 mm

Classifications

ETIM 8.0	EC001059	ETIM 9.0	EC001059
ETIM 10.0	EC001059	ECLASS 14.0	27-40-02-12
ECLASS 15.0	27-40-02-12		

Drawings



KQN-M20/-95

Weidmüller Interface GmbH & Co. KG

Klingenbergstraße 26

D-32758 Detmold

Germany

www.weidmueller.com

Accessories

Tools



Crimping tools for cable lugs, connectors and wire-end ferrules with interchangeable inserts

- extremely fast processing thanks to hydraulic support
- large processing range up to 300 mm²
- 270° revolving quick-action crimping head
- automatic pressure limitation and monitoring via pressure sensor
- electronic control and monitoring of the crimping process
- Saving of all crimping cycles and error messages to internal memory
- Reading of all cycles and error messages via USB
- Li-ion rechargeable battery with charge status indicator: 18 V, 2 Ah

General ordering data

Type	EPG 60	Version	
Order No.	2453810000	Pressing tools, Tools, Pressing tool, 6mm ² , 300mm ² , Hexagonal	
GTIN (EAN)	4050118468434	crimp, WM crimp, Indent crimp, Trapezoidal crimp, Oval crimping	
Qty.	1 ST		

... for tubular cable lugs



Crimping tools for cable lugs, connectors and wire-end ferrules with interchangeable inserts

- extremely fast processing thanks to hydraulic support
- large processing range up to 300 mm²
- 270° revolving quick-action crimping head
- automatic pressure limitation and monitoring via pressure sensor
- electronic control and monitoring of the crimping process
- Saving of all crimping cycles and error messages to internal memory
- Reading of all cycles and error messages via USB
- Li-ion rechargeable battery with charge status indicator: 18 V, 2 Ah

General ordering data

Type	ES EPG/HPG 60 WM 95	Version	
Order No.	2469600000	Crimping tool insert, 95mm ² , WM crimp	
GTIN (EAN)	4050118483895		
Qty.	1 ST		

Accessories

... for compression cable lugs



- Crimping tools for cable lugs, connectors and wire-end ferrules with interchangeable inserts
- extremely fast processing thanks to hydraulic support
 - large processing range up to 300 mm²
 - 270° revolving quick-action crimping head
 - automatic pressure limitation and monitoring via pressure sensor
 - electronic control and monitoring of the crimping process
 - Saving of all crimping cycles and error messages to internal memory
 - Reading of all cycles and error messages via USB
 - Li-ion rechargeable battery with charge status indicator: 18 V, 2 Ah

General ordering data

Type	ES EPG/HPG 60 HEX 95	Version	
Order No.	2505220000	Version	Crimping tool insert, 95mm ² , Hexagonal crimp
GTIN (EAN)	4050118519563		
Qty.	1 ST		

Tools



- Crimping tools for cable lugs, connectors and wire-end ferrules with interchangeable inserts
- extremely fast processing thanks to hydraulic support
 - large processing range up to 400 mm²
 - 360° revolving quick action crimping head
 - automatic pressure limitation and monitoring via pressure sensor
 - Additional features for APG series:
 - electronic control and monitoring of the crimping process
 - Saving of all crimping cycles and error messages to internal memory
 - Reading of all cycles and error messages via USB

General ordering data

Type	HPG 60	Version	
Order No.	2453820000	Version	6mm ² , 300mm ² , Hexagonal crimp, WM crimp, Indent crimp,
GTIN (EAN)	4050118468427	Version	Trapezoidal crimp, Oval crimping
Qty.	1 ST		

KQN-M20/-95

Weidmüller Interface GmbH & Co. KG

Klingenbergstraße 26

D-32758 Detmold

Germany

www.weidmueller.com

Accessories

... for tubular cable lugs (acc. to EN 13600)



Crimping tools for cable lugs, connectors and wire-end ferrules with interchangeable inserts

- extremely fast processing thanks to hydraulic support
- large processing range up to 400 mm²
- 360° revolving quick action crimping head
- automatic pressure limitation and monitoring via pressure sensor
- Additional features for APG series:
 - electronic control and monitoring of the crimping process
 - Saving of all crimping cycles and error messages to internal memory
 - Reading of all cycles and error messages via USB

General ordering data

Type	ES APG 80 WM 95	Version	
Order No.	1502530000	95mm ² , WM crimp	
GTIN (EAN)	4050118310566		
Qty.	1 ST		

... for compression cable lugs (acc. to DIN 46235)



Crimping tools for cable lugs, connectors and wire-end ferrules with interchangeable inserts

- extremely fast processing thanks to hydraulic support
- large processing range up to 400 mm²
- 360° revolving quick action crimping head
- automatic pressure limitation and monitoring via pressure sensor
- Additional features for APG series:
 - electronic control and monitoring of the crimping process
 - Saving of all crimping cycles and error messages to internal memory
 - Reading of all cycles and error messages via USB

General ordering data

Type	ES APG 80 HEX 95	Version	
Order No.	1502690000	95mm ² , Hexagonal crimp	
GTIN (EAN)	4050118310610		
Qty.	1 ST		