

**SSR 10-32VDC/0-35VDC 5A****Weidmüller Interface GmbH & Co. KG**

Klingenbergstraße 26

D-32758 Detmold

Germany

[www.weidmueller.com](http://www.weidmueller.com)

Individual relays for TERMSERIES

- Solid-state relays
- Different output versions

**General ordering data**

Version	TERMSERIES, Solid-state relay, Rated control voltage: 10...32 V DC , Rated switching voltage: 0...35 V DC, Continuous current: 5 A, Plug-in connection
Order No.	<a href="#">1421450000</a>
Type	SSR 10-32VDC/0-35VDC 5A
GTIN (EAN)	4050118235302
Qty.	20 items

## SSR 10-32VDC/0-35VDC 5A

**Weidmüller Interface GmbH & Co. KG**  
 Klingenbergstraße 26  
 D-32758 Detmold  
 Germany

www.weidmueller.com

## Technical data

## Approvals

ROHS	Conform
------	---------

## Dimensions and weights

Depth	15.7 mm	Depth (inches)	0.6181 inch
Height	29 mm	Height (inches)	1.1417 inch
Width	12.7 mm	Width (inches)	0.5 inch
Net weight	9.87 g		

## Temperatures

Storage temperature	-40 °C...100 °C	Ambient temperature	-20 °C...80 °C
Operating temperature			

## Probability of failure

MTTF	1099 a
------	--------

## Environmental Product Compliance

RoHS Compliance Status	Compliant
REACH SVHC	No SVHC above 0.1 wt%

## Control side

Rated control voltage	10...32 V DC	Nominal control current	3...13 mA
Status indicator	No		

## Load side

Rated switching voltage	0...35 V DC	Continuous current	5 A
Rated switching current	5 A	Switch-on delay	<55 µs
Switch-off delay	<310 µs	Voltage drop at max. load	≤ 0.3 V
Leakage current	<20 µA	Min. switching current	1 mA
Protective circuit, load side	Free-wheeling diode	Contact type	1 NO contact (MOS-FET)

## General data

Colour	black
--------	-------

## Insulation coordination

Dielectric strength for control side - load side	2.5 kVeff	Impulse withstand voltage	2.5 kV
--	-----------	---------------------------	--------

## Connection data

Wire connection method	Plug-in connection	Pitch in mm (P)	5.00 mm
------------------------	--------------------	-----------------	---------

## Classifications

ETIM 6.0	EC001504	ETIM 7.0	EC001504
ETIM 8.0	EC001504	ETIM 9.0	EC001504
ETIM 10.0	EC001504	ECLASS 9.0	27-37-16-04
ECLASS 9.1	27-37-16-04	ECLASS 10.0	27-37-16-04

## SSR 10-32VDC/0-35VDC 5A

**Weidmüller Interface GmbH & Co. KG**  
Klingenbergstraße 26  
D-32758 Detmold  
Germany

[www.weidmueller.com](http://www.weidmueller.com)

## Technical data

ECLASS 11.0	27-37-16-04	ECLASS 12.0	27-37-16-04
ECLASS 13.0	27-37-16-04	ECLASS 14.0	27-37-16-04
ECLASS 15.0	27-37-16-04		

## SSR 10-32VDC/0-35VDC 5A

**Weidmüller Interface GmbH & Co. KG**  
Klingenbergstraße 26  
D-32758 Detmold  
Germany

[www.weidmueller.com](http://www.weidmueller.com)

## Drawings

### Wiring diagram

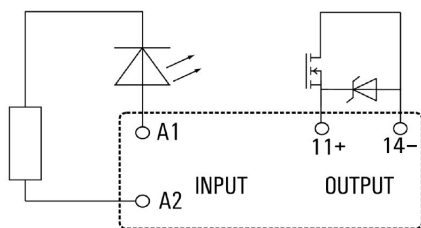

View of pins from below

### Dimensional drawing

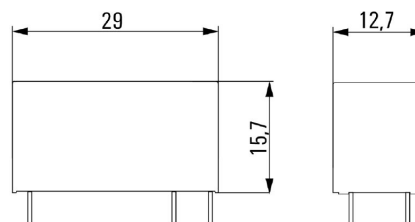

## SSR 10-32VDC/0-35VDC 5A

Weidmüller Interface GmbH &amp; Co. KG

Klingenbergstraße 26

D-32758 Detmold

Germany

www.weidmueller.com

## Counterpart

## Screw connection

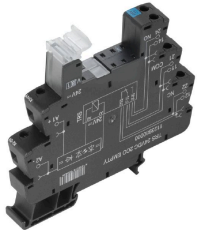

TERMSERIES empty sockets with:

- 1 CO contact
- Unique multi-voltage input from 24 to 230 V UC
- Input voltages from 5 V DC to 230 V UC with coloured marking: AC: red, DC: blue, UC: white
- Due to high-quality design and no sharp edges no risk of injuries during installation
- Partition plates for optical separation and reinforcement of insulation

## General ordering data

Type	TOS 24VDC EMPTY	Version
Order No.	<a href="#">1127720000</a>	TERMSERIES, Relay socket, Rated control voltage: 24 V DC $\pm 20\%$ ,
GTIN (EAN)	4032248909377	Rated switching voltage: 230 V AC, Continuous current: 16 A, Screw
Qty.	10 ST	connection

## Tension clamp connection

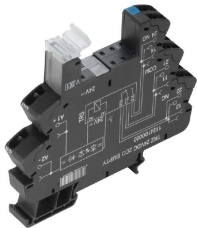

TERMSERIES empty sockets with:

- 1 CO contact
- Unique multi-voltage input from 24 to 230 V UC
- Input voltages from 5 V DC to 230 V UC with coloured marking: AC: red, DC: blue, UC: white
- Due to high-quality design and no sharp edges no risk of injuries during installation
- Partition plates for optical separation and reinforcement of insulation

## General ordering data

Type	TOZ 24VDC EMPTY	Version
Order No.	<a href="#">1127740000</a>	TERMSERIES, Relay socket, Rated control voltage: 24 V DC $\pm 20\%$ ,
GTIN (EAN)	4032248909421	Rated switching voltage: 230 V AC, Continuous current: 16 A,
Qty.	10 ST	Tension-clamp connection

## Screw connection

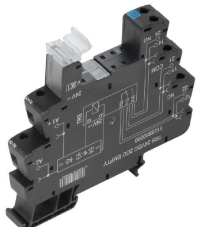

TERMSERIES empty sockets with:

- 1 CO contact
- Unique multi-voltage input from 24 to 230 V UC
- Input voltages from 5 V DC to 230 V UC with coloured marking: AC: red, DC: blue, UC: white
- Due to high-quality design and no sharp edges no risk of injuries during installation
- Partition plates for optical separation and reinforcement of insulation

## General ordering data

Type	TOS 24-230VUC EMPTY	Version
Order No.	<a href="#">1127730000</a>	TERMSERIES, Relay socket, Rated control voltage: 24...230 V UC $\pm 10\%$
GTIN (EAN)	4032248909254	Rated switching voltage: 230 V AC, Continuous current: 16 A,
Qty.	10 ST	Screw connection

## SSR 10-32VDC/0-35VDC 5A

**Weidmüller Interface GmbH & Co. KG**  
 Klingenbergstraße 26  
 D-32758 Detmold  
 Germany

www.weidmueller.com

## Counterpart

## Tension clamp connection

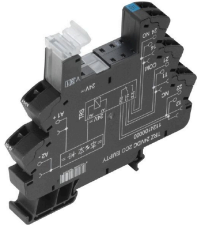

TERMSERIES empty sockets with:

- 1 CO contact
- Unique multi-voltage input from 24 to 230 V UC
- Input voltages from 5 V DC to 230 V UC with coloured marking: AC: red, DC: blue, UC: white
- Due to high-quality design and no sharp edges no risk of injuries during installation
- Partition plates for optical separation and reinforcement of insulation

## General ordering data

Type	TOZ 24-230VUC EMPTY	Version
Order No.	<a href="#">1127750000</a>	TERMSERIES, Relay socket, Rated control voltage: 24...230 V UC ±10
GTIN (EAN)	4032248909223	% , Rated switching voltage: 230 V AC, Continuous current: 16 A,
Qty.	10 ST	Tension-clamp connection

## PUSH IN connection

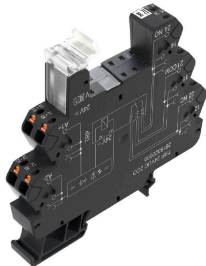

TERMSERIES empty sockets with:

- 1 CO contact
- Unique multi-voltage input from 24 to 230 V UC
- Input voltages from 5 V DC to 230 V UC with coloured marking: AC: red, DC: blue, UC: white
- Due to high-quality design and no sharp edges no risk of injuries during installation
- Partition plates for optical separation and reinforcement of insulation

## General ordering data

Type	TOP 24VDC EMPTY	Version
Order No.	<a href="#">2618740000</a>	TERMSERIES, Relay socket, Rated control voltage: 24 V DC ±20 % ,
GTIN (EAN)	4050118670097	Rated switching voltage: 230 V AC, Continuous current: 16 A, PUSH
Qty.	10 ST	IN
Type	TOP 24-230VUC EMPTY ED2	Version
Order No.	<a href="#">2663110000</a>	TERMSERIES, Relay socket, Rated control voltage: 24...230 V UC ±10
GTIN (EAN)	4050118697964	% , Rated switching voltage: 250 V AC, Continuous current: 16 A,
Qty.	10 ST	PUSH IN

## Screw connection

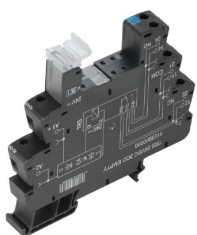

TERMSERIES empty sockets with:

- 1 CO contact
- Unique multi-voltage input from 24 to 230 V UC
- Input voltages from 5 V DC to 230 V UC with coloured marking: AC: red, DC: blue, UC: white
- Due to high-quality design and no sharp edges no risk of injuries during installation
- Partition plates for optical separation and reinforcement of insulation

**SSR 10-32VDC/0-35VDC 5A****Weidmüller Interface GmbH & Co. KG**

Klingenbergstraße 26

D-32758 Detmold

Germany

[www.weidmueller.com](http://www.weidmueller.com)**Counterpart****General ordering data**

Type	TOS 24-230VUC EMPTY ED2	Version
Order No.	<a href="#">2662950000</a>	TERMSERIES, Relay socket, Rated control voltage: 24...230 V UC ±10
GTIN (EAN)	4050118698121	% , Rated switching voltage: 250 V AC, Continuous current: 16 A,
Qty.	10 ST	Screw connection