

## SAIL-M8BGRJ45-4S5.0UIE

**Weidmüller Interface GmbH & Co. KG**  
Klingenbergstraße 26  
D-32758 Detmold  
Germany

[www.weidmueller.com](http://www.weidmueller.com)



The most reliable way of achieving connections between two I/O slaves or between the control and one I/O subscriber is by way of pre-assembled cables. The line of cables covers PROFIBUS, CANopen, DeviceNet™, EtherCAT and Ethernet.

### General ordering data

Version	Bus line, Connecting line, M8, Number of poles: 4, 5 m, Female socket, straight, Shielded: Yes, LED: No, Sheath material: PUR, Halogen: No
Order No.	<a href="#">1304030500</a>
Type	SAIL-M8BGRJ45-4S5.0UIE
GTIN (EAN)	4099986621114
Qty.	1 items

## SAIL-M8BGRJ45-4S5.0UIE

Weidmüller Interface GmbH & Co. KG

Klingenbergstraße 26  
D-32758 Detmold  
Germany

www.weidmueller.com

## Technical data

### Approvals

ROHS Conform

### Dimensions and weights

Net weight 160 g

### Environmental Product Compliance

RoHS Compliance Status Compliant with exemption  
RoHS Exemption (if applicable/known) 6c  
REACH SVHC Lead 7439-92-1  
SCIP e8d8af70-4c85-4483-bc8c-9bc5b598e2a9

### Technical specifications for cable

Cable length	5 m	Sheathing colour	green
Suitable for cable carriers	Yes	Core cross-section	0.15 mm <sup>2</sup>
Shielded	Yes	Halogen	No
Insulation	PP	Acceleration	5 m/s <sup>2</sup>
Bending radius, min., moving	7.5 x cable diameter	Bending radius, min., stationary	4 x cable diameter
Bending cycles	5 Mio	Speed	180 m/s
Sheath material	PUR	Configurable cable length	No
Outer cladding in accordance with UL AWM style	20963 (80 °C / 30 V)	Hybrid cable	No
Irradiation crosslinked	No	Welding spark resistance	No
Colour coding	blue, orange, white / blue, white / orange	Temperature range, stationary	-40...80 °C
Resistant to welding beads	No	Number of poles	4
Outside diameter	4.8 mm ± 0.3 mm		

### General technical data

Connection thread	M8	Contact surface	Gold-plated
LED	No	Version	Female socket, straight
Housing main material	PUR	Nominal current	4 A
Protection degree	IP67	Pollution severity	3
jumpered	No	Threaded ring material	Brass, nickel-plated
Temperature range of housing	-25...+80 °C	Tightening torque	M8: 0.6 Nm

### Plug, left

Plug left RJ45, IP20, male contact, straight, Plastic, shielded

### Plug, right

Plug right M8, IP67, female contact, straight, Plastic, shielded

### Classifications

ETIM 8.0	EC002599	ETIM 9.0	EC002599
ETIM 10.0	EC002599	ECLASS 14.0	27-06-03-08
ECLASS 15.0	27-06-03-08		

Drawings

Dimensioned drawing

Dimensioned drawing

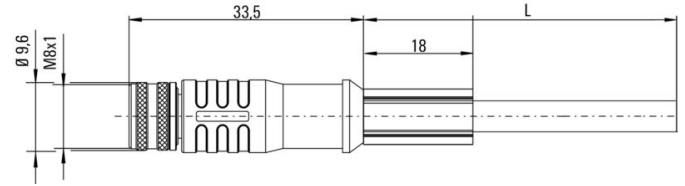

Male, straight

Straight socket

Pole scheme

Pole scheme

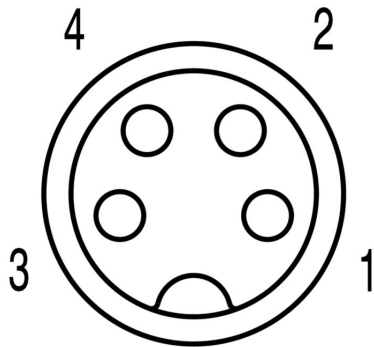

Female contact



RJ45

# Drawings

## Wiring diagram

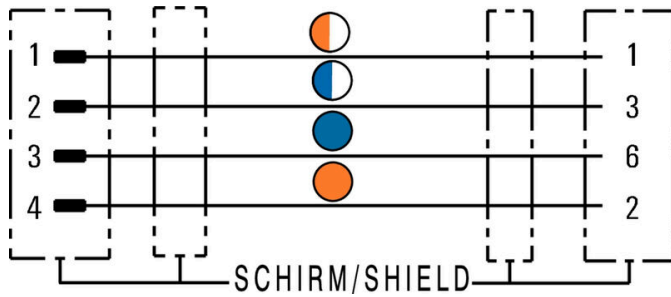

## The ideal tool: Screwty® with torque function



Light, securely screwed-in round plug-in connectors. Screwty set DM / VPE: 1 / Order No.: 1920000000 Adapters: M12, M12 F, M8, M8 F