

SAIL-M8BGRJ45-4S0.25UIE

Weidmüller Interface GmbH & Co. KG
 Klingenbergstraße 26
 D-32758 Detmold
 Germany

www.weidmueller.com



The most reliable way of achieving connections between two I/O slaves or between the control and one I/O subscriber is by way of pre-assembled cables. The line of cables covers PROFIBUS, CANopen, DeviceNet™, EtherCAT and Ethernet.

General ordering data

Version	Bus line, Connecting line, Number of poles: 4, 0.25 m, Female socket, straight, RJ45, Shielded: Yes, LED: No, Sheath material: PUR, Halogen: No
Order No.	1304030025
Type	SAIL-M8BGRJ45-4S0.25UIE
GTIN (EAN)	4050118111262
Qty.	1 items

SAIL-M8BGRJ45-4S0.25UIE

Weidmüller Interface GmbH & Co. KG
 Klingenbergstraße 26
 D-32758 Detmold
 Germany

www.weidmueller.com

Technical data

Approvals

Approvals



ROHS Conform

Dimensions and weights

Net weight 16.72 g

Environmental Product Compliance

RoHS Compliance Status	Compliant with exemption
RoHS Exemption (if applicable/known)	6c
REACH SVHC	Lead 7439-92-1
SCIP	e8d8af70-4c85-4483-bc8c-9bc5b598e2a9

Technical specifications for cable

Cable length	0.25 m	Sheathing colour	green
Suitable for cable carriers	Yes	Core cross-section	0.15 mm ²
Shielded	Yes	Halogen	No
Insulation	PP	Acceleration	5 m/s ²
Bending radius, min., moving	7.5 x cable diameter	Bending radius, min., stationary	4 x cable diameter
Bending cycles	5 Mio	Speed	180 m/s
Sheath material	PUR	Configurable cable length	No
Outer cladding in accordance with UL AWM style	20963 (80 °C / 30 V)	Hybrid cable	No
Irradiation crosslinked	No	Welding spark resistance	No
Colour coding	blue, orange, white / blue, white / orange	Temperature range, stationary	-40...80 °C
Resistant to welding beads	No	Number of poles	4
Outside diameter	4.8 mm ± 0.3 mm		

General technical data

Coding	none	Contact surface	Gold-plated
LED	No	Version	Female socket, straight, RJ45
Housing main material	PUR	Nominal voltage	30 V
Nominal current	4 A	Protection degree	IP67
Plugging cycles	≥ 100	Pollution severity	3
jumpered	No	Threaded ring material	Brass, nickel-plated
Temperature range of housing	-25...+80 °C	Tightening torque	M8: 0.6 Nm

Electrical properties

Nominal voltage 30 V

Plug, left

Plug left RJ45, IP20, male contact, straight, Plastic, shielded

SAIL-M8BGRJ45-4S0.25UIE

Weidmüller Interface GmbH & Co. KG
Klingenbergstraße 26
D-32758 Detmold
Germany

www.weidmueller.com

Technical data

Plug, right

Plug right M8, IP67, female contact, straight, Plastic, shielded

Classifications

ETIM 8.0	EC002599	ETIM 9.0	EC002599
ETIM 10.0	EC002599	ECLASS 14.0	27-06-03-08
ECLASS 15.0	27-06-03-08		

Dimensioned drawing

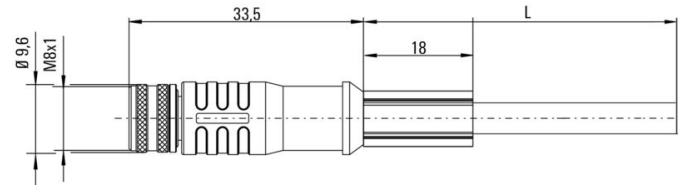

Male, straight

Straight socket

Pole scheme

Pole scheme

Female contact

RJ45

SAIL-M8BGRJ45-4S0.25UIE

Weidmüller Interface GmbH & Co. KG
Klingenbergstraße 26
D-32758 Detmold
Germany

www.weidmueller.com

Drawings

Wiring diagram

The ideal tool: Screwty® with torque function

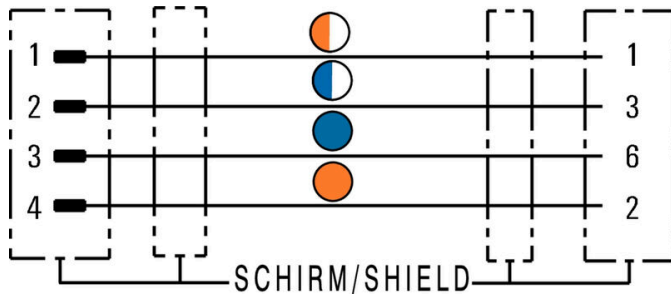

Light, securely screwed-in round plug-in connectors. Screwty set DM / VPE: 1 / Order No.: 1920000000 Adapters: M12, M12 F, M8, M8 F