

PAP PRV/PPV8 BL

Weidmüller Interface GmbH & Co. KG
Klingenbergstraße 26
D-32758 Detmold
Germany

www.weidmueller.com

Product image

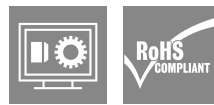
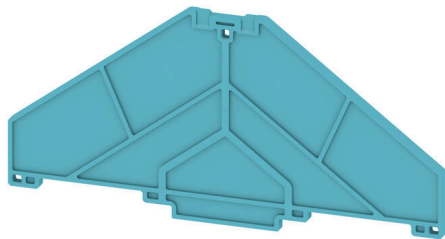

The comprehensive accessories of the Klippon® Connect portfolio are perfectly matched down to the last detail. This facilitates mounting while adhering to required norms

General ordering data

Version	P-series, End plate, blue, 3 mm
Order No.	1268000000
Type	PAP PRV/PPV8 BL
GTIN (EAN)	4032248113040
Qty.	10 items

PAP PRV/PPV8 BL

Weidmüller Interface GmbH & Co. KG
 Klingenbergstraße 26
 D-32758 Detmold
 Germany

www.weidmueller.com

Technical data

Approvals

ROHS	Conform
------	---------

Dimensions and weights

Depth	58.5 mm	Depth (inches)	2.3031 inch
Height	120 mm	Height (inches)	4.7244 inch
Width	3 mm	Width (inches)	0.1181 inch
Net weight	8.89 g		

Temperatures

Storage temperature	-25 °C...55 °C	Ambient temperature	-5 °C...40 °C
Continuous operating temp., min.	-50 °C	Continuous operating temp., max.	125 °C

Environmental Product Compliance

RoHS Compliance Status	Compliant without exemption
REACH SVHC	No SVHC above 0.1 wt%

Material data

Basic material	Polycarbonate	Colour	blue
UL 94 flammability rating	V-0		

System specifications

Version	End plate
---------	-----------

Additional technical data

Snap-on	Yes	Installation advice	Direct mounting
Type of mounting	Direct mounting		

General

Installation advice	Direct mounting
---------------------	-----------------

Classifications

ETIM 8.0	EC000886	ETIM 9.0	EC000886
ETIM 10.0	EC000886	ECLASS 14.0	27-25-03-01
ECLASS 15.0	27-25-03-01		