

ERTE LC CTX CM 1.6/2.5

Weidmüller Interface GmbH & Co. KG
Klingenbergstraße 26
D-32758 Detmold
Germany

www.weidmueller.com

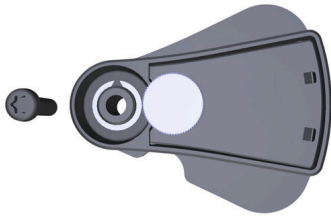

Crimping tools for turned contacts

- Ratchet guarantees precise crimping
- Release option in the event of incorrect operation
- With stop for exact positioning of the contacts.

General ordering data

Order No.	1246770000
Type	ERTE LC CTX CM 1.6/2.5
GTIN (EAN)	4050118034974
Qty.	1 items

ERTE LC CTX CM 1.6/2.5

Weidmüller Interface GmbH & Co. KG
 Klingenbergstraße 26
 D-32758 Detmold
 Germany

www.weidmueller.com

Technical data

Dimensions and weights

Net weight	39.5 g
------------	--------

Environmental Product Compliance

RoHS Compliance Status	Not affected
REACH SVHC	Lead 7439-92-1
SCIP	6a3438d7-aa8c-48e4-8879-adf736ca79e3

Technical data

Version	Replacement part for crimping tool CTX CM 1.6/2.5, locator
---------	--

Classifications

ETIM 8.0	EC002691	ETIM 9.0	EC002691
ETIM 10.0	EC002691	ECLASS 14.0	21-04-51-92
ECLASS 15.0	21-04-51-92		