

## HDC 32B ALU

Weidmüller Interface GmbH &amp; Co. KG

Klingenbergstraße 26

D-32758 Detmold

Germany

www.weidmueller.com



The special die-cast alloy and the multi-layered surface sealing provide complete protection for the HDC housings.

The cleverly designed interlock system is manufactured from stainless steel. This guarantees a long lifespan with high resistance to corrosion and impact.

The housing interlock system provides integrated safety. Our unique, patented spring system provides the housing interlock with a secure grip and prevents accidental opening.

The laser marking allows for easy and quick identification. Each housing is permanently labelled with a laser marking so that each product can be quickly designated and positioned.

Weidmüller RockStar® IP 65 / NEMA Type 4X housings - your first choice for industrial housings with IP 65 protection.

#### General ordering data

Version	HDC enclosures, Installation size: 10, Protection degree: IP65, in plugged condition, Bulkhead housing, End-locking clamp, lower side, Standard
Order No.	<a href="#">1219500000</a>
Type	HDC 32B ALU
GTIN (EAN)	4008190011826
Qty.	1 items

Technical data

Approvals

Approvals



ROHS	Conform
UL File Number Search	<a href="#">UL Website</a>
Certificate No. (cURus)	E92202

Dimensions and weights

Depth	126.6 mm	Depth (inches)	4.9842 inch
Height	38 mm	Height (inches)	1.4961 inch
Width	120 mm	Width (inches)	4.7244 inch
Mounting dimension - height	65 mm	Mounting dimension - width	110 mm
Net weight	251 g		

Temperatures

Limit temperature	-40 °C ... 125 °C
-------------------	-------------------

Environmental Product Compliance

RoHS Compliance Status	Compliant without exemption
REACH SVHC	Potassium perfluorobutane sulfonate 29420-49-3
SCIP	e98b2b24-ba23-41bf-8d19-0dda3647412f

Chemical resistance	Substance	Acetone
	Chemical resistance	Conditionally resistant
	Substance	Drilling oil
	Chemical resistance	Resistant
	Substance	Diesel
	Chemical resistance	Resistant
	Substance	Ethyl alcohol
	Chemical resistance	Resistant
	Substance	Transmission oil
	Chemical resistance	Resistant
	Substance	Hydraulic oil
	Chemical resistance	Resistant
	Substance	Coolant
	Chemical resistance	Resistant
	Substance	Petroleum benzine
	Chemical resistance	Resistant
	Substance	Sweat
	Chemical resistance	Resistant
	Substance	Premium gasoline
	Chemical resistance	Conditionally resistant
Substance	Water	
Chemical resistance	Resistant	
Substance	UV	
Chemical resistance	Unstable	
Substance	Ozone	
Chemical resistance	Unstable	

**HDC 32B ALU**

**Weidmüller Interface GmbH & Co. KG**  
 Klingenbergstraße 26  
 D-32758 Detmold  
 Germany

www.weidmueller.com

**Technical data**

**Dimensions**

Hole pitch length A2	110 mm	Cable entry	No
Width housing C	82.5 mm	Width base C1	89 mm
Total length housing	94 mm	Height of housing B	38 mm
Height of base B1	7 mm		

**General data**

Tightening torque	2 Nm	Housing main material	diecast aluminium
Surface finish	Powder coating	Protection degree	IP65, in plugged condition
EMC housings	No	Material of locking element	Stainless steel, rust-proof

**Version**

Number of cable glands	0	Top part/bottom part/lid	lower part
Cover	without cover	Tightening torque	2 Nm
Number of cable entry sideways	0	Design of housing	Bulkhead housing
Design of locking system	End-locking clamp, lower side	Design	Standard
Installation size	10	Cable entry	No
Type	Bulkhead (feed-through)	Clamp version	End-locking clamp
Sealing	NBR	Colour (RAL)	RAL 7035
BG	10	Suitable for ModuPlug®	Yes

**Important note**

Product information	When mounting the housings, make sure that the flat gasket is correctly seated.
---------------------	---

**Classifications**

ETIM 8.0	EC000437	ETIM 9.0	EC000437
ETIM 10.0	EC000437	ECLASS 14.0	27-44-02-02
ECLASS 15.0	27-44-02-02		

**Drawings**

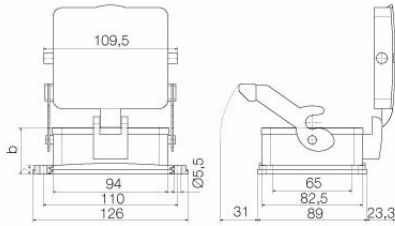

## HDC 32B ALU

Weidmüller Interface GmbH &amp; Co. KG

Klingenbergstraße 26

D-32758 Detmold

Germany

www.weidmueller.com

## Accessories

## Housing, cable entry at top



The special die-cast alloy and the multi-layered surface sealing provide complete protection for the HDC housings.

The cleverly designed interlock system is manufactured from stainless steel. This guarantees a long lifespan with high resistance to corrosion and impact.

The housing interlock system provides integrated safety. Our unique, patented spring system provides the housing interlock with a secure grip and prevents accidental opening.

The laser marking allows for easy and quick identification. Each housing is permanently labelled with a laser marking so that each product can be quickly designated and positioned.

Weidmüller RockStar® IP 65 / NEMA Type 4X housings - your first choice for industrial housings with IP 65 protection.

## General ordering data

Type	HDC 32B TOLU 1M32G	Version
Order No.	<a href="#">1788450000</a>	HDC enclosures, Installation size: 10, Protection degree: IP65, in
GTIN (EAN)	4032248205981	plugged condition, Cable entry from top, Plug housing, End-locking
Qty.	1 ST	clamp, lower side, Standard, Size of cable entries: M 32
Type	HDC 32B TOLU 1PG29G	Version
Order No.	<a href="#">1219300000</a>	HDC enclosures, Installation size: 10, Protection degree: IP65, in
GTIN (EAN)	4008190164652	plugged condition, Cable entry from top, Plug housing, End-locking
Qty.	1 ST	clamp, lower side, Standard, Size of cable entries: PG 29

## Housing, cable entry sideways



The special die-cast alloy and the multi-layered surface sealing provide complete protection for the HDC housings.

The cleverly designed interlock system is manufactured from stainless steel. This guarantees a long lifespan with high resistance to corrosion and impact.

The housing interlock system provides integrated safety. Our unique, patented spring system provides the housing interlock with a secure grip and prevents accidental opening.

The laser marking allows for easy and quick identification. Each housing is permanently labelled with a laser marking so that each product can be quickly designated and positioned.

Weidmüller RockStar® IP 65 / NEMA Type 4X housings - your first choice for industrial housings with IP 65 protection.

## General ordering data

Type	HDC 32B TSLU 1M32G	Version
Order No.	<a href="#">1788420000</a>	HDC enclosures, Installation size: 10, Protection degree: IP65, in
GTIN (EAN)	4032248205950	plugged condition, Cable entry from side, Plug housing, End-locking
Qty.	1 ST	clamp, lower side, Standard, Size of cable entries: M 32

## HDC 32B ALU

## Accessories

Type	HDC 32B TSLU 1PG29G	Version
Order No.	<a href="#">1667120000</a>	HDC enclosures, Installation size: 10, Protection degree: IP65, in
GTIN (EAN)	4008190424329	plugged condition, Cable entry from side, Plug housing, End-locking
Qty.	1 ST	clamp, lower side, Standard, Size of cable entries: PG 29