

## HDC 06B ALU

Weidmüller Interface GmbH &amp; Co. KG

Klingenbergstraße 26

D-32758 Detmold

Germany

www.weidmueller.com



The special die-cast alloy and the multi-layered surface sealing provide complete protection for the HDC housings.

The cleverly designed interlock system is manufactured from stainless steel. This guarantees a long lifespan with high resistance to corrosion and impact.

The housing interlock system provides integrated safety. Our unique, patented spring system provides the housing interlock with a secure grip and prevents accidental opening.

The laser marking allows for easy and quick identification. Each housing is permanently labelled with a laser marking so that each product can be quickly designated and positioned.

Weidmüller RockStar® IP 65 / NEMA Type 4X housings - your first choice for industrial housings with IP 65 protection.

#### General ordering data

Version	HDC enclosures, Installation size: 3, Protection degree: IP65, in plugged condition, Bulkhead housing, End-locking clamp, lower side, Side-locking clamp not replaceable, Standard, Size of cable entries: none
Order No.	<a href="#">1202100000</a>
Type	HDC 06B ALU
GTIN (EAN)	4008190149369
Qty.	1 items

**HDC 06B ALU**

**Weidmüller Interface GmbH & Co. KG**  
 Klingenbergstraße 26  
 D-32758 Detmold  
 Germany

www.weidmueller.com

**Technical data**

**Approvals**

Approvals



ROHS	Conform
UL File Number Search	<a href="#">UL Website</a>
Certificate No. (cURus)	E92202

**Dimensions and weights**

Height	29 mm	Height (inches)	1.1417 inch
Width	68 mm	Width (inches)	2.6772 inch
Mounting dimension - height	32 mm	Mounting dimension - width	70 mm
Net weight	96.8 g		

**Temperatures**

Limit temperature	-40 °C ... 125 °C
-------------------	-------------------

**Environmental Product Compliance**

RoHS Compliance Status	Compliant without exemption
REACH SVHC	Potassium perfluorobutane sulfonate 29420-49-3
SCIP	e98b2b24-ba23-41bf-8d19-0dda3647412f

Chemical resistance	Substance	Acetone
	Chemical resistance	Conditionally resistant
	Substance	Drilling oil
	Chemical resistance	Resistant
	Substance	Diesel
	Chemical resistance	Resistant
	Substance	Ethyl alcohol
	Chemical resistance	Resistant
	Substance	Transmission oil
	Chemical resistance	Resistant
	Substance	Hydraulic oil
	Chemical resistance	Resistant
	Substance	Coolant
	Chemical resistance	Resistant
	Substance	Petroleum benzene
	Chemical resistance	Resistant
	Substance	Sweat
	Chemical resistance	Resistant
	Substance	Premium gasoline
	Chemical resistance	Conditionally resistant
Substance	Water	
Chemical resistance	Resistant	
Substance	UV	
Chemical resistance	Unstable	
Substance	Ozone	
Chemical resistance	Unstable	

**Dimensions**

Hole pitch length A2	70 mm	Cable entry	No
Width housing C	43 mm	Width base C1	47 mm

### Technical data

Total length housing	60 mm	Height of housing B	29 mm
Height of base B1	5.5 mm		

#### General data

Tightening torque	1.2 Nm	Housing main material	diecast aluminium
Surface finish	Powder coating	Protection degree	IP65, in plugged condition
EMC housings	No	Material of locking element	Stainless steel, rust-proof

#### Version

Number of cable glands	0	Size of cable entries	none
Top part/bottom part/lid	lower part	Cover	without cover
Tightening torque	1.2 Nm	Number of cable entry sideways	0
Design of housing	Bulkhead housing	Design of locking system	End-locking clamp, lower side, Side-locking clamp not replaceable
Design	Standard	Installation size	3
Cable entry	No	Type	Bulkhead (feed-through)
Clamp version	End-locking clamp	Sealing	NBR
Colour (RAL)	RAL 7035	BG	3
Suitable for ModuPlug®	Yes		

#### Important note

Product information      When mounting the housings, make sure that the flat gasket is correctly seated.

#### Classifications

ETIM 8.0	EC000437	ETIM 9.0	EC000437
ETIM 10.0	EC000437	ECLASS 14.0	27-44-02-02
ECLASS 15.0	27-44-02-02		

Drawings

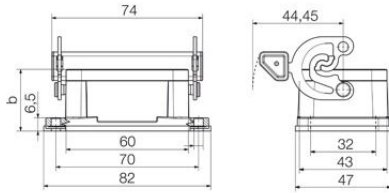

## Accessories

### Cover



The special die-cast alloy and the multi-layered surface sealing provide complete protection for the HDC housings.

The cleverly designed interlock system is manufactured from stainless steel. This guarantees a long lifespan with high resistance to corrosion and impact.

The housing interlock system provides integrated safety. Our unique, patented spring system provides the housing interlock with a secure grip and prevents accidental opening.

The laser marking allows for easy and quick identification. Each housing is permanently labelled with a laser marking so that each product can be quickly designated and positioned.

Weidmüller RockStar® IP 65 / NEMA Type 4X housings - your first choice for industrial housings with IP 65 protection.

### General ordering data

Type	HDC 06B DODL 2BO	Version	
Order No.	<a href="#">1665200000</a>		
GTIN (EAN)	4008190421908		
Qty.	1 ST		