

HDC 40D TBU 2M40G CS

Weidmüller Interface GmbH & Co. KG

Klingenbergstraße 26

D-32758 Detmold

Germany

www.weidmueller.com



IP65

The special die-cast alloy and the multi-layered surface sealing provide complete protection for the HDC housings.

The cleverly designed interlock system is manufactured from stainless steel. This guarantees a long lifespan with high resistance to corrosion and impact.

The housing interlock system provides integrated safety. Our unique, patented spring system provides the housing interlock with a secure grip and prevents accidental opening.

The laser marking allows for easy and quick identification. Each housing is permanently labelled with a laser marking so that each product can be quickly designated and positioned.

Weidmüller RockStar® IP 65 / NEMA Type 4X housings - your first choice for industrial housings with IP 65 protection.

General ordering data

| | |
|------------|---|
| Version | HDC enclosures, Installation size: 6, Protection degree: IP65, in plugged condition, Plug housing, Cable entry from top, Cable entry from side, Side-locking clamp on lower side, high, Size of cable entries: M 32 |
| Order No. | 1131350000 |
| Type | HDC 40D TBU 2M40G CS |
| GTIN (EAN) | 4032248912858 |
| Qty. | 1 items |

HDC 40D TBU 2M40G CS

Weidmüller Interface GmbH & Co. KG
 Klingenbergstraße 26
 D-32758 Detmold
 Germany

www.weidmueller.com

Technical data

Approvals

Approvals



ROHS Conform

Dimensions and weights

| | | | |
|------------|---------|-----------------|-------------|
| Height | 76 mm | Height (inches) | 2.9921 inch |
| Width | 43 mm | Width (inches) | 1.6929 inch |
| Length | 93.3 mm | Length (inches) | 3.6732 inch |
| Net weight | 250 g | | |

Temperatures

Limit temperature -40 °C ... 125 °C

Environmental Product Compliance

RoHS Compliance Status Compliant without exemption
 REACH SVHC No SVHC above 0.1 wt%

| | | |
|---------------------|---------------------|-------------------------|
| Chemical resistance | Substance | Acetone |
| | Chemical resistance | Conditionally resistant |
| | Substance | Drilling oil |
| | Chemical resistance | Resistant |
| | Substance | Diesel |
| | Chemical resistance | Resistant |
| | Substance | Ethyl alcohol |
| | Chemical resistance | Resistant |
| | Substance | Transmission oil |
| | Chemical resistance | Resistant |
| | Substance | Hydraulic oil |
| | Chemical resistance | Resistant |
| | Substance | Coolant |
| | Chemical resistance | Resistant |
| | Substance | Petroleum benzine |
| | Chemical resistance | Resistant |
| | Substance | Sweat |
| | Chemical resistance | Resistant |
| | Substance | Premium gasoline |
| | Chemical resistance | Conditionally resistant |
| Substance | Water | |
| Chemical resistance | Resistant | |
| Substance | UV | |
| Chemical resistance | Unstable | |
| Substance | Ozone | |
| Chemical resistance | Unstable | |

Dimensions

| | | | |
|----------------------|-----------|---------------------|-------|
| Cable entry | w. thread | Width housing C | 43 mm |
| Total length housing | 93.3 mm | Height of housing B | 76 mm |

HDC 40D TBU 2M40G CS

Weidmüller Interface GmbH & Co. KG
 Klingenbergstraße 26
 D-32758 Detmold
 Germany

www.weidmueller.com

Technical data

General data

| | | | |
|----------------|----------------|-------------------|----------------------------|
| Surface finish | Powder coating | Protection degree | IP65, in plugged condition |
|----------------|----------------|-------------------|----------------------------|

Version

| | | | |
|------------------------------|---|--------------------------------|----------------------------------|
| Number of cable glands | 0 | Size of cable entries | M 32 |
| Top part/bottom part/lid | upper part | Cover | without cover |
| Number of cable entry on top | 1 | Number of cable entry sideways | 1 |
| Design of housing | Plug housing, Cable entry from top, Cable entry from side | Design of locking system | Side-locking clamp on lower side |
| Design | high | Installation size | 6 |
| Cable entry | w. thread | Type | Plug |
| Clamp version | Side-locking clamp | Sealing | no sealing |
| Internal thread | M 32 | Colour (RAL) | RAL 7035 |
| BG | 6 | Suitable for ModuPlug® | Yes |

Classifications

| | | | |
|-------------|-------------|-------------|-------------|
| ETIM 8.0 | EC000437 | ETIM 9.0 | EC000437 |
| ETIM 10.0 | EC000437 | ECLASS 14.0 | 27-44-02-02 |
| ECLASS 15.0 | 27-44-02-02 | | |

HDC 40D TBU 2M40G CS

Weidmüller Interface GmbH & Co. KG
Klingenbergstraße 26
D-32758 Detmold
Germany

Drawings

www.weidmueller.com

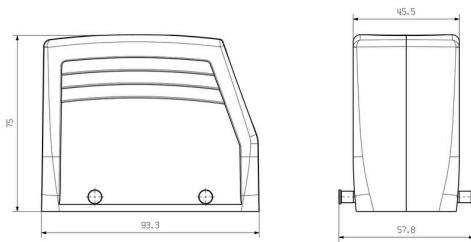

HDC 40D TBU 2M40G CS

Weidmüller Interface GmbH & Co. KG
 Klingenbergstraße 26
 D-32758 Detmold
 Germany

Accessories

www.weidmueller.com

Base housing



The special die-cast alloy and the multi-layered surface sealing provide complete protection for the HDC housings.

The cleverly designed interlock system is manufactured from stainless steel. This guarantees a long lifespan with high resistance to corrosion and impact.

The housing interlock system provides integrated safety. Our unique, patented spring system provides the housing interlock with a secure grip and prevents accidental opening.

The laser marking allows for easy and quick identification. Each housing is permanently labelled with a laser marking so that each product can be quickly designated and positioned.

Weidmüller RockStar® IP 65 / NEMA Type 4X housings - your first choice for industrial housings with IP 65 protection.

General ordering data

| | | |
|------------|----------------------------|--|
| Type | HDC 16B SBU 1M25G | Version |
| Order No. | 1899980000 | HDC enclosures, Installation size: 6, Protection degree: IP65, in |
| GTIN (EAN) | 4032248520718 | plugged condition, Base housing, Side-locking clamp on lower side, |
| Qty. | 1 ST | Standard, Size of cable entries: M 25 |
| Type | HDC 16B SBU 1PG21G | Version |
| Order No. | 1656720000 | HDC enclosures, Installation size: 6, Protection degree: IP65, in |
| GTIN (EAN) | 4008190409739 | plugged condition, Base housing, Side-locking clamp on lower side, |
| Qty. | 1 ST | Standard, Size of cable entries: PG 21 |
| Type | HDC 16B SBU 2M25G | Version |
| Order No. | 1788240000 | HDC enclosures, Installation size: 6, Protection degree: IP65, in |
| GTIN (EAN) | 4032248205776 | plugged condition, Base housing, Side-locking clamp on lower side, |
| Qty. | 1 ST | Standard, Size of cable entries: M 25 |
| Type | HDC 16B SBU 2PG21G | Version |
| Order No. | 1656730000 | HDC enclosures, Installation size: 6, Protection degree: IP65, in |
| GTIN (EAN) | 4008190409746 | plugged condition, Base housing, Side-locking clamp on lower side, |
| Qty. | 1 ST | Standard, Size of cable entries: PG 21 |
| Type | HDC 40D SBU 1M25G | Version |
| Order No. | 1902970000 | HDC enclosures, Installation size: 6, Protection degree: IP65, in |
| GTIN (EAN) | 4032248592951 | plugged condition, Base housing, Side-locking clamp on lower side, |
| Qty. | 1 ST | high, Size of cable entries: M 25 |
| Type | HDC 40D SBU 1M32G | Version |
| Order No. | 1902990000 | HDC enclosures, Installation size: 6, Protection degree: IP65, in |
| GTIN (EAN) | 4032248592968 | plugged condition, Base housing, Side-locking clamp on lower side, |
| Qty. | 1 ST | high, Size of cable entries: M 32 |
| Type | HDC 40D SBU 1PG29G | Version |
| Order No. | 1656830000 | HDC enclosures, Installation size: 6, Protection degree: IP65, in |
| GTIN (EAN) | 4008190409845 | plugged condition, Base housing, Side-locking clamp on lower side, |
| Qty. | 1 ST | high, Size of cable entries: PG 29 |
| Type | HDC 40D SBU 2M25G | Version |
| Order No. | 1787120000 | HDC enclosures, Installation size: 6, Protection degree: IP65, in |
| GTIN (EAN) | 4032248204465 | plugged condition, Base housing, Side-locking clamp on lower side, |
| Qty. | 1 ST | high, Size of cable entries: M 25 |

HDC 40D TBU 2M40G CS

Weidmüller Interface GmbH & Co. KG
 Klingenbergstraße 26
 D-32758 Detmold
 Germany

www.weidmueller.com

Accessories

| | | |
|------------|----------------------------|---|
| Type | HDC 40D SBU 2M32G | Version |
| Order No. | 1787110000 | HDC enclosures, Installation size: 6, Protection degree: IP65, in plugged condition, Base housing, Side-locking clamp on lower side, high, Size of cable entries: M 32 |
| GTIN (EAN) | 4032248204458 | |
| Qty. | 1 ST | |
| Type | HDC 40D SBU 2PG21G | Version |
| Order No. | 1656810000 | HDC enclosures, Installation size: 6, Protection degree: IP65, in plugged condition, Base housing, Side-locking clamp on lower side, high, Size of cable entries: PG 21 |
| GTIN (EAN) | 4008190409821 | |
| Qty. | 1 ST | |
| Type | HDC 40D SBU 2PG29G | Version |
| Order No. | 1656840000 | HDC enclosures, Installation size: 6, Protection degree: IP65, in plugged condition, Base housing, Side-locking clamp on lower side, high, Size of cable entries: PG 29 |
| GTIN (EAN) | 4008190409852 | |
| Qty. | 1 ST | |

Bulkhead housing



The special die-cast alloy and the multi-layered surface sealing provide complete protection for the HDC housings.

The cleverly designed interlock system is manufactured from stainless steel. This guarantees a long lifespan with high resistance to corrosion and impact.

The housing interlock system provides integrated safety. Our unique, patented spring system provides the housing interlock with a secure grip and prevents accidental opening.

The laser marking allows for easy and quick identification. Each housing is permanently labelled with a laser marking so that each product can be quickly designated and positioned.

Weidmüller RockStar® IP 65 / NEMA Type 4X housings - your first choice for industrial housings with IP 65 protection.

General ordering data

| | | |
|------------|----------------------------|--|
| Type | HDC 16B ABU | Version |
| Order No. | 1208600000 | HDC enclosures, Installation size: 6, Protection degree: IP65, in plugged condition, Bulkhead housing, Side-locking clamp on lower side, Side-locking clamp not replaceable, Standard, Size of cable entries: none |
| GTIN (EAN) | 4008190881351 | |
| Qty. | 1 ST | |
| Type | HDC 16B ABU N | Version |
| Order No. | 2488590000 | HDC enclosures, Installation size: 6, Protection degree: IP65, in plugged condition, Bulkhead housing, Side-locking clamp on lower side, Standard, Size of cable entries: none |
| GTIN (EAN) | 4050118541526 | |
| Qty. | 1 ST | |

HDC 40D TBU 2M40G CS

Weidmüller Interface GmbH & Co. KG
 Klingenbergstraße 26
 D-32758 Detmold
 Germany

Accessories

www.weidmueller.com

Coupling hood



The special die-cast alloy and the multi-layered surface sealing provide complete protection for the HDC housings.

The cleverly designed interlock system is manufactured from stainless steel. This guarantees a long lifespan with high resistance to corrosion and impact.

The housing interlock system provides integrated safety. Our unique, patented spring system provides the housing interlock with a secure grip and prevents accidental opening.

The laser marking allows for easy and quick identification. Each housing is permanently labelled with a laser marking so that each product can be quickly designated and positioned.

Weidmüller RockStar® IP 65 / NEMA Type 4X housings - your first choice for industrial housings with IP 65 protection.

General ordering data

| | | |
|------------|----------------------------|---|
| Type | HDC 16B KBU 1PG21G | Version |
| Order No. | 1657270000 | HDC enclosures, Installation size: 6, Protection degree: IP65, in plugged condition, Coupling housing, Side-locking clamp on lower side, Standard, Size of cable entries: PG 21 |
| GTIN (EAN) | 4008190410322 | |
| Qty. | 1 ST | |
| Type | HDC 40D KBU 1M25G | Version |
| Order No. | 1787200000 | HDC enclosures, Installation size: 6, Protection degree: IP65, in plugged condition, Coupling housing, Side-locking clamp on lower side, high, Size of cable entries: M 25 |
| GTIN (EAN) | 4032248204540 | |
| Qty. | 1 ST | |
| Type | HDC 40D KBU 1M32G | Version |
| Order No. | 1787190000 | HDC enclosures, Installation size: 6, Protection degree: IP65, in plugged condition, Coupling housing, Side-locking clamp on lower side, high, Size of cable entries: M 32 |
| GTIN (EAN) | 4032248204533 | |
| Qty. | 1 ST | |
| Type | HDC 40D KBU 1PG21G | Version |
| Order No. | 1657310000 | HDC enclosures, Installation size: 6, Protection degree: IP65, in plugged condition, Coupling housing, Side-locking clamp on lower side, high, Size of cable entries: PG 21 |
| GTIN (EAN) | 4008190410360 | |
| Qty. | 1 ST | |
| Type | HDC 40D KBU 1PG29G | Version |
| Order No. | 1967670000 | HDC enclosures, Installation size: 6, Protection degree: IP65, in plugged condition, Coupling housing, Side-locking clamp on lower side, high, Size of cable entries: PG 29 |
| GTIN (EAN) | 4032248670178 | |
| Qty. | 1 ST | |

HDC 40D TBU 2M40G CS

Weidmüller Interface GmbH & Co. KG
 Klingenbergstraße 26
 D-32758 Detmold
 Germany

Accessories

www.weidmueller.com

Cover



The special die-cast alloy and the multi-layered surface sealing provide complete protection for the HDC housings.

The cleverly designed interlock system is manufactured from stainless steel. This guarantees a long lifespan with high resistance to corrosion and impact.

The housing interlock system provides integrated safety. Our unique, patented spring system provides the housing interlock with a secure grip and prevents accidental opening.

The laser marking allows for easy and quick identification. Each housing is permanently labelled with a laser marking so that each product can be quickly designated and positioned.

Weidmüller RockStar® IP 65 / NEMA Type 4X housings - your first choice for industrial housings with IP 65 protection.

General ordering data

| | | | |
|------------|----------------------------|---------|---|
| Type | HDC 16B DMDQ 2QB | Version | |
| Order No. | 1665270000 | | |
| GTIN (EAN) | 4008190421977 | | |
| Qty. | 1 ST | | |
| | | | HDC enclosures, Installation size: 6, Protection degree: IP65, in plugged condition, Cover for upper part of housing, Side-locking clamp on lower side, Standard, Size of cable entries: none |

IP68 version



In addition to the extensive range of enclosures, Weidmüller offers a variety of cable glands for a wide range of applications.

The cable glands made of brass, plastic and stainless steel meet the most various IP protection classes to suit any industrial enclosure.

Depending on the series of cable glands and the application, the cable glands are approved and tested according to VDE, UL, UR, cULus, DNV GL or EN 45545.

General ordering data

| | | | |
|------------|----------------------------|---------|--|
| Type | VG M40 - MS 68 | Version | |
| Order No. | 1772250000 | | |
| GTIN (EAN) | 4032248129904 | | |
| Qty. | 10 ST | | |
| | | | VG MS (standard brass cable gland), Cable glands, straight, M 40, 9 mm, OD min. 18 - OD max. 25 mm, IP54, IP66, IP67, IP68 - 5 bar (30 min.), Brass, nickel-plated |
| Type | VG M40-1/K68 | Version | |
| Order No. | 1909890000 | | |
| GTIN (EAN) | 4032248536818 | | |
| Qty. | 10 ST | | |
| | | | VG K (standard plastic cable gland), Cable glands, straight, M 40, 10 mm, OD min. 19 - OD max. 28 mm, IP54, IP66, IP67, IP68 - 5 bar (30 min.), Polyamide 6 |