

HDC 24B HP550 MPL2 TYP2

Weidmüller Interface GmbH & Co. KG
Klingenbergstraße 26
D-32758 Detmold
Germany

www.weidmueller.com

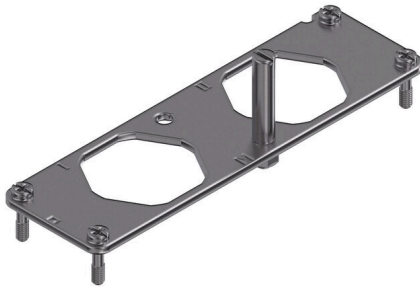

Weidmüller's HighPower accessories complement the RockStar® HighPower connectors and enhance their safety, stability, and ease of use. Robust covers, precise coding elements, and high quality fastening components ensure reliable high current connections—ideal for energy, rail, and industrial applications.

General ordering data

Version	HDC insert, Number of poles: 2, Installation size: 8
Order No.	1103770000
Type	HDC 24B HP550 MPL2 TYP2
GTIN (EAN)	4032248877973
Qty.	1 items

HDC 24B HP550 MPL2 TYP2

Weidmüller Interface GmbH & Co. KG
 Klingenbergstraße 26
 D-32758 Detmold
 Germany

www.weidmueller.com

Technical data

Approvals

Approvals



ROHS Conform

Dimensions and weights

Height	46 mm	Height (inches)	1.811 inch
Width	42 mm	Width (inches)	1.6535 inch
Length	140 mm	Length (inches)	5.5118 inch
Mounting dimension - height	130 mm	Mounting dimension - width	32 mm
Net weight	90.5 g		

Environmental Product Compliance

RoHS Compliance Status Compliant without exemption
 REACH SVHC No SVHC above 0.1 wt%

General data

Number of poles	2	Installation size	8
UL 94 flammability rating	None	Colour	Silver grey
Basic material	Stainless steel, rust-proof	Series	HighPower
Free from halogens	false	BG	8

General data

Colour	Silver grey	Basic material	Stainless steel, rust-proof
Series	HighPower		

Important note

Product information Depending on the intended operation, internally generated voltages can superimpose the working voltage and contain corresponding peaks. It is imperative to ensure that these peak voltages do not exceed the rated voltage. For applications outside of this specification, please contact us.

Classifications

ETIM 8.0	EC002943	ETIM 9.0	EC002943
ETIM 10.0	EC002943	ECLASS 14.0	27-44-02-06
ECLASS 15.0	27-44-02-06		

HDC 24B HP550 MPL2 TYP2

Weidmüller Interface GmbH & Co. KG
Klingenbergstraße 26
D-32758 Detmold
Germany

Drawings

www.weidmueller.com

