

HDC 24B XXL MOUNT FRAME

Weidmüller Interface GmbH & Co. KG

Klingenbergstraße 26

D-32758 Detmold

Germany

www.weidmueller.com

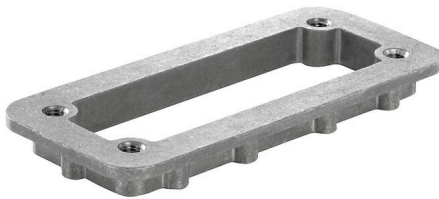

The new RockStar® enclosures are resistant to seawater and offer a high degree of shock resistance, meet IP 68 and IP 69K, and have been developed for use under extreme environmental conditions and designed for the high vibration requirements acc. to DIN EN 61373 cat. 2 (bogie). As such, this housing family is ideally suited for fault- and maintenance-free operation of heavy-duty connectors in transport and traffic engineering as well as in power engineering and in applications with extreme requirements. During development, measures were also implemented to make the enclosures extremely EMC-resistant.

General ordering data

Version	HDC enclosures, Installation size: 8, Protection degree: IP66, IP68, in plugged condition, Counter frame, Clamping yoke connection, Standard, Size of cable entries: none
Order No.	1003470000
Type	HDC 24B XXL MOUNT FRAME
GTIN (EAN)	4032248699810
Qty.	1 items

HDC 24B XXL MOUNT FRAME

Weidmüller Interface GmbH & Co. KG
Klingenbergstraße 26
D-32758 Detmold
Germany

www.weidmueller.com

Technical data

Approvals

Approvals



ROHS Conform

Dimensions and weights

Depth	156 mm	Depth (inches)	6.1417 inch
Height	12 mm	Height (inches)	0.4724 inch
Width	58 mm	Width (inches)	2.2835 inch
Mounting dimension - height	32 mm	Mounting dimension - width	130 mm
Net weight	88 g		

Temperatures

Limit temperature -50 °C ... 125 °C

Environmental Product Compliance

RoHS Compliance Status Compliant without exemption
REACH SVHC No SVHC above 0.1 wt%

Dimensions

Hole pitch length A2	130 mm	Cable entry	No
Total length housing	156 mm	Height of housing B	12 mm

General data

UL 94 flammability rating None Protection degree IP66, IP68, in plugged condition

Version

Number of cable glands	0	Size of cable entries	none
Top part/bottom part/lid	lower part	Cover	without cover
Number of cable entry sideways	0	Design of housing	Counter frame
Design of locking system	Clamping yoke connection	Design	Standard
Installation size	8	Cable entry	No
Type	Bulkhead (feed-through)	Sealing	no sealing
Colour (RAL)	RAL 7001	BG	8
Suitable for ModuPlug®	Yes		

Classifications

ETIM 8.0	EC000437	ETIM 9.0	EC000437
ETIM 10.0	EC000437	ECLASS 14.0	27-44-02-02
ECLASS 15.0	27-44-02-02		