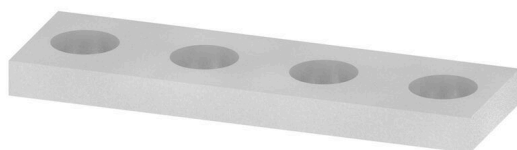

QL 4 SAKD2.5N**Weidmüller Interface GmbH & Co. KG**

Klingenbergstraße 26

D-32758 Detmold

Germany

www.weidmueller.com

In contrast to the terminal blocks with integrated disconnect lever, our disconnect plugs can be completely detached or removed from the terminal block and the respective application and offer a flexible alternative solution to our standard disconnectors.

General ordering data

Version	Cross-connector (terminal), when screwed in, grey, 24 A, Number of poles: 4, Pitch in mm (P): 5.00, Insulated: No, Width: 19.7 mm
Order No.	0216000000
Type	QL 4 SAKD2.5N
GTIN (EAN)	4008190118433
Qty.	50 items
Delivery status	This article will no longer be available in the future.
Available until	2026-06-30T00:00:00+02:00

QL 4 SAKD2.5N

Weidmüller Interface GmbH & Co. KG

Klingenbergstraße 26

D-32758 Detmold

Germany

www.weidmueller.com

Technical data

Approvals

ROHS	Conform
------	---------

Dimensions and weights

Depth	1.5 mm	Depth (inches)	0.0591 inch
Height	6 mm	Height (inches)	0.2362 inch
Width	19.7 mm	Width (inches)	0.7756 inch
Net weight	1.16 g		

Temperatures

Storage temperature	-25 °C...55 °C	Ambient temperature	-5 °C...40 °C
---------------------	----------------	---------------------	---------------

Environmental Product Compliance

RoHS Compliance Status	Compliant with exemption
RoHS Exemption (if applicable/known)	6c
REACH SVHC	Lead 7439-92-1
SCIP	86596b21-b817-43a9-8e4c-ac00e41b9a24

Material data

Basic material	Cu Zn	Colour	grey
----------------	-------	--------	------

System specifications

Version	Cross-connector
---------	-----------------

Additional technical data

Type of fixing	when screwed in	Installation advice	Direct mounting
Explosion-tested version	No	Type of mounting	when screwed in

Dimensions

Pitch in mm (P)	5.00 mm
-----------------	---------

General

Number of poles	4	Installation advice	Direct mounting
-----------------	---	---------------------	-----------------

Rating data

Rated voltage	400 V	Nominal current	24 A
---------------	-------	-----------------	------

Classifications

ETIM 8.0	EC000489	ETIM 9.0	EC000489
ETIM 10.0	EC000489	ECLASS 14.0	27-25-03-03
ECLASS 15.0	27-25-03-03		

Accessories**Mounting support**

We offer a broad portfolio of mounting support for easy handling and supplementation of our products. From various tools to insulating sleeves and various screws, our components are matched to each other down to the last detail and thus facilitate assembly in compliance with the respective standards and protective regulations.

General ordering data

Type	KISC M2.5X4.5 WTR2.5	Version	
Order No.	1062700000	Mounting screw (Terminal), 2.50 mm, Steel, Depth: 3.8 mm, Width:	
GTIN (EAN)	4008190078454	4.5 mm, Height: 4.5 mm	
Qty.	100 ST		