

**QL 2 SAKG40/35****Weidmüller Interface GmbH & Co. KG**

Klingenbergstraße 26

D-32758 Detmold

Germany

www.weidmueller.com

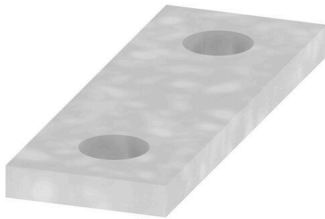

In contrast to the terminal blocks with integrated disconnect lever, our disconnect plugs can be completely detached or removed from the terminal block and the respective application and offer a flexible alternative solution to our standard disconnectors.

**General ordering data**

Version	Cross-connector (terminal), when screwed in, grey, 232 A, Number of poles: 2, Pitch in mm (P): 40.00, Insulated: No, Width: 71 mm
Order No.	<a href="#">0211400000</a>
Type	QL 2 SAKG40/35
GTIN (EAN)	4008190004941
Qty.	5 items
Delivery status	This article will no longer be available in the future.
Last order date	2026-09-29T00:00:00+02:00

## QL 2 SAKG40/35

**Weidmüller Interface GmbH & Co. KG**  
 Klingenbergstraße 26  
 D-32758 Detmold  
 Germany

www.weidmueller.com

## Technical data

### Approvals

ROHS	Conform
------	---------

### Dimensions and weights

Depth	5 mm	Depth (inches)	0.1968 inch
Height	25 mm	Height (inches)	0.9842 inch
Width	71 mm	Width (inches)	2.7953 inch
Net weight	66.2 g		

### Temperatures

Storage temperature	-25 °C...55 °C	Ambient temperature	-5 °C...40 °C
---------------------	----------------	---------------------	---------------

### Environmental Product Compliance

RoHS Compliance Status	Compliant with exemption
RoHS Exemption (if applicable/known)	6c
REACH SVHC	Lead 7439-92-1
SCIP	86596b21-b817-43a9-8e4c-ac00e41b9a24

### Material data

Basic material	CuSn	Colour	grey
----------------	------	--------	------

### System specifications

Version	Cross-connector
---------	-----------------

### Additional technical data

Type of fixing	when screwed in	Installation advice	Direct mounting
Explosion-tested version	No	Type of mounting	when screwed in

### Dimensions

Pitch in mm (P)	40.00 mm
-----------------	----------

### General

Number of poles	2	Installation advice	Direct mounting
-----------------	---	---------------------	-----------------

### Rating data

Rated voltage	400 V	Nominal current	232 A
---------------	-------	-----------------	-------

### Classifications

ETIM 8.0	EC000489	ETIM 9.0	EC000489
ETIM 10.0	EC000489	ECLASS 14.0	27-25-03-03
ECLASS 15.0	27-25-03-03		