

QL 2 SAK35

Weidmüller Interface GmbH & Co. KG

Klingenbergstraße 26

D-32758 Detmold

Germany

www.weidmueller.com

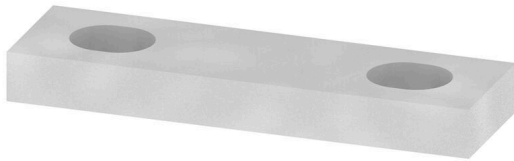

The distribution or multiplication of a potential to adjoining terminal blocks is realized via a cross-connection. Additional wiring effort can be easily avoided. Even if the poles are broken out, contact reliability in the terminal blocks is still ensured. Our portfolio offers pluggable and screwable cross-connection systems for modular terminal blocks.

General ordering data

Version	Cross-connector (terminal), when screwed in, grey, 99 A, Number of poles: 2, Pitch in mm (P): 8.00, Insulated: No, Width: 27.8 mm
Order No.	0123600000
Type	QL 2 SAK35
GTIN (EAN)	4008190092566
Qty.	20 items

QL 2 SAK35

Weidmüller Interface GmbH & Co. KG
 Klingenbergstraße 26
 D-32758 Detmold
 Germany

www.weidmueller.com

Technical data

Approvals

ROHS	Conform
------	---------

Dimensions and weights

Depth	3 mm	Depth (inches)	0.1181 inch
Height	8 mm	Height (inches)	0.315 inch
Width	27.8 mm	Width (inches)	1.0945 inch
Net weight	4.85 g		

Temperatures

Storage temperature	-25 °C...55 °C	Ambient temperature	-5 °C...40 °C
---------------------	----------------	---------------------	---------------

Environmental Product Compliance

RoHS Compliance Status	Compliant without exemption
REACH SVHC	No SVHC above 0.1 wt%

Material data

Basic material	Cu Zn	Colour	grey
----------------	-------	--------	------

System specifications

Version	for cross-connection link
---------	---------------------------

Additional technical data

Type of fixing	when screwed in	Installation advice	Direct mounting
Explosion-tested version	No		

Dimensions

Pitch in mm (P)	8.00 mm
-----------------	---------

General

Number of poles	2	Installation advice	Direct mounting
-----------------	---	---------------------	-----------------

Rating data

Nominal current	99 A
-----------------	------

Classifications

ETIM 8.0	EC000489	ETIM 9.0	EC000489
ETIM 10.0	EC000489	ECLASS 14.0	27-25-03-03
ECLASS 15.0	27-25-03-03		